

| | | | | | | |
|------|------|------|--------|--------------------------------------|---|--|
| SITE | YEAR | AREA | SECTOR | ELEVATION Min: 64.13 Max: 64.4 | STRATIGRAPHICAL UNIT 121 <input type="checkbox"/> Natural <input checked="" type="checkbox"/> Anthropoc |  University of Michigan Biology Museum of Archaeology Gabii Project 22 July 09 |
| GPR | 2009 | A | | | | |

In cross-section? Yes No 1 In elevation drawing? Yes No Photos: Yes No #: 640-644 Photo Model: Yes No #:

DEFINITION
 Layer of very compact fill in the "hut"
 Covered by SU: 82 Fills SU: Filled by SU:

HOW IS LAYER DISTINGUISHED?
 Color Composition Compaction

FORMATION PROCESS
 Accumulation Construction Cutting Erosion Collapse Intentional deposition

INCLUSIONS For each inclusion specify frequency: (f)requent, (m)edium, (r)are

| Anthropic | Geological | Organic | SOIL/MATRIX | | | | |
|---|---|---|--|------------|-------|---|---|
| <input checked="" type="checkbox"/> Pottery R <input checked="" type="checkbox"/> Tiles R <input type="checkbox"/> Amphorae <input type="checkbox"/> Dolia <input type="checkbox"/> Mosaic tile(s) <input type="checkbox"/> Mortar <input type="checkbox"/> Coins <input type="checkbox"/> Metal (specify) <input type="checkbox"/> Collapse debris <input type="checkbox"/> Glass | <input checked="" type="checkbox"/> Tufo (specify) F <input type="checkbox"/> Travertine <input type="checkbox"/> Other Limestone <input type="checkbox"/> Basalt <input type="checkbox"/> Clay <input type="checkbox"/> Sand <input type="checkbox"/> Silt <input type="checkbox"/> Pebbles (range) <input type="checkbox"/> Gravel (range) | <input checked="" type="checkbox"/> Charcoal R <input type="checkbox"/> Ash <input checked="" type="checkbox"/> Animal bones R <input type="checkbox"/> Human bones <input checked="" type="checkbox"/> Animal teeth R <input type="checkbox"/> Human teeth <input type="checkbox"/> Shells <input type="checkbox"/> Other (specify) | clay % silt 60% sand 40% <input checked="" type="checkbox"/> Granular <input type="checkbox"/> Layered <input type="checkbox"/> Cohesive | | | | |
| | | | <table border="1"> <thead> <tr> <th>Compaction</th> <th>Color</th> </tr> </thead> <tbody> <tr> <td> <input type="checkbox"/> Hard <input type="checkbox"/> Compact <input checked="" type="checkbox"/> Friable ? <input type="checkbox"/> Loose <input type="checkbox"/> Soft </td> <td> <input type="checkbox"/> Black <input type="checkbox"/> Brown <input type="checkbox"/> Gray <input checked="" type="checkbox"/> Light Brown <input type="checkbox"/> Light Gray <input type="checkbox"/> White <input type="checkbox"/> Yellow <input type="checkbox"/> Red <input type="checkbox"/> Light Yellow <input type="checkbox"/> Other (specify) </td> </tr> </tbody> </table> | Compaction | Color | <input type="checkbox"/> Hard <input type="checkbox"/> Compact <input checked="" type="checkbox"/> Friable ? <input type="checkbox"/> Loose <input type="checkbox"/> Soft | <input type="checkbox"/> Black <input type="checkbox"/> Brown <input type="checkbox"/> Gray <input checked="" type="checkbox"/> Light Brown <input type="checkbox"/> Light Gray <input type="checkbox"/> White <input type="checkbox"/> Yellow <input type="checkbox"/> Red <input type="checkbox"/> Light Yellow <input type="checkbox"/> Other (specify) |
| Compaction | Color | | | | | | |
| <input type="checkbox"/> Hard <input type="checkbox"/> Compact <input checked="" type="checkbox"/> Friable ? <input type="checkbox"/> Loose <input type="checkbox"/> Soft | <input type="checkbox"/> Black <input type="checkbox"/> Brown <input type="checkbox"/> Gray <input checked="" type="checkbox"/> Light Brown <input type="checkbox"/> Light Gray <input type="checkbox"/> White <input type="checkbox"/> Yellow <input type="checkbox"/> Red <input type="checkbox"/> Light Yellow <input type="checkbox"/> Other (specify) | | | | | | |

UNIT LIMITS (also indicate on overlay)

Northern Limit Original Not Original Excavation Limit
 Southern Limit Original Not Original Excavation Limit
 Western Limit Original Not Original Excavation Limit
 Eastern Limit Original Not Original Excavation Limit

Depth: Original Not Original

STRATIGRAPHICAL SEQUENCE

| | |
|-------------------|---------------------------------|
| Is equal to: | Is bound to (only for masonry): |
| Is abutted by: | Abuts: |
| Is covered by: 82 | Covers: 329 |
| Is cut by: 118, 2 | Cuts: |
| Is filled by: | Fills: 336 |

OBSERVATIONS
 Cut by the "drainage channel to the north and rectangular cut
 SU 128 to the southeast.
 Hand-trowelled

DESCRIPTION
 Position within sector: central area A, the so-called "hut"
 Shape: Irregular, roughly square.

For layers complete this section:

Surface (slope direction; visible inclusions): Fairly level, with dips on the north end near the opening and east end next to the bedrock. Inclusions are pieces of tufo ranging from small to cobble-sized, more visible clusters on the north and east ends and north of cut 118.

Observations about thickness (Increases? Decreases?): Layer is uniformly thick across the area

Nature of the interface with layer below: sharp diffuse commigled other (specify)

For cuts complete this section:

Cut edges: rounded straight
 Cut sides straight concave convex sloping
 Cut bottom: flat concave irregular
 How is cut top edge? sharp rounded
 How is cut bottom edge? sharp rounded
 Observations:

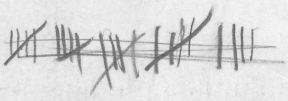
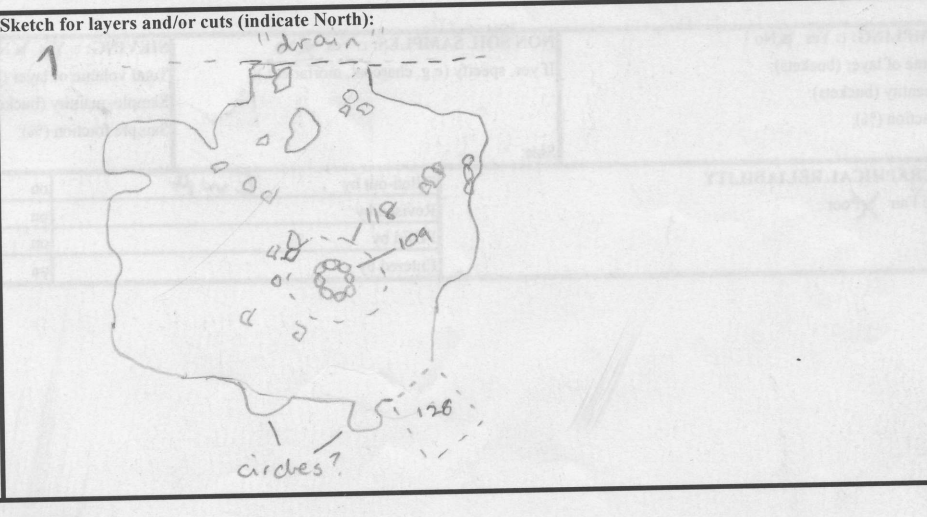

finished

For structural remains complete this section

Alignment:
 Building Technique: Adobe/Mud-brick Ashlar (blocks) Irregular (unworked) stone Concrete Other (specify)

Binding Agent: None Clay Mortar (if so, specify composition, color, compaction)

Concrete inclusions:
 Material Tufo Basalt Travertine Tiles Other (specify)
 Size Small (range) _____ Medium (range) _____ Large (range) _____ Representative size: e.g. 2 x 1 x 2 cmz

Wall Facing:
 Opus quadratum Opus incertum Opus reticulatum Petit appareil Opus testaceum Opus mixtum Opus vittatum Other (specify)

Complete this section for foundations Faced foundation Wooden shuttering No shuttering

floor/revetment type
 Floor type: Beaten Earth Opus signinum Opus scutulatum Opus Sectile Mosaic Opus spicatum Other (specify)
 Wall finishing Stucco Opus signinum Plaster Painted Plaster Other (specify)

Approx. length, width, height of structural remains:

Description:

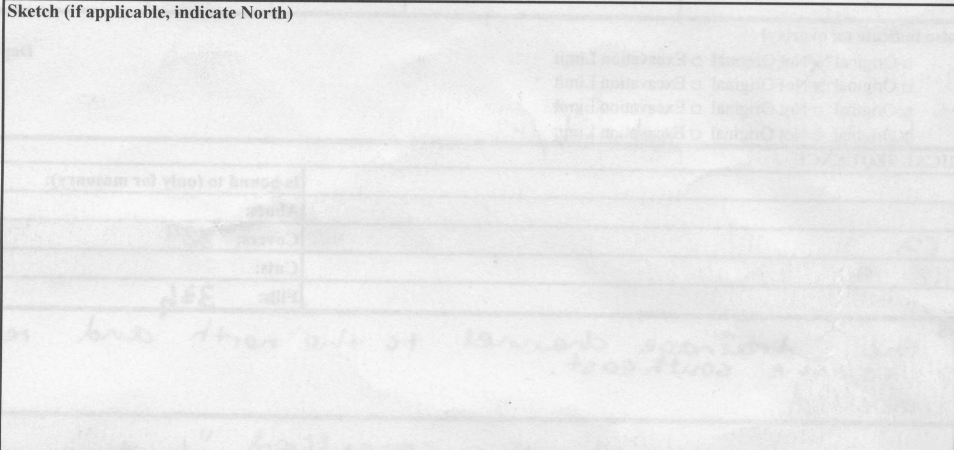

INTERPRETATION

Sediment filling an eroded area of bedrock and an anthropic cut to the north as a result of natural accumulation and decomposition/erosion of the tufo bedrock (particularly on the east side).

| | | |
|--|---|--|
| SOIL SAMPLING: <input type="checkbox"/> Yes <input checked="" type="checkbox"/> No Total volume of layer (buckets): Sample quantity (buckets): Sample fraction (%): | NON SOIL SAMPLES: <input type="checkbox"/> Yes <input checked="" type="checkbox"/> No If yes, specify (e.g. charcoal, mortar etc.): Size: | SIEVING: <input type="checkbox"/> Yes <input checked="" type="checkbox"/> No Total volume of layer (buckets): Sample quantity (buckets): Sample fraction (%): |
|--|---|--|

| | | | | |
|---|---------------|-----|----|------------|
| STRATIGRAPHICAL RELIABILITY <input type="checkbox"/> Good <input type="checkbox"/> Fair <input checked="" type="checkbox"/> Poor | Filled-out by | EWA | on | 23 July 09 |
| | Revised by | | on | |
| | PDFd by | | on | |
| | Entered by | | on | |