

SITE	YEAR	AREA	SECTOR	ELEVATION	STRATIGRAPHICAL UNIT	
GPR	2010	B		Min: 63.1402 Max: 63.4272	1250 <input type="checkbox"/> Natural <input checked="" type="checkbox"/> Anthropic	

In cross-section?  Yes  No      In elevation drawing?  Yes  No      Photos:  Yes  No #: D0189-0197      Photo Model:  Yes  No #:

DEFINITION: *Dividing wall between rooms 1 + 3*

Covered by  SU: 1016      Fills  SU:      Filled by  SU:

HOW IS LAYER DISTINGUISHED?  Color  Composition  Compaction

FORMATION PROCESS:  Accumulation  Construction  Cutting  Erosion  Collapse  Intentional deposition

INCLUSIONS For each inclusion specify frequency: (f)requent, (m)edium, (r)are

Anthropic	Geological	Organic	SOIL/MATRIX
<input type="checkbox"/> Pottery <input type="checkbox"/> Nails <input type="checkbox"/> Tiles <input type="checkbox"/> Marble <input type="checkbox"/> Amphorae <input type="checkbox"/> Quarried debris <input type="checkbox"/> Dolia <input type="checkbox"/> Slag <input type="checkbox"/> Brick <input type="checkbox"/> Mosaic tile(s) <input type="checkbox"/> Basalt slabs <input type="checkbox"/> Mortar <input type="checkbox"/> Opus signinum <input type="checkbox"/> Coins <input type="checkbox"/> Painted plaster <input type="checkbox"/> Metal (specify) <input type="checkbox"/> Burnt Adobe <input type="checkbox"/> Collapse debris <input type="checkbox"/> Other (specify) <input type="checkbox"/> Glass	<input type="checkbox"/> Tufo (specify) <input type="checkbox"/> Travertine <input type="checkbox"/> Other Limestone <input type="checkbox"/> Basalt <input type="checkbox"/> Clay <input type="checkbox"/> Sand <input type="checkbox"/> Silt <input type="checkbox"/> Pebbles (range) <input type="checkbox"/> Gravel (range)	<input type="checkbox"/> Charcoal <input type="checkbox"/> Ash <input type="checkbox"/> Animal bones <input type="checkbox"/> Human bones <input type="checkbox"/> Animal teeth <input type="checkbox"/> Human teeth <input type="checkbox"/> Shells <input type="checkbox"/> Other (specify)	clay ___%    silt ___%    sand ___% <input type="checkbox"/> Granular <input type="checkbox"/> Layered <input type="checkbox"/> Cohesive  <b>Compaction</b> <b>Color</b> <input type="checkbox"/> Hard <input type="checkbox"/> Black <input type="checkbox"/> Brown <input type="checkbox"/> Compact <input type="checkbox"/> Gray <input type="checkbox"/> Light Brown <input type="checkbox"/> Friable <input type="checkbox"/> Light Gray <input type="checkbox"/> White <input type="checkbox"/> Loose <input type="checkbox"/> Yellow <input type="checkbox"/> Red <input type="checkbox"/> Soft <input type="checkbox"/> Light Yellow <input type="checkbox"/> Other (specify)

UNIT LIMITS (also indicate on overlay)

Northern Limit  Original  Not Original  Excavation Limit      Depth:  Original  Not Original

Southern Limit  Original  Not Original  Excavation Limit

Western Limit  Original  Not Original  Excavation Limit

Eastern Limit  Original  Not Original  Excavation Limit

STRATIGRAPHICAL SEQUENCE

Is equal to:	Is bound to (only for masonry):
Is abutted by:	Abuts: 1183, 1185
Is covered by: 1016	Covers: 1205
Is cut by:	Cuts:
Is filled by:	Fills:

OBSERVATIONS

*Pictures D0189-0197 are of Room 1*

DESCRIPTION

Position within sector: *Near center at southern edge of excavation*

Shape: *Linear*

For layers complete this section:

Surface (slope direction; visible inclusions):

Observations about inclusions (Clusters? Deposition slope):

Observations about thickness (Increases? Decreases?):

Nature of the interface with layer below:  sharp  diffuse  commingled  other (specify)

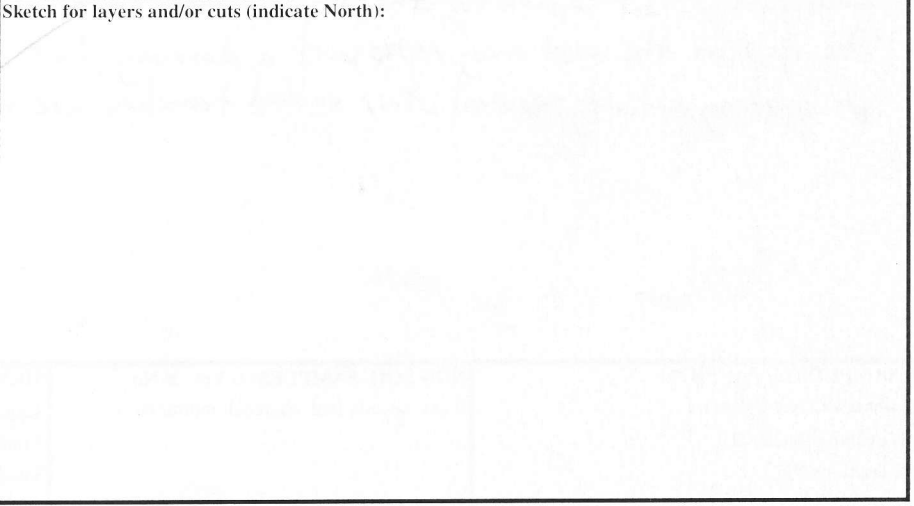
<p>For cuts complete this section:</p> <p>Cut edges: <input type="checkbox"/> rounded <input type="checkbox"/> straight</p> <p>Cut sides <input type="checkbox"/> straight <input type="checkbox"/> concave <input type="checkbox"/> convex <input type="checkbox"/> sloping</p> <p>Cut bottom: <input type="checkbox"/> flat <input type="checkbox"/> concave <input type="checkbox"/> irregular</p> <p>How is cut top edge? <input type="checkbox"/> sharp <input type="checkbox"/> rounded</p> <p>How is cut bottom edge? <input type="checkbox"/> sharp <input type="checkbox"/> rounded</p> <p>Observations:</p>	<p>Sketch for layers and/or cuts (indicate North):</p> 
---	---

D0189-0197

**For structural remains complete this section**

Alignment: **E-W**

Building Technique:  Adobe/Mud-brick  Ashlar (blocks)  irregular (unworked) stone  Concrete  Other (specify)

Binding Agent:  None  Clay  Mortar (if so, specify composition, color, compaction)

Concrete inclusions:

Material  Tufo  Basalt  Travertine  Tiles  Other (specify)  
 Size  Small (range) \_\_\_\_\_  Medium (range) \_\_\_\_\_  Large (range) \_\_\_\_\_ Representative size: e.g. 2 x 1 x 2 cmz

Wall Facing:

Opus quadratum  Opus incertum  Opus reticulatum  Petit appareil  Opus testaceum  Opus mixtum  Opus vittatum  Other (specify)

Complete this section for foundations  Faced foundation  Wooden shuttering  No shuttering

floor/revetment type

Floor type:  Beaten Earth  Opus signinum  Opus scutulatum  Opus Sectile  Mosaic  Opus spicatum  Other (specify)

Wall finishing  Stucco  Opus signinum  Plaster  Painted Plaster  Other (specify)

Approx. length, width, height of structural remains: **4.12 m long, average block size 50cm x 40cm x 27cm**

Description:

Linear partition wall within structure, made of tufo blocks. Single course preserved. Gap present in the west, near where wall approaches wall 1183. Wall sits on soil (SU \_\_\_\_\_).

Sketch (if applicable, indicate North)

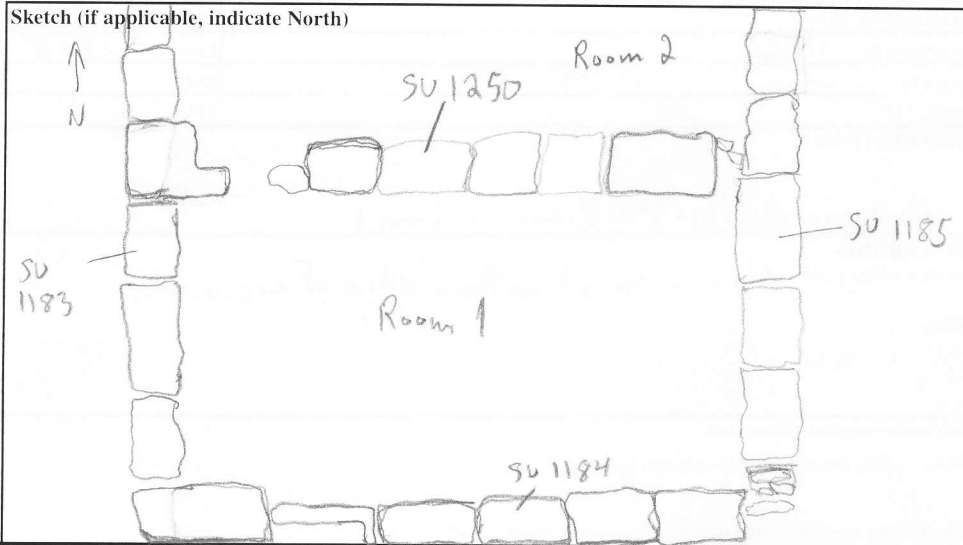

**INTERPRETATION**

SU 1250 is a partition wall built after the exterior walls of the building had been constructed. It separated the larger space into two rooms, room 1 + room 2. The gap in the west may represent a doorway, but could also be the result of robbing activity - several other robbed trenches are nearby.

**SOIL SAMPLING:**  Yes  No

Total volume of layer (buckets):

Sample quantity (buckets):

Sample fraction (%):

**NON SOIL SAMPLES:**  Yes  No

If yes, specify (e.g. charcoal, mortar etc.):

Size:

**SIEVING:**  Yes  No

Total volume of layer (buckets):

Sample quantity (buckets):

Sample fraction (%):

**STRATIGRAPHICAL RELIABILITY**

Good  Fair  Poor

Filled-out by **J. FARR**

on **26.07.2010**

Revised by **CHM**

on **27.07.2010**

PDFd by **JJM**

on **28/7/2010**

Entered by

on