

SITE GPR	YEAR 2010	AREA B	SECTOR	ELEVATION Min: 62.6453 Max: 62.7488	STRATIGRAPHICAL UNIT 1252 <input type="checkbox"/> Natural <input checked="" type="checkbox"/> Anthropic	 Cabu Project
-------------	--------------	-----------	--------	---	--	---

In cross-section? Yes No In elevation drawing? Yes No Photos: Yes No #: 1125-6 Photo Model: Yes No #:

DEFINITION: *Cut for posthole*

Covered by SU: Fills SU: Filled by SU: 1251

HOW IS LAYER DISTINGUISHED? Color Composition Compaction

FORMATION PROCESS Accumulation Construction Cutting Erosion Collapse Intentional deposition

INCLUSIONS For each inclusion specify frequency: (f)requent, (m)edium, (r)are

Anthropic	Geological	Organic	SOIL/MATRIX
<input type="checkbox"/> Pottery <input type="checkbox"/> Nails <input type="checkbox"/> Tiles <input type="checkbox"/> Marble <input type="checkbox"/> Amphorae <input type="checkbox"/> Quarried debris <input type="checkbox"/> Dolia <input type="checkbox"/> Slag <input type="checkbox"/> Brick <input type="checkbox"/> Mosaic tile(s) <input type="checkbox"/> Basalt slabs <input type="checkbox"/> Mortar <input type="checkbox"/> Opus signinum <input type="checkbox"/> Coins <input type="checkbox"/> Painted plaster <input type="checkbox"/> Metal (specify) <input type="checkbox"/> Burnt Adobe <input type="checkbox"/> Collapse debris <input type="checkbox"/> Other (specify) <input type="checkbox"/> Glass	<input type="checkbox"/> Tufo (specify) <input type="checkbox"/> Travertine <input type="checkbox"/> Other Limestone <input type="checkbox"/> Basalt <input type="checkbox"/> Clay <input type="checkbox"/> Sand <input type="checkbox"/> Silt <input type="checkbox"/> Pebbles (range) <input type="checkbox"/> Gravel (range)	<input type="checkbox"/> Charcoal <input type="checkbox"/> Ash <input type="checkbox"/> Animal bones <input type="checkbox"/> Human bones <input type="checkbox"/> Animal teeth <input type="checkbox"/> Human teeth <input type="checkbox"/> Shells <input type="checkbox"/> Other (specify)	clay ___% silt ___% sand ___% <input type="checkbox"/> Granular <input type="checkbox"/> Layered <input type="checkbox"/> Cohesive Compaction Color <input type="checkbox"/> Hard <input type="checkbox"/> Black <input type="checkbox"/> Brown <input type="checkbox"/> Compact <input type="checkbox"/> Gray <input type="checkbox"/> Light Brown <input type="checkbox"/> Friable <input type="checkbox"/> Light Gray <input type="checkbox"/> White <input type="checkbox"/> Loose <input type="checkbox"/> Yellow <input type="checkbox"/> Red <input type="checkbox"/> Soft <input type="checkbox"/> Light Yellow <input type="checkbox"/> Other (specify)

UNIT LIMITS (also indicate on overlay)

Northern Limit Original Not Original Excavation Limit Depth: Original Not Original

Southern Limit Original Not Original Excavation Limit

Western Limit Original Not Original Excavation Limit

Eastern Limit Original Not Original Excavation Limit

STRATIGRAPHICAL SEQUENCE

Is equal to:	Is bound to (only for masonry):
Is abutted by:	Abuts:
Is covered by:	Covers:
Is cut by:	Cuts: 1001 (bedrock)
Is filled by: 1251	Fills:

OBSERVATIONS
Fill excavated with trowel on sunny day. No finds in fill (SU 1251).

DESCRIPTION
 Position within sector: *Along north wall (SU 1250) of Room 1, which is near center of Area B at southern edge of excavation*
 Shape: *circular*

For layers complete this section:

Surface (slope direction; visible inclusions):

Observations about inclusions (Clusters? Deposition slope):

Observations about thickness (Increases? Decreases?):

Nature of the interface with layer below: sharp diffuse commingled other (specify)

For cuts complete this section:

Cut edges: rounded straight

Cut sides: straight concave convex sloping

Cut bottom: flat concave irregular

How is cut top edge? sharp rounded *sharp at W, rounded at E*

How is cut bottom edge? sharp rounded

Observations:
More nicely cut than the other posthole found in Room 1 (1225).

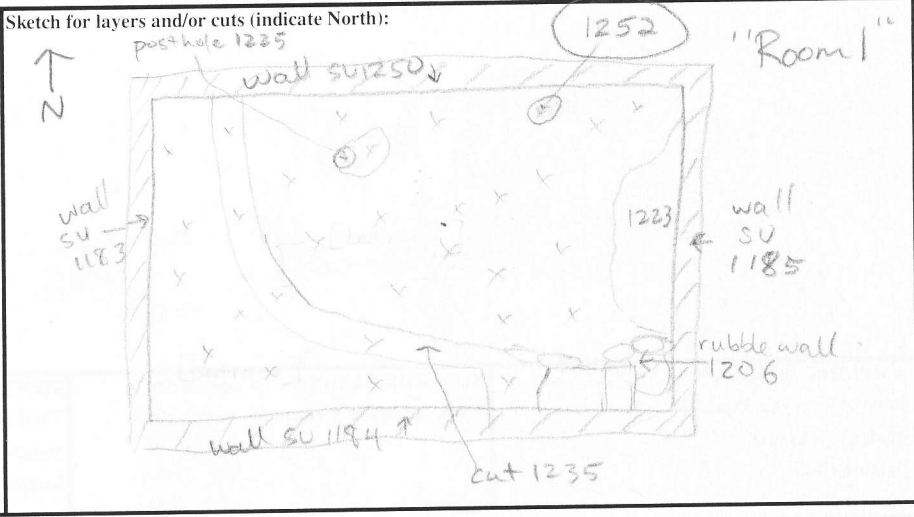

 = wall
 x = bedrock

For structural remains complete this section

Alignment:

Building Technique: Adobe/Mud-brick Ashlar (blocks) irregular (unworked) stone Concrete Other (specify)

Binding Agent: None Clay Mortar (if so, specify composition, color, compaction)

Concrete inclusions:

Material Tufo Basalt Travertine Tiles Other (specify)
 Size Small (range) _____ Medium (range) _____ Large (range) _____ Representative size: e.g. 2 x 1 x 2 cmz

Wall Facing:

Opus quadratum Opus incertum Opus reticulatum Petit appareil Opus testaceum Opus mixtum Opus vittatum Other (specify)

Complete this section for foundations Faced foundation Wooden shuttering No shuttering

floor/revetment type

Floor type: Beaten Earth Opus signinum Opus scutulatum Opus Sectile Mosaic Opus spicatum Other (specify)

Wall finishing Stucco Opus signinum Plaster Painted Plaster Other (specify)

Approx. length, width, height of structural remains:

Description:

Sketch (if applicable, indicate North)

INTERPRETATION

Round cut into the bedrock to be used as a posthole. Possibly associated with nearby posthole 1225, as well as semicircular cut/foundation trench SV 1235.

SOIL SAMPLING: Yes No

Total volume of layer (buckets):

Sample quantity (buckets):

Sample fraction (%):

NON SOIL SAMPLES: Yes No

If yes, specify (e.g. charcoal, mortar etc.):

Size:

SIEVING: Yes No

Total volume of layer (buckets):

Sample quantity (buckets):

Sample fraction (%):

STRATIGRAPHICAL RELIABILITY

Good Fair Poor

Filled-out by S. ROUS / J. FARR

on 26.07.10

Revised by CMH

on 26.07.10

PDFd by JJM

on 7.8.11 / 2010

Entered by

on