

SITE GPR	YEAR 2010	AREA B	SECTOR	ELEVATION Min: 63.0174 Max: 63.1736	STRATIGRAPHICAL UNIT 1255 <input type="checkbox"/> Natural <input checked="" type="checkbox"/> Anthropic	 Gabii Project

In cross-section? Yes No In elevation drawing? Yes No Photos: Yes No #: 1252, 1253 Photo Model: Yes No #:

DEFINITION *Crushed tufa corridor floor II* Covered by SU: 1165 Fills SU: Filled by SU:

HOW IS LAYER DISTINGUISHED? Color Composition Compaction FORMATION PROCESS
 Accumulation Construction Cutting Erosion Collapse Intentional deposition

INCLUSIONS For each inclusion specify frequency: (f)requent, (m)edium, (r)are

Anthropic	Geological	Organic	SOIL/MATRIX	
<input type="checkbox"/> Pottery <input type="checkbox"/> Nails <input type="checkbox"/> Tiles <input type="checkbox"/> Marble <input type="checkbox"/> Amphorae <input type="checkbox"/> Quarried debris <input type="checkbox"/> Dolia <input type="checkbox"/> Slag <input type="checkbox"/> Brick <input type="checkbox"/> Mosaic tile(s) <input type="checkbox"/> Basalt slabs <input type="checkbox"/> Mortar <input type="checkbox"/> Opus signinum <input type="checkbox"/> Coins <input type="checkbox"/> Painted plaster <input type="checkbox"/> Metal (specify) <input type="checkbox"/> Burnt Adobe <input type="checkbox"/> Collapse debris <input type="checkbox"/> Other (specify) <input type="checkbox"/> Glass	<input type="checkbox"/> Tufo (specify) <input type="checkbox"/> Travertine <input type="checkbox"/> Other Limestone <input type="checkbox"/> Basalt <input type="checkbox"/> Clay <input type="checkbox"/> Sand <input type="checkbox"/> Silt <input type="checkbox"/> Pebbles (range) <input type="checkbox"/> Gravel (range)	<input type="checkbox"/> Charcoal <input type="checkbox"/> Ash <input type="checkbox"/> Animal bones <input type="checkbox"/> Human bones <input type="checkbox"/> Animal teeth <input type="checkbox"/> Human teeth <input type="checkbox"/> Shells <input type="checkbox"/> Other (specify)	clay ___% silt ___% sand ___% <input type="checkbox"/> Granular <input type="checkbox"/> Layered <input type="checkbox"/> Cohesive <hr/> Compaction Color <input type="checkbox"/> Hard <input type="checkbox"/> Black <input type="checkbox"/> Brown <input type="checkbox"/> Compact <input type="checkbox"/> Gray <input type="checkbox"/> Light Brown <input type="checkbox"/> Friable <input type="checkbox"/> Light Gray <input type="checkbox"/> White <input type="checkbox"/> Loose <input type="checkbox"/> Yellow <input type="checkbox"/> Red <input type="checkbox"/> Soft <input type="checkbox"/> Light Yellow <input type="checkbox"/> Other (specify)	

UNIT LIMITS (also indicate on overlay)

Northern Limit Original Not Original Excavation Limit Depth: Original Not Original
 Southern Limit Original Not Original Excavation Limit
 Western Limit Original Not Original Excavation Limit
 Eastern Limit Original Not Original Excavation Limit

STRATIGRAPHICAL SEQUENCE

Is equal to: 1215	Is bound to (only for masonry):
Is abutted by:	Abuts: 1183
Is covered by: 1182	Covers:
Is cut by: 1191, 1276	Cuts:
Is filled by:	Fills:

OBSERVATIONS
dry, hot conditions, excavated with trowel

DESCRIPTION
 Position within sector: *central within Area B 2010*
 Shape: *long rectangular*

For layers complete this section:

Surface (slope direction: visible inclusions): *gentle slope to the south*

Observations about inclusions (Clusters? Deposition slope) *—*

Observations about thickness (Increases? Decreases?): *thickness is constant ca. 0.05m*

Nature of the interface with layer below: sharp diffuse commingled other (specify)

<p>For cuts complete this section:</p> <p>Cut edges: <input type="checkbox"/> rounded <input type="checkbox"/> straight</p> <p>Cut sides <input type="checkbox"/> straight <input type="checkbox"/> concave <input type="checkbox"/> convex <input type="checkbox"/> sloping</p> <p>Cut bottom: <input type="checkbox"/> flat <input type="checkbox"/> concave <input type="checkbox"/> irregular</p> <p>How is cut top edge? <input type="checkbox"/> sharp <input type="checkbox"/> rounded</p> <p>How is cut bottom edge? <input type="checkbox"/> sharp <input type="checkbox"/> rounded</p> <p>Observations:</p>	<p>Sketch for layers and/or cuts (indicate North):</p> <p><i>see sketch on SU sheet 1215</i></p>
---	--

For structural remains complete this section

Alignment:

Building Technique: Adobe/Mud-brick Ashlar (blocks) irregular (unworked) stone Concrete Other (specify)

Binding Agent: None Clay Mortar (if so, specify composition, color, compaction)

Concrete inclusions:

Material Tufo Basalt Travertine Tiles Other (specify)
 Size Small (range) _____ Medium (range) _____ Large (range) _____ Representative size: e.g. 2 x 1 x 2 cmz

Wall Facing:

Opus quadratum Opus incertum Opus reticulatum Petit appareil Opus testaceum Opus mixtum Opus vittatum Other (specify)

Complete this section for foundations Faced foundation Wooden shuttering No shuttering

floor/revetment type

Floor type: Beaten Earth Opus signinum Opus scutulatum Opus Sectile Mosaic Opus spicatum Other (specify) *crushed tufo*
 Wall finishing Stucco Opus signinum Plaster Painted Plaster Other (specify)

Approx. length, width, height of structural remains: *length:* _____ *width:* _____ *height:* _____

Description: *Crushed tufo floor corridor between walls 1186 and 1183. The corridor separates Rooms 1 and 2 and is quite narrow. The floor is separated by cut*

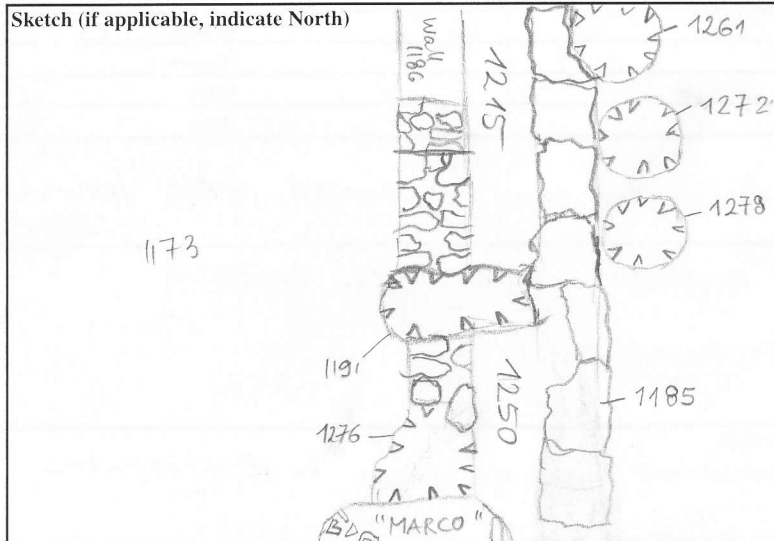

INTERPRETATION

Crushed tufo floor between two walls (1186 + 1185)
 It is relatively clear that this tufo floor is the same as SU but interrupted by the truncation (SU 1191). It is also pretty obvious that the tufo floor abuts wall 1185, e.g. is contemporary with it, but was cut for the construction, or repair, or a phase of reuse of wall 1186

SOIL SAMPLING: Yes No

Total volume of layer (buckets):

Sample quantity (buckets):

Sample fraction (%):

NON SOIL SAMPLES: Yes No

If yes, specify (e.g. charcoal, mortar etc.):

Size:

SIEVING: Yes No

Total volume of layer (buckets):

Sample quantity (buckets):

Sample fraction (%):

STRATIGRAPHICAL RELIABILITY

Good Fair Poor

Filled-out by *MCP* on *28-09-2010*

Revised by *CPM* on *28-07-2010*

PDFd by _____ on _____

Entered by _____ on _____