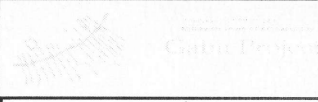

SITE GPR	YEAR 2010	AREA B	SECTOR	ELEVATION Min: 63.0527 Max: 63.1245	STRATIGRAPHICAL UNIT 1257 <input type="checkbox"/> Natural <input checked="" type="checkbox"/> Anthropic		
In cross-section? <input type="checkbox"/> Yes <input checked="" type="checkbox"/> No		In elevation drawing? <input type="checkbox"/> Yes <input checked="" type="checkbox"/> No		Photos: <input checked="" type="checkbox"/> Yes <input type="checkbox"/> No #: 1240-1249	Photo Model: <input type="checkbox"/> Yes <input checked="" type="checkbox"/> No #:		
DEFINITION well in bedrock				Covered by <input checked="" type="checkbox"/> SU: 1188	Fills <input type="checkbox"/> SU:	Filled by <input type="checkbox"/> SU:	
HOW IS LAYER DISTINGUISHED? <input type="checkbox"/> Color <input type="checkbox"/> Composition <input type="checkbox"/> Compaction		FORMATION PROCESS <input type="checkbox"/> Accumulation <input checked="" type="checkbox"/> Construction <input type="checkbox"/> Cutting <input type="checkbox"/> Erosion <input type="checkbox"/> Collapse <input type="checkbox"/> Intentional deposition					
INCLUSIONS For each inclusion specify frequency: (f)requent, (m)edium, (r)are				SOIL/MATRIX			
Anthropic		Geological		Organic	clay ___% silt ___% sand ___%		
<input type="checkbox"/> Pottery <input type="checkbox"/> Tiles <input type="checkbox"/> Amphorae <input type="checkbox"/> Dolia <input type="checkbox"/> Mosaic tiles(s) <input type="checkbox"/> Mortar <input type="checkbox"/> Coins <input type="checkbox"/> Metal (specify) <input type="checkbox"/> Collapse debris <input type="checkbox"/> Glass		<input type="checkbox"/> Nails <input type="checkbox"/> Marble <input type="checkbox"/> Quarried debris <input type="checkbox"/> Slag <input type="checkbox"/> Brick <input type="checkbox"/> Basalt slabs <input type="checkbox"/> Opus signinum <input type="checkbox"/> Painted plaster <input type="checkbox"/> Burnt Adobe <input type="checkbox"/> Other (specify)		<input type="checkbox"/> Tufo (specify) <input type="checkbox"/> Travertine <input type="checkbox"/> Other Limestone <input type="checkbox"/> Basalt <input type="checkbox"/> Clay <input type="checkbox"/> Sand <input type="checkbox"/> Silt <input type="checkbox"/> Pebbles (range) <input type="checkbox"/> Gravel (range)	<input type="checkbox"/> Charcoal <input type="checkbox"/> Ash <input type="checkbox"/> Animal bones <input type="checkbox"/> Human bones <input type="checkbox"/> Animal teeth <input type="checkbox"/> Human teeth <input type="checkbox"/> Shells <input type="checkbox"/> Other (specify)	<input type="checkbox"/> Granular <input type="checkbox"/> Layered <input type="checkbox"/> Cohesive Compaction <input type="checkbox"/> Hard <input type="checkbox"/> Compact <input type="checkbox"/> Friable <input type="checkbox"/> Loose <input type="checkbox"/> Soft	
					<input type="checkbox"/> Black <input type="checkbox"/> Brown <input type="checkbox"/> Gray <input type="checkbox"/> Light Brown <input type="checkbox"/> Light Gray <input type="checkbox"/> White <input type="checkbox"/> Yellow <input type="checkbox"/> Red <input type="checkbox"/> Light Yellow <input type="checkbox"/> Other (specify)		
UNIT LIMITS (also indicate on overlay)							
Northern Limit		<input checked="" type="checkbox"/> Original <input type="checkbox"/> Not Original <input type="checkbox"/> Excavation Limit			Depth: <input type="checkbox"/> Original <input checked="" type="checkbox"/> Not Original		
Southern Limit		<input checked="" type="checkbox"/> Original <input type="checkbox"/> Not Original <input type="checkbox"/> Excavation Limit					
Western Limit		<input checked="" type="checkbox"/> Original <input type="checkbox"/> Not Original <input type="checkbox"/> Excavation Limit					
Eastern Limit		<input checked="" type="checkbox"/> Original <input type="checkbox"/> Not Original <input type="checkbox"/> Excavation Limit					
STRATIGRAPHICAL SEQUENCE							
Is equal to:				Is bound to (only for masonry):			
Is abutted by:				Abuts:			
Is covered by: 1188				Covers:			
Is cut by:				Cuts: 1001			
Is filled by:				Fills:			
OBSERVATIONS hot dry conditions							
DESCRIPTION							
Position within sector: central west in Area B 2010							
Shape: round							
For layers complete this section:							
Surface (slope direction; visible inclusions):							
Observations about inclusions (Clusters? Deposition slope)							
Observations about thickness (Increases? Decreases?):							
Nature of the interface with layer below: <input type="checkbox"/> sharp <input type="checkbox"/> diffuse <input type="checkbox"/> commingled <input type="checkbox"/> other (specify)							
For cuts complete this section:				Sketch for layers and/or cuts (indicate North):			
Cut edges: <input type="checkbox"/> rounded <input type="checkbox"/> straight				See rev.			
Cut sides: <input type="checkbox"/> straight <input type="checkbox"/> concave <input type="checkbox"/> convex <input type="checkbox"/> sloping							
Cut bottom: <input type="checkbox"/> flat <input type="checkbox"/> concave <input type="checkbox"/> irregular							
How is cut top edge? <input type="checkbox"/> sharp <input type="checkbox"/> rounded							
How is cut bottom edge? <input type="checkbox"/> sharp <input type="checkbox"/> rounded							
Observations:							

For structural remains complete this section

Alignment:

Building Technique: Adobe/Mud-brick Ashlar (blocks) Irregular (unworked) stone Concrete Other (specify)

Binding Agent: None Clay Mortar (if so, specify composition, color, compaction)

Concrete inclusions:

Material Tufo Basalt Travertine Tiles Other (specify)
 Size Small (range) _____ Medium (range) _____ Large (range) _____ Representative size: e.g. 2 x 1 x 2 cmz

Wall Facing:

Opus quadratum Opus incertum Opus reticulatum Petit appareil Opus testaceum Opus mixtum Opus vittatum Other (specify)

Complete this section for foundations Faced foundation Wooden shuttering No shuttering

floor/revetment type

Floor type: Beaten Earth Opus signinum Opus scutulatum Opus Sectile Mosaic Opus spicatum Other (specify)

Wall finishing Stucco Opus signinum Plaster Painted Plaster Other (specify)

Approx. length, width, height of structural remains:

ϕ 0,70m depth: 10m or more

Description:

well tube, cut entirely into bedrock, ϕ of 0,70m stays constant down to 10m depth, cutmarks from the creation of the well are very good to see.

Sketch (if applicable, indicate North)

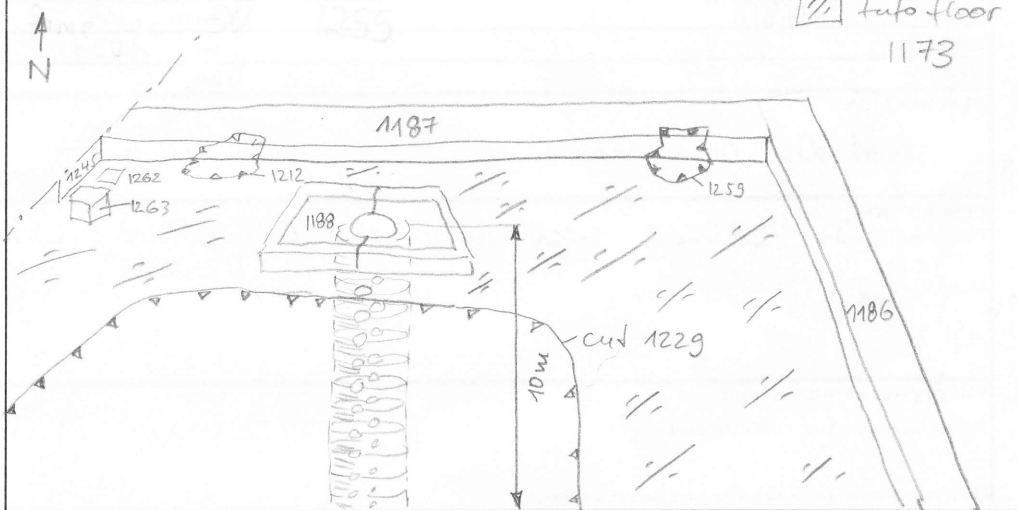

INTERPRETATION

Well, cut into the bedrock with footsteps on either side. The well is empty down to a depth of 10m, but was deeper originally or water table changed, since we hit soil during the measurement and not water. The well is inaccessible for safety reason and is covered by two big tufo slabs.

SOIL SAMPLING: Yes No

Total volume of layer (buckets):

Sample quantity (buckets):

Sample fraction (%):

NON SOIL SAMPLES: Yes No

If yes, specify (e.g. charcoal, mortar etc.):

Size:

SIEVING: Yes No

Total volume of layer (buckets):

Sample quantity (buckets):

Sample fraction (%):

STRATIGRAPHICAL RELIABILITY

Good Fair Poor

Filled-out by *CNN*

on 28.07.2010

Revised by *CNN*

on 03.08.2010

PDFd by

on

Entered by

on