

SITE	YEAR	AREA	SECTOR	ELEVATION	STRATIGRAPHICAL UNIT	Gabri Project
GPR	2010 2012	B		Min: / Max: /	1307 <input type="checkbox"/> Natural <input checked="" type="checkbox"/> Anthropic 2010	

In cross-section? <input type="checkbox"/> Yes <input checked="" type="checkbox"/> No	In elevation drawing? <input type="checkbox"/> Yes <input checked="" type="checkbox"/> No	Photos: <input checked="" type="checkbox"/> Yes <input type="checkbox"/> No #: 1403-1412	Photo Model: <input type="checkbox"/> Yes <input checked="" type="checkbox"/> No #:
---	---	--	---

DEFINITION long ditch feature with pottery	Covered by <input checked="" type="checkbox"/> SU: 0	Fills <input checked="" type="checkbox"/> SU: 1489	Filled by <input type="checkbox"/> SU:
---	---	---	---

HOW IS LAYER DISTINGUISHED? <input checked="" type="checkbox"/> Color <input checked="" type="checkbox"/> Composition <input checked="" type="checkbox"/> Compaction	FORMATION PROCESS <input checked="" type="checkbox"/> Accumulation <input type="checkbox"/> Construction <input type="checkbox"/> Cutting <input type="checkbox"/> Erosion <input type="checkbox"/> Collapse <input type="checkbox"/> Intentional deposition
---	---

INCLUSIONS For each inclusion specify frequency: (f)requent, (m)edium, (r)are			SOIL/MATRIX
Anthropic	Geological	Organic	clay ___% silt 80% sand 20%
<input checked="" type="checkbox"/> Pottery f <input checked="" type="checkbox"/> Tiles f <input type="checkbox"/> Amphorae <input checked="" type="checkbox"/> Dolia f <input type="checkbox"/> Mosaic tile(s) <input type="checkbox"/> Mortar <input type="checkbox"/> Coins <input type="checkbox"/> Metal (specify) <input type="checkbox"/> Collapse debris <input type="checkbox"/> Glass	<input type="checkbox"/> Nails <input type="checkbox"/> Marble <input type="checkbox"/> Quarried debris <input type="checkbox"/> Slag <input type="checkbox"/> Brick <input type="checkbox"/> Basalt slabs <input type="checkbox"/> Opus signinum <input type="checkbox"/> Painted plaster <input type="checkbox"/> Burnt Adobe <input type="checkbox"/> Other (specify)	<input checked="" type="checkbox"/> Tufo (specify) f, local <input checked="" type="checkbox"/> Travertine m <input type="checkbox"/> Other Limestone <input type="checkbox"/> Basalt <input type="checkbox"/> Clay <input type="checkbox"/> Sand <input type="checkbox"/> Silt <input type="checkbox"/> Pebbles (range) <input type="checkbox"/> Gravel (range)	<input checked="" type="checkbox"/> Granular <input type="checkbox"/> Layered <input type="checkbox"/> Cohesive
			Compaction
			<input type="checkbox"/> Hard <input checked="" type="checkbox"/> Compact <input type="checkbox"/> Friable <input type="checkbox"/> Loose <input type="checkbox"/> Soft
			Color
			<input type="checkbox"/> Black <input type="checkbox"/> Brown <input type="checkbox"/> Gray <input checked="" type="checkbox"/> Light Brown <input type="checkbox"/> Light Gray <input type="checkbox"/> White <input type="checkbox"/> Yellow <input type="checkbox"/> Red <input type="checkbox"/> Light Yellow <input type="checkbox"/> Other (specify)

UNIT LIMITS (also indicate on overlay)		Depth: <input checked="" type="checkbox"/> Original <input type="checkbox"/> Not Original
Northern Limit	<input checked="" type="checkbox"/> Original <input type="checkbox"/> Not Original <input type="checkbox"/> Excavation Limit	
Southern Limit	<input checked="" type="checkbox"/> Original <input type="checkbox"/> Not Original <input type="checkbox"/> Excavation Limit	
Western Limit	<input checked="" type="checkbox"/> Original <input type="checkbox"/> Not Original <input type="checkbox"/> Excavation Limit	
Eastern Limit	<input checked="" type="checkbox"/> Original <input type="checkbox"/> Not Original <input type="checkbox"/> Excavation Limit	

STRATIGRAPHICAL SEQUENCE	
Is equal to:	Is bound to (only for masonry):
Is abutted by:	Abuts:
Is covered by: SU 0	Covers: SU 1489
Is cut by:	Cuts:
Is filled by:	Fills:

OBSERVATIONS SU was discovered in 2010, but excavated in 2012 prior of some backfilling activities in trench B

DESCRIPTION
Position within sector: North central Area B
Shape: linear with a semi circular extension to the east

For layers complete this section:
Surface (slope direction; visible inclusions): Many visible fragments of tiled dolia + tufo; one small tufo block + one small limestone block visible at north end
Observations about inclusions (Clusters? Deposition slope): Visible inclusions concentrated south of circular edge
Observations about thickness (Increases? Decreases?): thickness stays the same
Nature of the interface with layer below: sharp diffuse commingled other (specify)

For cuts complete this section:

Cut edges: rounded straight

Cut sides: straight concave convex sloping

Cut bottom: flat concave irregular

How is cut top edge? sharp rounded

How is cut bottom edge? sharp rounded

Observations:

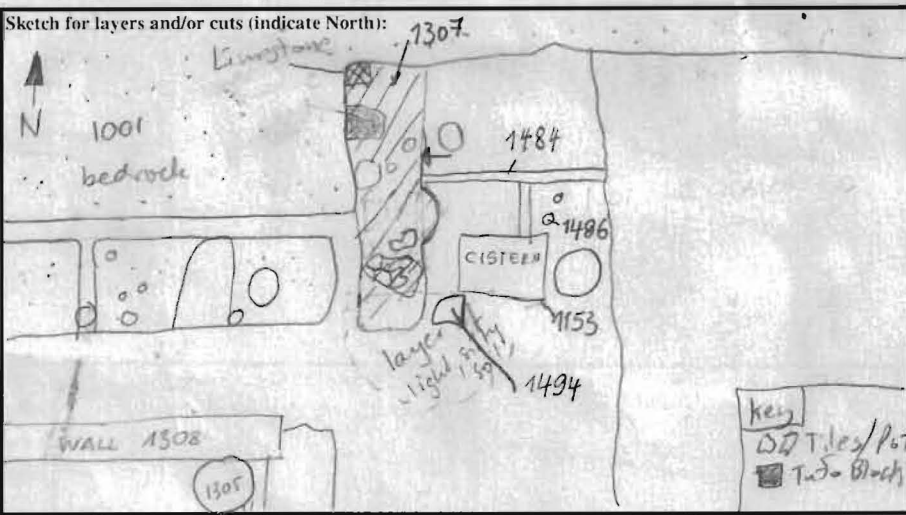

8

For structural remains complete this section

Alignment:

Building Technique: Adobe/Mud-brick Ashlar (blocks) irregular (unworked) stone Concrete Other (specify)

Binding Agent: None Clay Mortar (if so, specify composition, color, compaction)

Concrete inclusions:

Material: Tufo Basalt Travertine Tiles Other (specify)
 Size: Small (range) _____ Medium (range) _____ Large (range) _____ Representative size: e.g. 2 x 1 x 2 cmz

Wall Facing:

Opus quadratum Opus incertum Opus reticulatum Petit appareil Opus testaceum Opus mixtum Opus vittatum Other (specify)

Complete this section for foundations Faced foundation Wooden shuttering No shuttering

floor/revetment type

Floor type: Beaten Earth Opus signinum Opus scutulatum Opus Sectile Mosaic Opus spicatum Other (specify)

Wall finishing: Stucco Opus signinum Plaster Painted Plaster Other (specify)

Approx. length, width, height of structural remains:

Description:

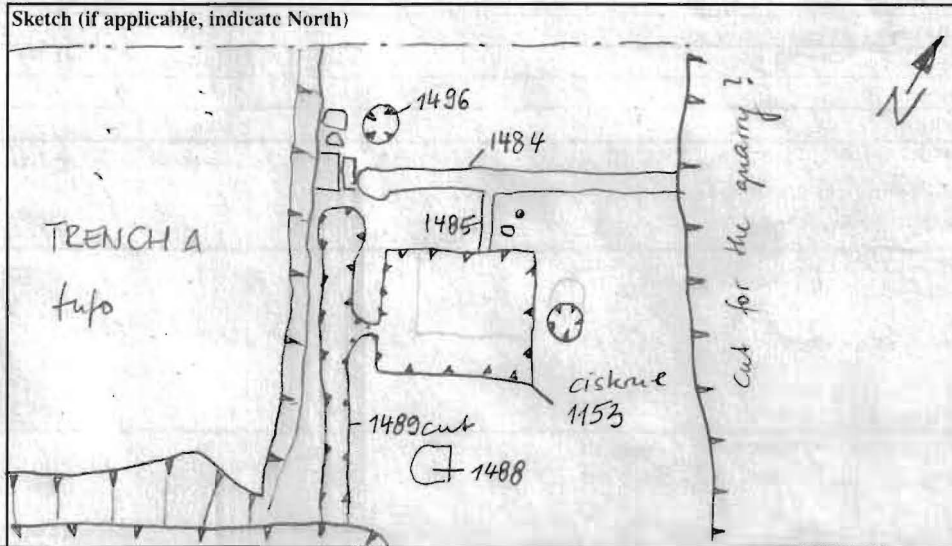

INTERPRETATION

fill of a drainage channel, filled with secondary deposited material, the channel has a spout towards the cistern (SU 1153) and seems to have transported the water into the cistern.

SOIL SAMPLING: Yes No

Total volume of layer (buckets):

Sample quantity (buckets):

Sample fraction (%):

NON SOIL SAMPLES: Yes No

If yes, specify (e.g. charcoal, mortar etc.):

Size:

SIEVING: Yes No

Total volume of layer (buckets):

Sample quantity (buckets):

Sample fraction (%):

STRATIGRAPHICAL RELIABILITY

Good Fair Poor

Filled-out by	CHM	on	03.08.2010 / 19.6.2012
Revised by	CHM	on	03.08.2010 / 19.6.2012
PDFd by		on	
Entered by		on	