

| | | | | | | |
|--------------------|-------------------|------------------|---------------|--|---|--|
| SITE GPR | YEAR 11 | AREA B | SECTOR | ELEVATION Min: 62.448 Max: 63.678 | STRATIGRAPHICAL UNIT 1402 <input type="checkbox"/> Natural <input checked="" type="checkbox"/> Anthropic |  Gabiil Project |
|--------------------|-------------------|------------------|---------------|--|---|--|

| | | | |
|---|---|--|---|
| In cross-section? <input type="checkbox"/> Yes <input checked="" type="checkbox"/> No | In elevation drawing? <input type="checkbox"/> Yes <input checked="" type="checkbox"/> No | Photos: <input checked="" type="checkbox"/> Yes <input type="checkbox"/> No #: 2168 75 | Photo Model: <input checked="" type="checkbox"/> Yes <input type="checkbox"/> No #: 319 |
|---|---|--|---|

| | | | |
|---|--|---|---|
| DEFINITION Small east of corridor SU 1322 | Covered by <input checked="" type="checkbox"/> SU: 1016 | Fills <input checked="" type="checkbox"/> SU: 1476 | Filled by <input type="checkbox"/> SU: |
|---|--|---|---|

| | |
|--|--|
| HOW IS LAYER DISTINGUISHED? <input type="checkbox"/> Color <input checked="" type="checkbox"/> Composition <input type="checkbox"/> Compaction | FORMATION PROCESS <input type="checkbox"/> Accumulation <input checked="" type="checkbox"/> Construction <input type="checkbox"/> Cutting <input type="checkbox"/> Erosion <input type="checkbox"/> Collapse <input type="checkbox"/> Intentional deposition |
|--|--|

| | | | | |
|---|---|--|--|--|
| INCLUSIONS For each inclusion specify frequency: (f)requent, (m)edium, (r)are | | | SOIL/MATRIX | |
| Anthropic | Geological | Organic | clay ___% silt ___% sand ___% | <input type="checkbox"/> Granular <input type="checkbox"/> Layered <input type="checkbox"/> Cohesive |
| <input type="checkbox"/> Pottery <input type="checkbox"/> Tiles <input type="checkbox"/> Amphorae <input type="checkbox"/> Dolia <input type="checkbox"/> Mosaic tile(s) <input type="checkbox"/> Mortar <input type="checkbox"/> Coins <input type="checkbox"/> Metal (specify) <input type="checkbox"/> Collapse debris <input type="checkbox"/> Glass | <input type="checkbox"/> Tufo (specify) <input type="checkbox"/> Travertine <input type="checkbox"/> Other Limestone <input type="checkbox"/> Basalt <input type="checkbox"/> Clay <input type="checkbox"/> Sand <input type="checkbox"/> Silt <input type="checkbox"/> Pebbles (range) <input type="checkbox"/> Gravel (range) | <input type="checkbox"/> Charcoal <input type="checkbox"/> Ash <input type="checkbox"/> Animal bones <input type="checkbox"/> Human bones <input type="checkbox"/> Animal teeth <input type="checkbox"/> Human teeth <input type="checkbox"/> Shells <input type="checkbox"/> Other (specify) | | |
| | | | Compaction | Color |
| | | | <input type="checkbox"/> Hard <input type="checkbox"/> Compact <input type="checkbox"/> Friable <input type="checkbox"/> Loose <input type="checkbox"/> Soft | <input type="checkbox"/> Black <input type="checkbox"/> Brown <input type="checkbox"/> Gray <input type="checkbox"/> Light Brown <input type="checkbox"/> Light Gray <input type="checkbox"/> White <input type="checkbox"/> Yellow <input type="checkbox"/> Red <input type="checkbox"/> Light Yellow <input type="checkbox"/> Other (specify) |

| | | |
|---|--|--|
| UNIT LIMITS (also indicate on overlay) | | Depth: <input checked="" type="checkbox"/> Original <input type="checkbox"/> Not Original |
| Northern Limit | <input checked="" type="checkbox"/> Original <input type="checkbox"/> Not Original <input type="checkbox"/> Excavation Limit | |
| Southern Limit | <input checked="" type="checkbox"/> Original <input type="checkbox"/> Not Original <input type="checkbox"/> Excavation Limit | |
| Western Limit | <input checked="" type="checkbox"/> Original <input type="checkbox"/> Not Original <input type="checkbox"/> Excavation Limit | |
| Eastern Limit | <input checked="" type="checkbox"/> Original <input type="checkbox"/> Not Original <input type="checkbox"/> Excavation Limit | |

| | |
|--|--|
| STRATIGRAPHICAL SEQUENCE | |
| Is equal to: | Is bound to (only for masonry): |
| Is abutted by: 1279, 1383, 1385 | Abuts: 1032 |
| Is covered by: 1016 | Covers: |
| Is cut by: | Cuts: |
| Is filled by: | Fills: 1476 |

| |
|---|
| OBSERVATIONS SU was visible in 2008, but properly excavated in 2011 |
|---|

| |
|---|
| DESCRIPTION |
| Position within sector: Trench Central through eastern part of Trench B 2011 |
| Shape: linear with irregular extension to the east |

| |
|--|
| For layers complete this section: |
| Surface (slope direction: visible inclusions): |
| Observations about inclusions (Clusters? Deposition slope): |
| Observations about thickness (Increases? Decreases?): |
| Nature of the interface with layer below: <input type="checkbox"/> sharp <input type="checkbox"/> diffuse <input type="checkbox"/> commingled <input type="checkbox"/> other (specify) |

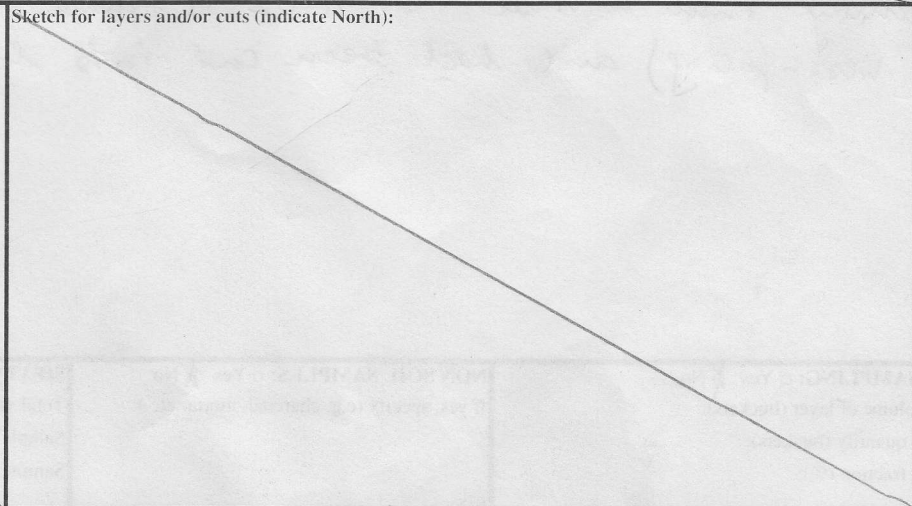
| | |
|--|--|
| For cuts complete this section: | Sketch for layers and/or cuts (indicate North): |
| Cut edges: <input type="checkbox"/> rounded <input type="checkbox"/> straight Cut sides: <input type="checkbox"/> straight <input type="checkbox"/> concave <input type="checkbox"/> convex <input type="checkbox"/> sloping Cut bottom: <input type="checkbox"/> flat <input type="checkbox"/> concave <input type="checkbox"/> irregular How is cut top edge? <input type="checkbox"/> sharp <input type="checkbox"/> rounded How is cut bottom edge? <input type="checkbox"/> sharp <input type="checkbox"/> rounded Observations: |  |

For structural remains complete this section

Alignment: (Side) N-S

Building Technique: Adobe/Mud-brick Ashlar (blocks) Irregular (unworked) stone Concrete Other (specify)

Binding Agent: None Clay Mortar (if so, specify composition, color, compaction)

Concrete inclusions:

Material: Tufo Basalt Travertine Tiles Other (specify)
 Size: Small (range) 6x6 cm Medium (range) 15x20 cm Large (range) 40x40 cm Representative size: e.g. 2 x 1 x 2 cmz

Wall Facing: _____

Opus quadratum Opus incertum Opus reticulatum Petit appareil Opus testaceum Opus mixtum Opus vittatum Other (specify)

Complete this section for foundations Faced foundation Wooden shuttering No shuttering

Floor/revetment type: _____

Floor type: Beaten Earth Opus signinum Opus scutulatum Opus Sectile Mosaic Opus spicatum Other (specify)

Wall finishing Stucco Opus signinum Plaster Painted Plaster Other (specify)

Approx. length, width, height of structural remains:

Length = _____ Height (from top to bottom of sewer) = ca. 70 cm

Width = 20-40 cm

Description:

Consists of mainly irregular stones, though some tufo blocks are worked. Mostly tufo, but a few basalt + travertine stones are visible. Where there are worked stones the lining is very regular, elsewhere (especially to the north + south) it is irregular + in fact difficult to follow.

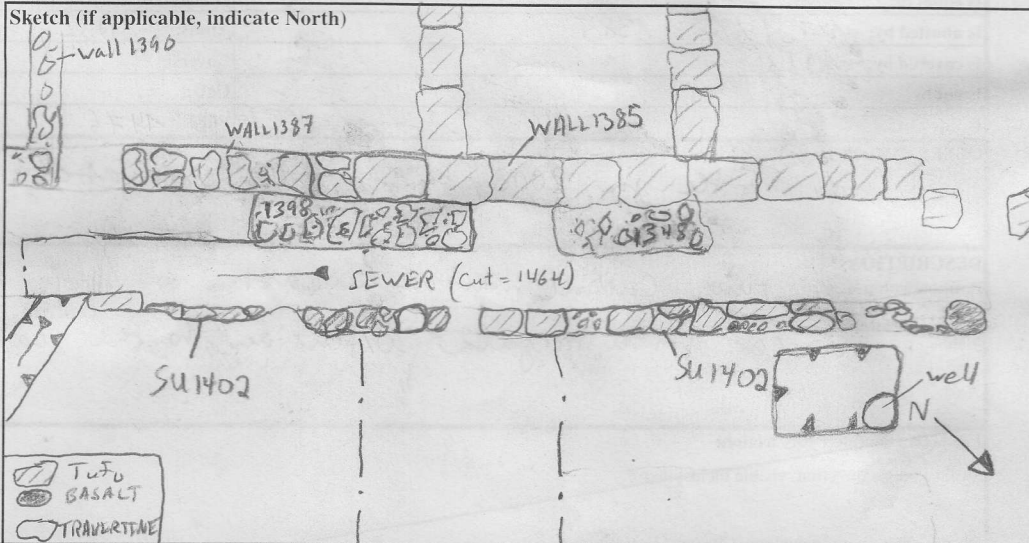

INTERPRETATION

Stone lining of a drainage channel (SU 1322), rather a lining than a wall. SU 1402 is faced towards drainage channel (west-facing) and had been cut into layers 1032, 1389.

SOIL SAMPLING: Yes No

Total volume of layer (buckets):

Sample quantity (buckets):

Sample fraction (%):

NON SOIL SAMPLES: Yes No

If yes, specify (e.g. charcoal, mortar etc.):

Size:

SIEVING: Yes No

Total volume of layer (buckets):

Sample quantity (buckets):

Sample fraction (%):

STRATIGRAPHICAL RELIABILITY

Good Fair Poor

| | | | |
|---------------|---------|----|----------|
| Filled-out by | J. Farr | on | 2.8.2011 |
| Revised by | CMH | on | 3.8.2011 |
| PDFd by | EUR | on | 3.8.2011 |
| Entered by | | on | |