

SITE GPR	YEAR 17	AREA B	SECTOR	ELEVATION Min: 62.771 Max: 62.918	STRATIGRAPHICAL UNIT	
					1434	<input type="checkbox"/> Natural <input checked="" type="checkbox"/> Anthropic
In cross-section? <input type="checkbox"/> Yes <input type="checkbox"/> No			In elevation drawing? <input type="checkbox"/> Yes <input type="checkbox"/> No		Photos: <input checked="" type="checkbox"/> Yes <input type="checkbox"/> No #: 1908-1909	Photo Model: <input checked="" type="checkbox"/> Yes <input type="checkbox"/> No #:
DEFINITION rubble wall cut into tufo floor 1417				Covered by <input checked="" type="checkbox"/> SU: 1327	Fills <input checked="" type="checkbox"/> SU: 1436	Filled by <input type="checkbox"/> SU:
HOW IS LAYER DISTINGUISHED? <input type="checkbox"/> Color <input type="checkbox"/> Composition <input type="checkbox"/> Compaction			FORMATION PROCESS <input type="checkbox"/> Accumulation <input checked="" type="checkbox"/> Construction <input type="checkbox"/> Cutting <input type="checkbox"/> Erosion <input type="checkbox"/> Collapse <input type="checkbox"/> Intentional deposition			
INCLUSIONS For each inclusion specify frequency: (f)requent, (m)edium, (r)are					SOIL/MATRIX clay ___% silt ___% sand ___%	
Anthropic		Geological		Organic		
<input type="checkbox"/> Pottery <input type="checkbox"/> Nails <input type="checkbox"/> Tiles <input type="checkbox"/> Marble <input type="checkbox"/> Amphorae <input type="checkbox"/> Quarried debris <input type="checkbox"/> Dolia <input type="checkbox"/> Slag <input type="checkbox"/> Brick <input type="checkbox"/> Mosaic tile(s) <input type="checkbox"/> Basalt slabs <input type="checkbox"/> Mortar <input type="checkbox"/> Opus signinum <input type="checkbox"/> Coins <input type="checkbox"/> Painted plaster <input type="checkbox"/> Metal (specify) <input type="checkbox"/> Burnt Adobe <input type="checkbox"/> Collapse debris <input type="checkbox"/> Other (specify) <input type="checkbox"/> Glass		<input type="checkbox"/> Tufo (specify) <input type="checkbox"/> Travertine <input type="checkbox"/> Other Limestone <input type="checkbox"/> Basalt <input type="checkbox"/> Clay <input type="checkbox"/> Sand <input checked="" type="checkbox"/> Silt <input type="checkbox"/> Pebbles (range) <input type="checkbox"/> Gravel (range)		<input type="checkbox"/> Charcoal <input type="checkbox"/> Ash <input type="checkbox"/> Animal bones <input type="checkbox"/> Human bones <input type="checkbox"/> Animal teeth <input type="checkbox"/> Human teeth <input type="checkbox"/> Shells <input type="checkbox"/> Other (specify)		
					<input type="checkbox"/> Granular <input type="checkbox"/> Layered <input type="checkbox"/> Cohesive <b>Compaction</b> <input type="checkbox"/> Hard <input type="checkbox"/> Compact <input type="checkbox"/> Friable <input type="checkbox"/> Loose <input type="checkbox"/> Soft <b>Color</b> <input type="checkbox"/> Black <input type="checkbox"/> Brown <input type="checkbox"/> Gray <input type="checkbox"/> Light Brown <input type="checkbox"/> Light Gray <input type="checkbox"/> White <input type="checkbox"/> Yellow <input type="checkbox"/> Red <input type="checkbox"/> Light Yellow <input type="checkbox"/> Other (specify)	
UNIT LIMITS (also indicate on overlay)						
Northern Limit			<input checked="" type="checkbox"/> Original <input type="checkbox"/> Not Original <input type="checkbox"/> Excavation Limit		Depth: <input type="checkbox"/> Original <input checked="" type="checkbox"/> Not Original	
Southern Limit			<input checked="" type="checkbox"/> Original <input type="checkbox"/> Not Original <input type="checkbox"/> Excavation Limit			
Western Limit			<input type="checkbox"/> Original <input checked="" type="checkbox"/> Not Original <input type="checkbox"/> Excavation Limit			
Eastern Limit			<input type="checkbox"/> Original <input checked="" type="checkbox"/> Not Original <input type="checkbox"/> Excavation Limit			
STRATIGRAPHICAL SEQUENCE						
Is equal to:			Is bound to (only for masonry):			
Is abutted by:			Abuts:			
Is covered by: 1327			Covers: 1435			
Is cut by: 1347 on East, cuts on west			Cuts:			
Is filled by:			Fills: 1436			
OBSERVATIONS						
DESCRIPTION Position within sector: Southwest in Trench B, past 2010 excavation limit Shape: square-rectangular						
For layers complete this section: Surface (slope direction; visible inclusions): Observations about inclusions (Clusters? Deposition slope): Observations about thickness (Increases? Decreases?): Nature of the interface with layer below: <input type="checkbox"/> sharp <input type="checkbox"/> diffuse <input type="checkbox"/> commingled <input type="checkbox"/> other (specify)						
For cuts complete this section: Cut edges: <input type="checkbox"/> rounded <input type="checkbox"/> straight Cut sides: <input type="checkbox"/> straight <input type="checkbox"/> concave <input type="checkbox"/> convex <input type="checkbox"/> sloping Cut bottom: <input type="checkbox"/> flat <input type="checkbox"/> concave <input type="checkbox"/> irregular How is cut top edge? <input type="checkbox"/> sharp <input type="checkbox"/> rounded How is cut bottom edge? <input type="checkbox"/> sharp <input type="checkbox"/> rounded Observations:			Sketch for layers and/or cuts (indicate North):			

**For structural remains complete this section**

Alignment: *appears to have been running East-West*

Building Technique:  Adobe/Mud-brick  Ashlar (blocks)  Irregular (unworked) stone  Concrete  Other (specify)

Binding Agent:  None  Clay  Mortar (if so, specify composition, color, compaction)

Concrete inclusions:

Material  Tufo  Basalt  Travertine  Tiles  Other (specify)

Size  Small (range) \_\_\_\_\_  Medium (range) \_\_\_\_\_  Large (range) \_\_\_\_\_ Representative size: e.g. 2 x 1 x 2 cmz

Wall Facing:

Opus quadratum  Opus incertum  Opus reticulatum  Petit appareil  Opus testaceum  Opus mixtum  Opus vittatum  Other (specify)

Complete this section for foundations  Faced foundation  Wooden shuttering  No shuttering

floor/revetment type

Floor type:  Beaten Earth  Opus signinum  Opus scutulatum  Opus Sectile  Mosaic  Opus spicatum  Other (specify)

Wall finishing  Stucco  Opus signinum  Plaster  Painted Plaster  Other (specify)

Approx. length, width, height of structural remains: *approximately 78cm East-West, 61cm north-south, 0.2m*

Description: *Small fragmentary portion of a wall presumably running East-West, truncated by 'Leadthissa' in east and by cut 1421 in west and appears to have disturbed tufo floor 1417 in south. Rubble wall of unworked stone.*

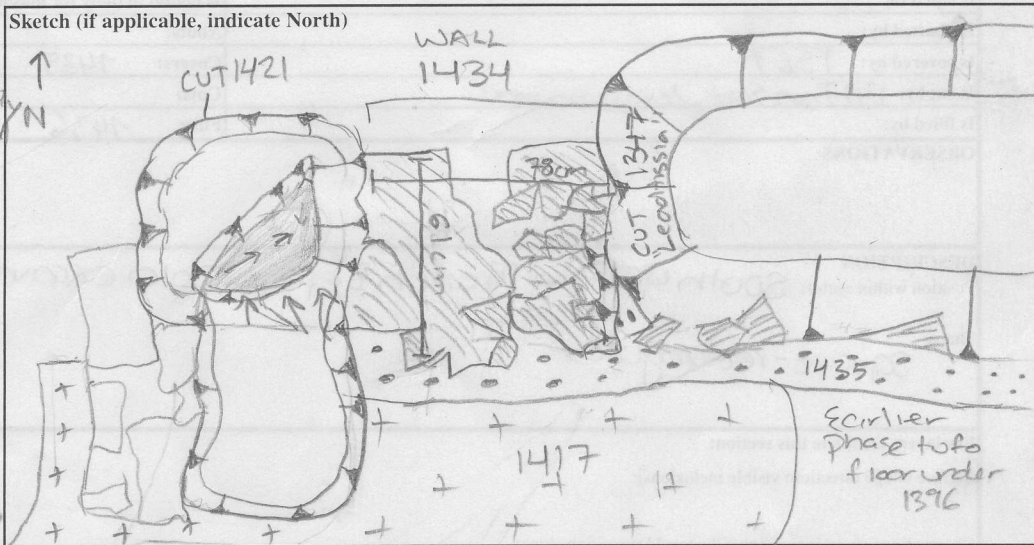

**INTERPRETATION**

*rubble wall (foundation), rubble built*

SOIL SAMPLING:  Yes  No

Total volume of layer (buckets):

Sample quantity (buckets):

Sample fraction (%):

NON SOIL SAMPLES:  Yes  No

If yes, specify (e.g. charcoal, mortar etc.):

Size:

SIEVING:  Yes  No

Total volume of layer (buckets):

Sample quantity (buckets):

Sample fraction (%):

**STRATIGRAPHICAL RELIABILITY**

Good  Fair  Poor

Filled-out by	<i>SH</i>	on	<i>July 25<sup>th</sup> 2011</i>
Revised by	<i>CRM</i>	on	<i>27.7.2011</i>
PDFd by	<i>ECR</i>	on	<i>27-7-2011</i>
Entered by		on	