

SITE GPR	YEAR 2011	AREA B	SECTOR	ELEVATION Min: 62.326 Max: 62.507	STRATIGRAPHICAL UNIT 1456 <input type="checkbox"/> Natural <input type="checkbox"/> Anthropoc
-------------	--------------	-----------	--------	---	---

In cross-section? <input type="checkbox"/> Yes <input checked="" type="checkbox"/> No	In elevation drawing? <input type="checkbox"/> Yes <input checked="" type="checkbox"/> No	Photos: <input checked="" type="checkbox"/> Yes <input type="checkbox"/> No #: 1981, 82	Photo Model: <input type="checkbox"/> Yes <input checked="" type="checkbox"/> No #:
---	---	---	---

DEFINITION Dark brown rocky layer beneath 1442	Covered by <input checked="" type="checkbox"/> SU: 442	Fills <input type="checkbox"/> SU:	Filled by <input type="checkbox"/> SU:
---	---	---------------------------------------	---

HOW IS LAYER DISTINGUISHED? <input checked="" type="checkbox"/> Color <input type="checkbox"/> Composition <input type="checkbox"/> Compaction	FORMATION PROCESS <input checked="" type="checkbox"/> Accumulation <input type="checkbox"/> Construction <input type="checkbox"/> Cutting <input type="checkbox"/> Erosion <input type="checkbox"/> Collapse <input type="checkbox"/> Intentional deposition
---	---

INCLUSIONS For each inclusion specify frequency: (f)requent, (m)edium, (r)are			SOIL/MATRIX clay 10% silt 80% sand 10% <input checked="" type="checkbox"/> Granular <input type="checkbox"/> Layered <input type="checkbox"/> Cohesive	
<b>Anthropic</b>	<b>Geological</b>	<b>Organic</b>	<b>Compaction</b>	
<input checked="" type="checkbox"/> Pottery M <input type="checkbox"/> Tiles <input checked="" type="checkbox"/> Amphorae R <input type="checkbox"/> Dolia <input type="checkbox"/> Mosaic tiles <input type="checkbox"/> Mortar <input type="checkbox"/> Coins <input checked="" type="checkbox"/> Metal (specify) R <input type="checkbox"/> Collapse debris <input type="checkbox"/> Glass	<input checked="" type="checkbox"/> Tufo (specify) F <input type="checkbox"/> Travertine <input type="checkbox"/> Other Limestone <input type="checkbox"/> Basalt <input checked="" type="checkbox"/> Clay R <input checked="" type="checkbox"/> Sand R <input checked="" type="checkbox"/> Silt F <input type="checkbox"/> Pebbles (range) <input type="checkbox"/> Gravel (range)	<input checked="" type="checkbox"/> Charcoal M <input type="checkbox"/> Ash <input checked="" type="checkbox"/> Animal bones M <input type="checkbox"/> Human bones <input checked="" type="checkbox"/> Animal teeth M <input type="checkbox"/> Human teeth <input type="checkbox"/> Shells <input type="checkbox"/> Other (specify)	<b>Color</b> <input type="checkbox"/> Hard <input checked="" type="checkbox"/> Compact <input type="checkbox"/> Friable <input type="checkbox"/> Loose <input type="checkbox"/> Soft <input type="checkbox"/> Black <input checked="" type="checkbox"/> Brown <input type="checkbox"/> Gray <input type="checkbox"/> Light Brown <input type="checkbox"/> Light Gray <input type="checkbox"/> White <input type="checkbox"/> Yellow <input type="checkbox"/> Red <input type="checkbox"/> Light Yellow <input type="checkbox"/> Other (specify)	

UNIT LIMITS (also indicate on overlay)		Depth: <input checked="" type="checkbox"/> Original <input type="checkbox"/> Not Original
Northern Limit	<input type="checkbox"/> Original <input type="checkbox"/> Not Original <input checked="" type="checkbox"/> Excavation Limit	
Southern Limit	<input checked="" type="checkbox"/> Original <input type="checkbox"/> Not Original <input type="checkbox"/> Excavation Limit	
Western Limit	<input checked="" type="checkbox"/> Original <input type="checkbox"/> Not Original <input type="checkbox"/> Excavation Limit	
Eastern Limit	<input checked="" type="checkbox"/> Original <input type="checkbox"/> Not Original <input type="checkbox"/> Excavation Limit	

STRATIGRAPHICAL SEQUENCE	
Is equal to:	Is bound to (only for masonry):
Is abutted by:	Abuts:
Is covered by: 1447	Covers: 1433
Is cut by: 1438	Cuts:
Is filled by:	Fills:

OBSERVATIONS  
 Δ589 - Ochre Fragment Δ591 - Bronze Object

DESCRIPTION  
 Position within sector: South central area of B, between structure & quarry  
 Shape: irregular

For layers complete this section:  
 Surface (slope direction; visible inclusions): Slopes to the north east  
 Observations about inclusions (Clusters? Deposition slope):  
 Observations about thickness (Increases? Decreases?): increases to north  
 Nature of the interface with layer below:  sharp  diffuse  commingled  other (specify)

For cuts complete this section:  
 Cut edges:  rounded  straight  
 Cut sides:  straight  concave  convex  sloping  
 Cut bottom:  flat  concave  irregular  
 How is cut top edge?  sharp  rounded  
 How is cut bottom edge?  sharp  rounded  
 Observations:

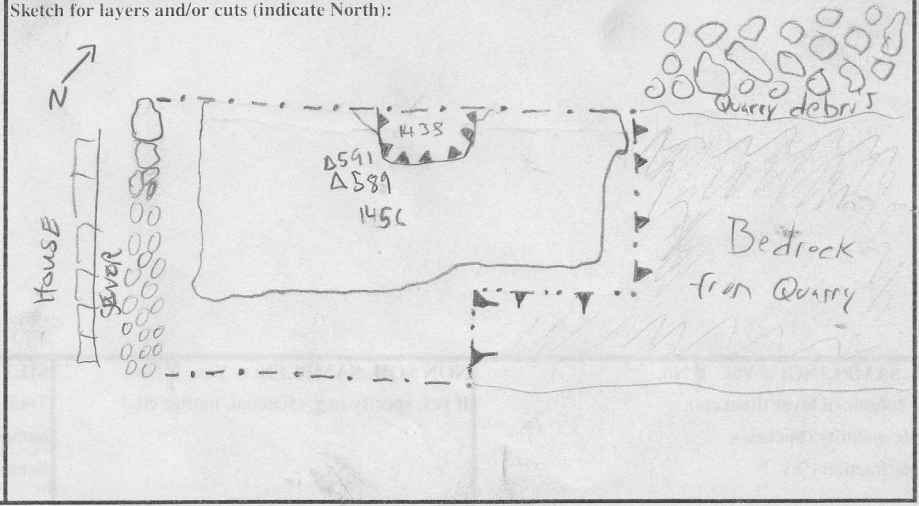

**For structural remains complete this section**

Alignment:

Building Technique:  Adobe/Mud-brick  Ashlar (blocks)  irregular (unworked) stone  Concrete  Other (specify)

Binding Agent:  None  Clay  Mortar (if so, specify composition, color, compaction)

Concrete inclusions:

Material  Tufo  Basalt  Travertine  Tiles  Other (specify)  
 Size  Small (range) \_\_\_\_\_  Medium (range) \_\_\_\_\_  Large (range) \_\_\_\_\_ Representative size: e.g. 2 x 1 x 2 cmz

Wall Facing:

Opus quadratum  Opus incertum  Opus reticulatum  Petit appareil  Opus testaceum  Opus mixtum  Opus vittatum  Other (specify)

Complete this section for foundations  Faced foundation  Wooden shuttering  No shuttering

floor/revetment type

Floor type:  Beaten Earth  Opus signinum  Opus scutulatum  Opus Sectile  Mosaic  Opus spicatum  Other (specify)

Wall finishing  Stucco  Opus signinum  Plaster  Painted Plaster  Other (specify)

Approx. length, width, height of structural remains:

Description:

Sketch (if applicable, indicate North)

**INTERPRETATION**

SU 1456 is a rocky layer of silt + small fragments of tufo, probably resulting from natural, post-abandonment deposition. It is cut by 1438, which may relate to quarrying activity.

**SOIL SAMPLING:**  Yes  No

Total volume of layer (buckets):

Sample quantity (buckets):

Sample fraction (%):

**NON SOIL SAMPLES:**  Yes  No

If yes, specify (e.g. charcoal, mortar etc.):

Size:

**SIEVING:**  Yes  No

Total volume of layer (buckets):

Sample quantity (buckets):

Sample fraction (%):

**STRATIGRAPHICAL RELIABILITY**

Good  Fair  Poor

Filled-out by *A. Raymond*

on *27.7.11*

Revised by *J. FARR*

on *29.7.11*

PDFd by *BCR*

on *1/8/11*

Entered by

on