

SITE	YEAR	AREA	SECTOR	ELEVATION	STRATIGRAPHICAL UNIT
GPR	11	B		Min: 62.295 Max: 62.377	1478 <input type="checkbox"/> Natural <input checked="" type="checkbox"/> Anthropic

In cross-section? Yes No In elevation drawing? Yes No Photos: Yes No #: 2203-2204 Photo Model: Yes No #:

DEFINITION: *fill below tiles in baby grave*

Covered by: SU: 1466 Fills: SU: 1483 Filled by: SU:

HOW IS LAYER DISTINGUISHED? Color Composition Compaction

FORMATION PROCESS: Accumulation Construction Cutting Erosion Collapse Intentional deposition

INCLUSIONS For each inclusion specify frequency: (f)requent, (m)edium, (r)are

Anthropic	Geological	Organic	SOIL/MATRIX
<i>none</i>	<i>local r</i>		clay 15% silt 80% sand 5%
<input type="checkbox"/> Pottery	<input checked="" type="checkbox"/> Tufo (specify) <i>local r</i>	<input type="checkbox"/> Charcoal	<input checked="" type="checkbox"/> Granular <input type="checkbox"/> Layered <input type="checkbox"/> Cohesive
<input type="checkbox"/> Tiles	<input type="checkbox"/> Travertine	<input type="checkbox"/> Ash	
<input type="checkbox"/> Amphorae	<input type="checkbox"/> Other Limestone	<input type="checkbox"/> Animal bones	
<input type="checkbox"/> Dolia	<input type="checkbox"/> Basalt	<input type="checkbox"/> Human bones	
<input type="checkbox"/> Mosaic tile(s)	<input type="checkbox"/> Clay	<input type="checkbox"/> Animal teeth	
<input type="checkbox"/> Mortar	<input type="checkbox"/> Sand	<input type="checkbox"/> Human teeth	
<input type="checkbox"/> Coins	<input type="checkbox"/> Silt	<input type="checkbox"/> Shells	
<input type="checkbox"/> Metal (specify)	<input type="checkbox"/> Pebbles (range)	<input type="checkbox"/> Other (specify)	
<input type="checkbox"/> Collapse debris	<input type="checkbox"/> Gravel (range)		
<input type="checkbox"/> Glass			

Compaction: Hard Compact Friable Loose Soft

Color: Black Brown Gray Light Brown Light Gray White Yellow Red Light Yellow Other (specify)

UNIT LIMITS (also indicate on overlay)

Northern Limit: Original Not Original Excavation Limit Depth: Original Not Original

Southern Limit: Original Not Original Excavation Limit

Western Limit: Original Not Original Excavation Limit

Eastern Limit: Original Not Original Excavation Limit

grave 45

STRATIGRAPHICAL SEQUENCE

Is equal to:	Is bound to (only for masonry):
Is abutted by:	Abuts:
Is covered by: 1466	Covers: 1479 (imbric), 1481
Is cut by:	Cuts:
Is filled by:	Fills: 1483

OBSERVATIONS: *dry, sunny conditions, good visibility*

DESCRIPTION

Position within sector: *situated at the bottom of sewer 1322, eastern part of Trench B200*

Shape: *oval*

For layers complete this section:

Surface (slope direction; visible inclusions): *no slope, no visible inclusions*

Observations about inclusions (Clusters? Deposition slope): *no cluster, no depos. slope*

Observations about thickness (Increases? Decreases?):

Nature of the interface with layer below: sharp diffuse commingled other (specify)

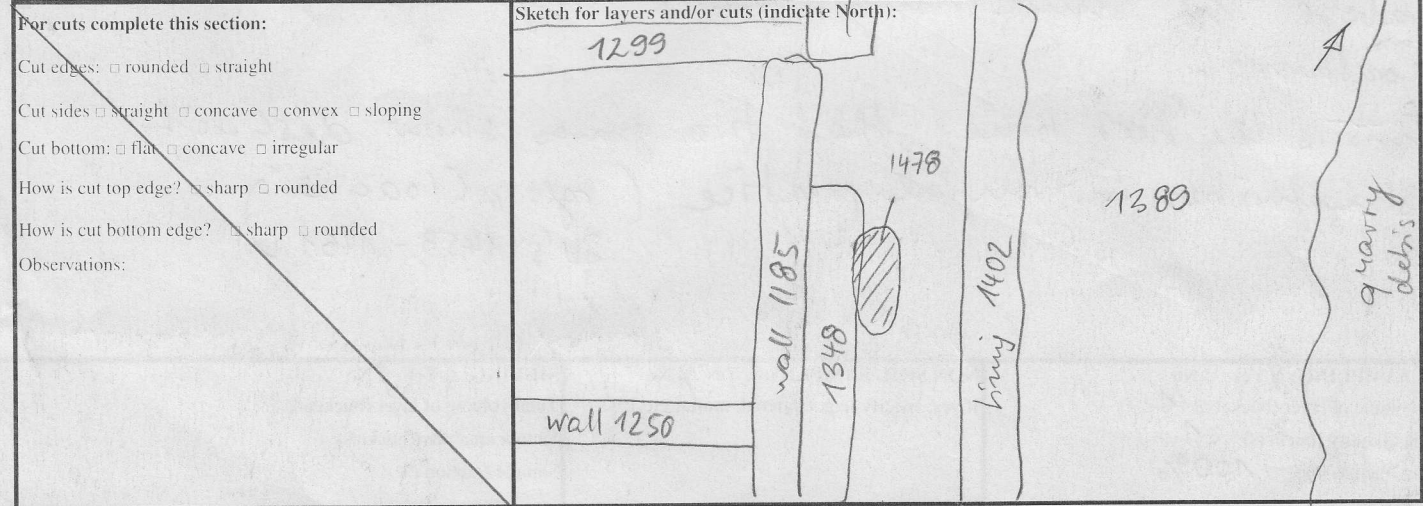

For structural remains complete this section

Alignment:

Building Technique: Adobe/Mud-brick Ashlar (blocks) irregular (unworked) stone Concrete Other (specify)

Binding Agent: None Clay Mortar (if so, specify composition, color, compaction)

Concrete inclusions:

Material Tufo Basalt Travertine Tiles Other (specify)
 Size Small (range) _____ Medium (range) _____ Large (range) _____ Representative size: e.g. 2 x 1 x 2 cmz

Wall Facing:

Opus quadratum Opus incertum Opus reticulatum Petit appareil Opus testaceum Opus mixtum Opus vittatum Other (specify)
 Complete this section for foundations Faced foundation Wooden shuttering No shuttering

Floor/revetment type

Floor type: Beaten Earth Opus signinum Opus scutulatum Opus Sectile Mosaic Opus spicatum Other (specify)
 Wall finishing Stucco Opus signinum Plaster Painted Plaster Other (specify)

Approx. length, width, height of structural remains:

Description:

Sketch (if applicable, indicate North)

INTERPRETATION

Fill below the covering tiles of the infant burial and above the semicircular imbric which was used as burial container.

This is the first time, that two graves show distinct similarities in burial practice (vgl. "Cloacina")
 SU's 1458 - 1461

SOIL SAMPLING: Yes No

Total volume of layer (buckets): 1
 Sample quantity (buckets): 1
 Sample fraction (%): 100%

NON SOIL SAMPLES: Yes No

If yes, specify (e.g. charcoal, mortar etc.):

Size:

SIEVING: Yes No

Total volume of layer (buckets):
 Sample quantity (buckets):
 Sample fraction (%):

STRATIGRAPHICAL RELIABILITY

Good Fair Poor

Filled-out by	CMH	on	2.8.2011
Revised by	CMH	on	2.8.2011
PDFd by	BCR	on	3.8.2011
Entered by		on	