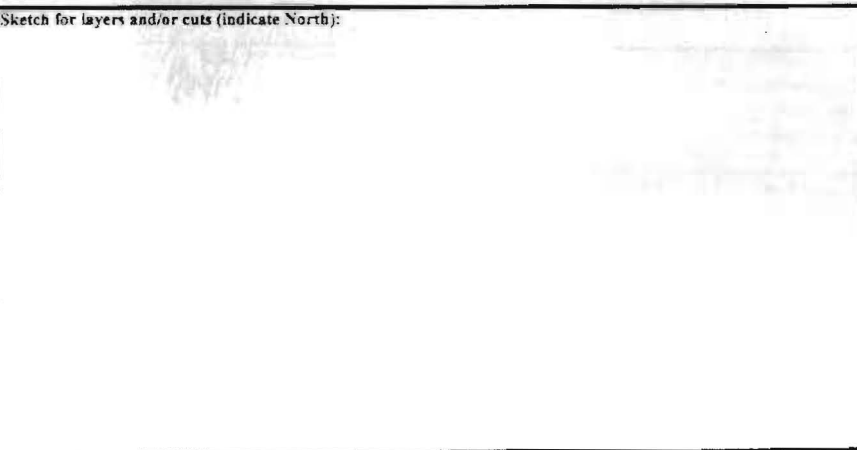

SITE GPR	YEAR 2012	AREA B	SECTOR	ELEVATION		STRATIGRAPHICAL UNIT 1499 <input type="checkbox"/> Natural <input checked="" type="checkbox"/> Anthropic	 Gabii Project
				Min:	Max:		
In cross-section? <input type="checkbox"/> Yes <input checked="" type="checkbox"/> No			In elevation drawing? <input type="checkbox"/> Yes <input checked="" type="checkbox"/> No		Photos: <input checked="" type="checkbox"/> Yes <input type="checkbox"/> No #: 2451-2452		Photo Model: <input type="checkbox"/> Yes <input checked="" type="checkbox"/> No #:
DEFINITION wall like feature				Covered by <input type="checkbox"/> SU:		Fills <input type="checkbox"/> SU:	
HOW IS LAYER DISTINGUISHED? <input type="checkbox"/> Color <input checked="" type="checkbox"/> Composition <input type="checkbox"/> Compaction			FORMATION PROCESS <input type="checkbox"/> Accumulation <input checked="" type="checkbox"/> Construction <input type="checkbox"/> Cutting <input type="checkbox"/> Erosion <input type="checkbox"/> Collapse <input type="checkbox"/> Intentional deposition				
INCLUSIONS For each inclusion specify frequency: (f)requent, (m)edium, (r)are						SOIL/MATRIX clay ___% silt ___% sand ___% <input type="checkbox"/> Granular <input type="checkbox"/> Layered <input type="checkbox"/> Cohesive	
Anthropic <i>none</i>		Geological		Organic <i>none</i>			
<input type="checkbox"/> Pottery <input type="checkbox"/> Nails		<input checked="" type="checkbox"/> Tufo (specify) <i>m</i>		<input type="checkbox"/> Charcoal			
<input type="checkbox"/> Tiles <input type="checkbox"/> Marble		<input checked="" type="checkbox"/> Travertine <i>m</i>		<input type="checkbox"/> Ash			
<input type="checkbox"/> Amphorae <input type="checkbox"/> Quarried debris		<input type="checkbox"/> Other Limestone		<input type="checkbox"/> Animal bones			
<input type="checkbox"/> Dolia <input type="checkbox"/> Slag <input type="checkbox"/> Brick		<input type="checkbox"/> Basalt		<input type="checkbox"/> Human bones			
<input type="checkbox"/> Mosaic tile(s) <input type="checkbox"/> Basalt slabs		<input type="checkbox"/> Clay		<input type="checkbox"/> Animal teeth			
<input type="checkbox"/> Mortar <input type="checkbox"/> Opus signinum		<input type="checkbox"/> Sand		<input type="checkbox"/> Human teeth			
<input type="checkbox"/> Coins <input type="checkbox"/> Painted plaster		<input type="checkbox"/> Silt		<input type="checkbox"/> Shells			
<input type="checkbox"/> Metal (specify)		<input type="checkbox"/> Burnt Adobe		<input type="checkbox"/> Other (specify)			
<input type="checkbox"/> Collapse debris		<input type="checkbox"/> Other (specify)					
<input type="checkbox"/> Glass							
UNIT LIMITS (also indicate on overlay)						Depth: <input checked="" type="checkbox"/> Original <input type="checkbox"/> Not Original	
Northern Limit		<input type="checkbox"/> Original <input checked="" type="checkbox"/> Not Original		<input type="checkbox"/> Excavation Limit			
Southern Limit		<input type="checkbox"/> Original <input checked="" type="checkbox"/> Not Original		<input type="checkbox"/> Excavation Limit			
Western Limit		<input checked="" type="checkbox"/> Original <input type="checkbox"/> Not Original		<input type="checkbox"/> Excavation Limit			
Eastern Limit		<input checked="" type="checkbox"/> Original <input type="checkbox"/> Not Original		<input type="checkbox"/> Excavation Limit			
STRATIGRAPHICAL SEQUENCE							
Is equal to:				Is bound to (only for masonry):			
Is abutted by:				Abuts: 1001			
Is covered by: SU 0				Covers: 1001			
Is cut by:				Cuts:			
Is filled by:				Fills:			
OBSERVATIONS during excavation of cut 1489 it became clear, that SU 1499 is not part of a deposit within a cut, but a built feature							
DESCRIPTION Position within sector: north central in area B Shape: roughly square							
For layers complete this section: Surface (slope direction; visible inclusions): Observations about inclusions (Clusters? Deposition slope): Observations about thickness (Increases? Decreases?): Nature of the interface with layer below: <input type="checkbox"/> sharp <input type="checkbox"/> diffuse <input type="checkbox"/> commingled <input type="checkbox"/> other (specify)							
For cuts complete this section: Cut edges: <input type="checkbox"/> rounded <input type="checkbox"/> straight Cut sides: <input type="checkbox"/> straight <input type="checkbox"/> concave <input type="checkbox"/> convex <input type="checkbox"/> sloping Cut bottom: <input type="checkbox"/> flat <input type="checkbox"/> concave <input type="checkbox"/> irregular How is cut top edge? <input type="checkbox"/> sharp <input type="checkbox"/> rounded How is cut bottom edge? <input type="checkbox"/> sharp <input type="checkbox"/> rounded Observations:				Sketch for layers and/or cuts (indicate North): 			

For structural remains complete this section

Alignment:

Building Technique: Adobe/Mud-brick Ashlar (blocks) irregular (unworked) stone Concrete Other (specify)

Binding Agent: None Clay Mortar (if so, specify composition, color, compaction)

Concrete inclusions:

Material: Tufo Basalt Travertine Tiles Other (specify)
Size: Small (range) _____ Medium (range) 20x30 Large (range) _____ Representative size: e.g. 2 x 1 x 2 cm

Wall Facing: *there is just one course of the facade preserved, therefore facing is not preserved anymore*
 Opus quadratum Opus incertum Opus reticulatum Petit appareil Opus testaceum Opus mixtum Opus vittatum Other (specify)

Complete this section for foundations Faced foundation Wooden shuttering No shuttering

Floor/revetment type

Floor type: Beaten Earth Opus signinum Opus scutulatum Opus Sectile Mosaic Opus spicatum Other (specify)

Wall finishing Stucco Opus signinum Plaster Painted Plaster Other (specify)

Approx. length, width, height of structural remains: *length: 1m; width: 0,35m; height: 0,08m*

Description: *remains of a built feature from one or two rounded slopes of travertine and a rather square block of local tufo, beneath the stones, there is a little cut in the bedrock*

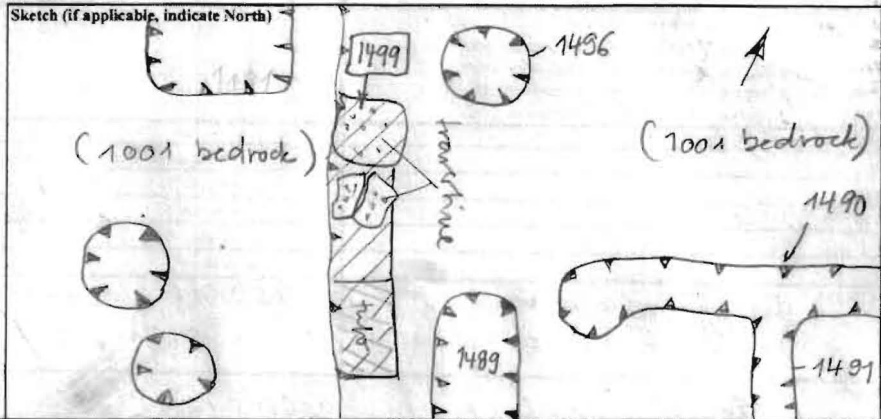

INTERPRETATION

*remains of a built feature near the cistern (SU 1153). This built feature is situated in the corner behind the drainage channels which feed the cistern SU. Beneath the masonry of feature SU 1499 there is a little cut in the bedrock, probably **

SOIL SAMPLING: Yes No

Total volume of layer (buckets):

Sample quantity (buckets):

Sample fraction (%):

NON SOIL SAMPLES: Yes No

If yes, specify (e.g. charcoal, mortar etc.):

Size:

SIEVING: Yes No

Total volume of layer (buckets):

Sample quantity (buckets):

Sample fraction (%):

STRATIGRAPHICAL RELIABILITY

Good Fair Poor

Filled-out by	<i>CMH</i>	on	<i>19.6.2012</i>
Revised by	<i>CMH</i>	on	<i>19.6.2012</i>
PDFd by		on	
Entered by		on	

** serving a kind of drainage function for the masonry.*