

SITE	YEAR	AREA	SECTOR	ELEVATION	STRATIGRAPHICAL UNIT	University of Michigan History Museum of Archaeology Gabbii Project 14 JULY 09	
GPR	2009	A		Min: 64.4741 Max: 64.5795	195 <input checked="" type="checkbox"/> Natural <input type="checkbox"/> Anthropic		
In cross-section? <input type="checkbox"/> Yes <input checked="" type="checkbox"/> No			In elevation drawing? <input type="checkbox"/> Yes <input checked="" type="checkbox"/> No		Photos: <input checked="" type="checkbox"/> Yes <input type="checkbox"/> No #: 347-348		Photo Model: <input type="checkbox"/> Yes <input checked="" type="checkbox"/> No #:
DEFINITION Layer of Silty SAND INSU 184					Covered by <input checked="" type="checkbox"/> SU: 183	Fills <input checked="" type="checkbox"/> SU: 184	Filled by <input type="checkbox"/> SU:
HOW IS LAYER DISTINGUISHED? <input checked="" type="checkbox"/> Color <input checked="" type="checkbox"/> Composition <input checked="" type="checkbox"/> Compaction			FORMATION PROCESS <input checked="" type="checkbox"/> Accumulation <input type="checkbox"/> Construction <input type="checkbox"/> Cutting <input type="checkbox"/> Erosion <input type="checkbox"/> Collapse <input type="checkbox"/> Intentional deposition				
INCLUSIONS For each inclusion specify frequency: (f)requent, (m)edium, (r)are					SOIL/MATRIX		
Anthropic		Geological		Organic	clay % silt 40% sand 60%		
<input checked="" type="checkbox"/> Pottery R <input type="checkbox"/> Tiles <input type="checkbox"/> Amphorae <input type="checkbox"/> Dolia <input type="checkbox"/> Mosaic tile(s) <input type="checkbox"/> Mortar <input type="checkbox"/> Coins <input type="checkbox"/> Metal (specify) <input type="checkbox"/> Collapse debris <input type="checkbox"/> Glass		<input checked="" type="checkbox"/> Tufo (specify) 99% 20 f <input type="checkbox"/> Travertine <input type="checkbox"/> Other Limestone <input type="checkbox"/> Basalt <input type="checkbox"/> Clay <input type="checkbox"/> Sand <input type="checkbox"/> Silt <input type="checkbox"/> Pebbles (range) <input type="checkbox"/> Gravel (range)		<input type="checkbox"/> Charcoal <input type="checkbox"/> Ash <input type="checkbox"/> Animal bones <input type="checkbox"/> Human bones <input type="checkbox"/> Animal teeth <input type="checkbox"/> Human teeth <input type="checkbox"/> Shells <input type="checkbox"/> Other (specify)	<input checked="" type="checkbox"/> Granular <input type="checkbox"/> Layered <input type="checkbox"/> Cohesive		
					Compaction		Color
					<input type="checkbox"/> Hard <input checked="" type="checkbox"/> Compact <input type="checkbox"/> Friable <input type="checkbox"/> Loose <input type="checkbox"/> Soft		<input type="checkbox"/> Black <input type="checkbox"/> Brown <input type="checkbox"/> Gray <input checked="" type="checkbox"/> Light Brown <input type="checkbox"/> Light Gray <input type="checkbox"/> White <input type="checkbox"/> Yellow <input type="checkbox"/> Red <input type="checkbox"/> Light Yellow <input type="checkbox"/> Other (specify)
UNIT LIMITS (also indicate on overlay)							
Northern Limit <input checked="" type="checkbox"/> Original <input type="checkbox"/> Not Original <input type="checkbox"/> Excavation Limit				Depth: <input checked="" type="checkbox"/> Original <input type="checkbox"/> Not Original			
Southern Limit <input checked="" type="checkbox"/> Original <input type="checkbox"/> Not Original <input type="checkbox"/> Excavation Limit							
Western Limit <input checked="" type="checkbox"/> Original <input type="checkbox"/> Not Original <input type="checkbox"/> Excavation Limit							
Eastern Limit <input checked="" type="checkbox"/> Original <input type="checkbox"/> Not Original <input type="checkbox"/> Excavation Limit							
STRATIGRAPHICAL SEQUENCE							
Is equal to: 183				Is bound to (only for masonry):			
Is abutted by:				Abuts:			
Is covered by: 183				Covers:			
Is cut by:				Cuts:			
Is filled by:				Fills: 184			
OBSERVATIONS							
DUG BY PICK AND SHOVEL				SU 195 IS AN ARBITRARY DISTINCTION IN THE FILL MATERIAL, BUT IS THE SAME AS SU 183 FILL MATERIAL			
SOME IRREGULAR CHUNKS OF TUFO CLUSTERED IN NORTHEAST.							
DESCRIPTION							
Position within sector: Area A - central - South East of BU 90							
Shape: rectangular							
For layers complete this section:							
Surface (slope direction; visible inclusions): Slight slope to East - several rocky inclusions - cluster in North East							
Observations about inclusions (Clusters? Deposition slope): tufo clusters in North East corner							
Observations about thickness (Increases? Decreases?): EVEN THICKNESS							
Nature of the interface with layer below: <input checked="" type="checkbox"/> sharp <input type="checkbox"/> diffuse <input type="checkbox"/> commingled <input type="checkbox"/> other (specify)							
For cuts complete this section:				Sketch for layers and/or cuts (indicate North):			
Cut edges: <input type="checkbox"/> rounded <input type="checkbox"/> straight							
Cut sides: <input type="checkbox"/> straight <input type="checkbox"/> concave <input type="checkbox"/> convex <input type="checkbox"/> sloping							
Cut bottom: <input type="checkbox"/> flat <input type="checkbox"/> concave <input type="checkbox"/> irregular							
How is cut top edge? <input type="checkbox"/> sharp <input type="checkbox"/> rounded							
How is cut bottom edge? <input type="checkbox"/> sharp <input type="checkbox"/> rounded							
Observations:							

For structural remains complete this section

Alignment: _____

Building Technique: Adobe/Mud-brick Ashlar (blocks) irregular (unworked) stone Concrete Other (specify) _____

Binding Agent: None Clay Mortar (if so, specify composition, color, compaction) _____

Concrete inclusions:

Material Tufo Basalt Travertine Tiles Other (specify) _____

Size Small (range) _____ Medium (range) _____ Large (range) _____ Representative size: e.g. 2 x 1 x 2 cmz

Wall Facing:

Opus quadratum Opus incertum Opus reticulatum Petit appareil Opus testaceum Opus mixtum Opus vittatum Other (specify) _____

Complete this section for foundations Faced foundation Wooden shuttering No shuttering

floor/revetment type

Floor type: Beaten Earth Opus signinum Opus scutulatum Opus Sectile Mosaic Opus spicatum Other (specify) _____

Wall finishing Stucco Opus signinum Plaster Painted Plaster Other (specify) _____

Approx. length, width, height of structural remains:

Description:

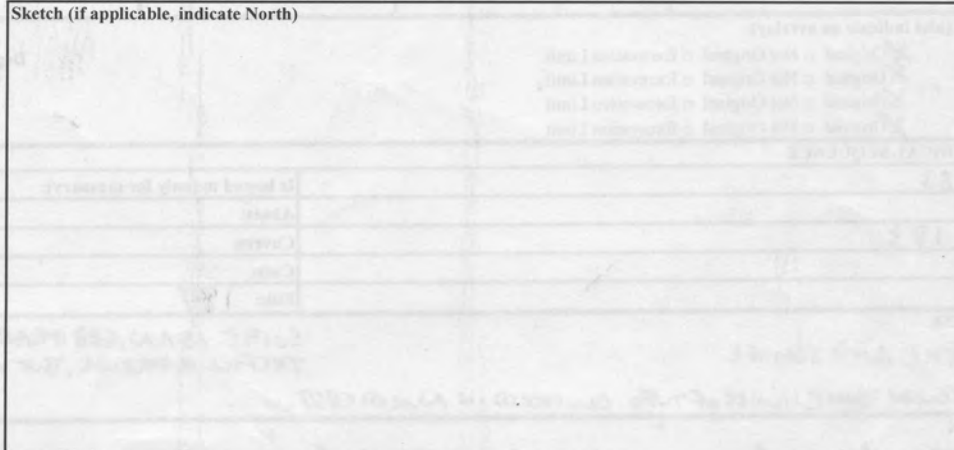

INTERPRETATION

Layer of washed in accumulation and sediment, possibly several larger chunks of rock and rubble were waste from the quarry. IN CUT 50184

<p>SOIL SAMPLING: <input type="checkbox"/> Yes <input checked="" type="checkbox"/> No</p> <p>Total volume of layer (buckets): _____</p> <p>Sample quantity (buckets): _____</p> <p>Sample fraction (%): _____</p>	<p>NON SOIL SAMPLES: <input type="checkbox"/> Yes <input checked="" type="checkbox"/> No</p> <p>If yes, specify (e.g. charcoal, mortar etc.): _____</p> <p>Size: _____</p>	<p>SIEVING: <input type="checkbox"/> Yes <input checked="" type="checkbox"/> No</p> <p>Total volume of layer (buckets): _____</p> <p>Sample quantity (buckets): _____</p> <p>Sample fraction (%): _____</p>
--	---	--

<p>STRATIGRAPHICAL RELIABILITY</p> <p><input checked="" type="checkbox"/> Good <input type="checkbox"/> Fair <input type="checkbox"/> Poor</p>	Filled-out by <i>Cathy Cheney</i>	on <i>15 Jul. 09</i>
	Revised by _____	on _____
	PDFd by _____	on _____
	Entered by _____	on _____