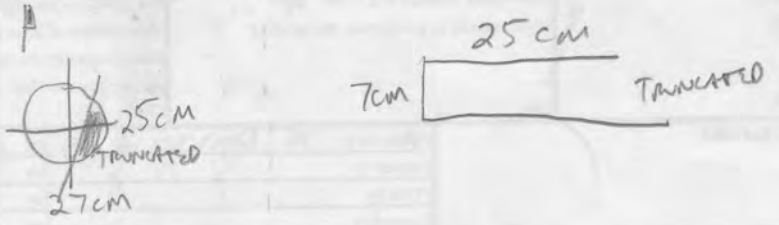

SITE	YEAR	AREA	SECTOR	ELEVATION Min: 64.470 Max: 64.459	STRATIGRAPHICAL UNIT 197	 University of Stuttgart Institute of Archaeology Gabii Project 14 JULY 09
GPR	2009	A			<input checked="" type="checkbox"/> Natural <input type="checkbox"/> Anthropic	
In cross-section? <input type="checkbox"/> Yes <input checked="" type="checkbox"/> No			In elevation drawing? <input type="checkbox"/> Yes <input checked="" type="checkbox"/> No		Photos: <input checked="" type="checkbox"/> Yes <input type="checkbox"/> No #: 353-356	Photo Model: <input type="checkbox"/> Yes <input checked="" type="checkbox"/> No #:
DEFINITION LAYER OF Sandy silt IN CUT SU 196			Covered by <input type="checkbox"/> SU: 0		Fills <input type="checkbox"/> SU: 196	Filled by <input type="checkbox"/> SU:
HOW IS LAYER DISTINGUISHED? <input checked="" type="checkbox"/> Color <input checked="" type="checkbox"/> Composition <input type="checkbox"/> Compaction			FORMATION PROCESS <input checked="" type="checkbox"/> Accumulation <input type="checkbox"/> Construction <input type="checkbox"/> Cutting <input type="checkbox"/> Erosion <input type="checkbox"/> Collapse <input type="checkbox"/> Intentional deposition			
INCLUSIONS For each inclusion specify frequency: (f)requent, (m)edium, (r)are					SOIL/MATRIX clay ___% silt 80% sand 20% <input checked="" type="checkbox"/> Granular <input type="checkbox"/> Layered <input type="checkbox"/> Cohesive	
Anthropic		Geological		Organic		
<input type="checkbox"/> Pottery <input type="checkbox"/> Tiles <input type="checkbox"/> Amphorae <input type="checkbox"/> Dolia <input type="checkbox"/> Mosaic tile(s) <input type="checkbox"/> Mortar <input type="checkbox"/> Coins <input type="checkbox"/> Metal (specify) <input type="checkbox"/> Collapse debris <input type="checkbox"/> Glass		<input checked="" type="checkbox"/> Tufo (specify) F <input type="checkbox"/> Travertine <input type="checkbox"/> Other Limestone <input type="checkbox"/> Basalt <input type="checkbox"/> Clay <input type="checkbox"/> Sand <input type="checkbox"/> Silt <input type="checkbox"/> Pebbles (range) <input type="checkbox"/> Gravel (range)		<input type="checkbox"/> Charcoal <input type="checkbox"/> Ash <input type="checkbox"/> Animal bones <input type="checkbox"/> Human bones <input type="checkbox"/> Animal teeth <input type="checkbox"/> Human teeth <input type="checkbox"/> Shells <input checked="" type="checkbox"/> Other (specify) None		
				Compaction: <input type="checkbox"/> Hard <input type="checkbox"/> Compact <input checked="" type="checkbox"/> Friable <input type="checkbox"/> Loose <input type="checkbox"/> Soft Color: <input type="checkbox"/> Black <input type="checkbox"/> Brown <input type="checkbox"/> Gray <input checked="" type="checkbox"/> Light Brown <input type="checkbox"/> Light Gray <input type="checkbox"/> White <input type="checkbox"/> Yellow <input type="checkbox"/> Red <input type="checkbox"/> Light Yellow <input type="checkbox"/> Other (specify)		
UNIT LIMITS (also indicate on overlay)						Depth: <input type="checkbox"/> Original <input checked="" type="checkbox"/> Not Original
Northern Limit <input checked="" type="checkbox"/> Original <input type="checkbox"/> Not Original <input type="checkbox"/> Excavation Limit						
Southern Limit <input checked="" type="checkbox"/> Original <input type="checkbox"/> Not Original <input type="checkbox"/> Excavation Limit						
Western Limit <input checked="" type="checkbox"/> Original <input type="checkbox"/> Not Original <input type="checkbox"/> Excavation Limit						
Eastern Limit <input type="checkbox"/> Original <input checked="" type="checkbox"/> Not Original <input type="checkbox"/> Excavation Limit						
STRATIGRAPHICAL SEQUENCE						
Is equal to:			Is bound to (only for masonry):			
Is abutted by:			Abuts:			
Is covered by: 0			Covers:			
Is cut by: 2			Cuts:			
Is filled by:			Fills: 196			
OBSERVATIONS EASTERN LIMIT TRUNCATED BY PLOWING (HAND TROWELLED) no anthropogenic material - fill of eroded soil & bedrock						
DESCRIPTION Position within sector: CENTRAL AREA SOUTH OF CUT SU 184 Shape: CIRCULAR						
For layers complete this section:						
Surface (slope direction; visible inclusions): even slope						
Observations about inclusions (Clusters? Deposition slope): small-medium tufo inclusions						
Observations about thickness (Increases? Decreases?): same throughout						
Nature of the interface with layer below: <input checked="" type="checkbox"/> sharp <input type="checkbox"/> diffuse <input type="checkbox"/> commigled <input type="checkbox"/> other (specify)						
For cuts complete this section:			Sketch for layers and/or cuts (indicate North):			
Cut edges: <input type="checkbox"/> rounded <input type="checkbox"/> straight						
Cut sides: <input type="checkbox"/> straight <input type="checkbox"/> concave <input type="checkbox"/> convex <input type="checkbox"/> sloping						
Cut bottom: <input type="checkbox"/> flat <input type="checkbox"/> concave <input type="checkbox"/> irregular						
How is cut top edge? <input type="checkbox"/> sharp <input type="checkbox"/> rounded						
How is cut bottom edge? <input type="checkbox"/> sharp <input type="checkbox"/> rounded						
Observations:						

For structural remains complete this section

Alignment:

Building Technique: Adobe/Mud-brick Ashlar (blocks) irregular (unworked) stone Concrete Other (specify)

Binding Agent: None Clay Mortar (if so, specify composition, color, compaction)

Concrete inclusions:

Material Tufo Basalt Travertine Tiles Other (specify)

Size Small (range) _____ Medium (range) _____ Large (range) _____ Representative size: e.g. 2 x 1 x 2 cmz

Wall Facing:

Opus quadratum Opus incertum Opus reticulatum Petit appareil Opus testaceum Opus mixtum Opus vittatum Other (specify)

Complete this section for foundations Faced foundation Wooden shuttering No shuttering

floor/revetment type

Floor type: Beaten Earth Opus signinum Opus scutulatum Opus Sectile Mosaic Opus spicatum Other (specify)

Wall finishing Stucco Opus signinum Plaster Painted Plaster Other (specify)

Approx. length, width, height of structural remains:

Description:

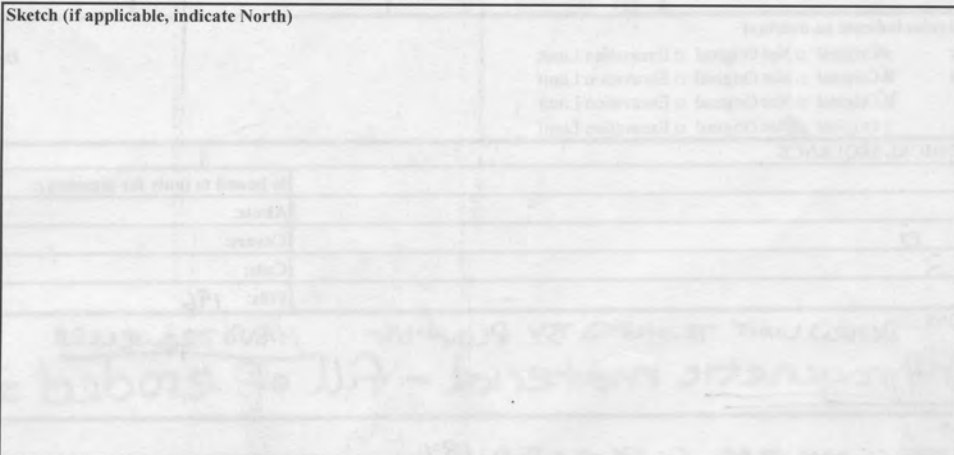

INTERPRETATION

Shallow fill amount in cut, granular eroded material that formed a sediment in Cut 196

SOIL SAMPLING: <input type="checkbox"/> Yes <input checked="" type="checkbox"/> No Total volume of layer (buckets): Sample quantity (buckets): Sample fraction (%):	NON SOIL SAMPLES: <input type="checkbox"/> Yes <input checked="" type="checkbox"/> No If yes, specify (e.g. charcoal, mortar etc.): Size:	SIEVING: <input type="checkbox"/> Yes <input checked="" type="checkbox"/> No Total volume of layer (buckets): Sample quantity (buckets): Sample fraction (%):
---	--	---

STRATIGRAPHICAL RELIABILITY <input checked="" type="checkbox"/> Good <input type="checkbox"/> Fair <input type="checkbox"/> Poor	Filled-out by K Davio	on 15 July 09
	Revised by	on
	PDFd by	on
	Entered by	on