

SITE GPR	YEAR 2009	AREA C	SECTOR	ELEVATION Min: 62.26 Max: 62.63	STRATIGRAPHICAL UNIT 2054 <input type="checkbox"/> Natural <input checked="" type="checkbox"/> Anthropic
-------------	--------------	-----------	--------	---------------------------------------	--

In cross-section? Yes No In elevation drawing? Yes No Photos: Yes No # 162 Photo Model: Yes No #:

DEFINITION
WALL OF IRREGULAR STONES

Covered by SU: 1000, 2017 Fills SU: Filled by SU:

HOW IS LAYER DISTINGUISHED?
 Color Composition Compaction

FORMATION PROCESS
 Accumulation Construction Cutting Erosion Collapse Intentional deposition

INCLUSIONS For each inclusion specify frequency: (f)requent, (m)edium, (r)are

Anthropic	Geological	Organic	SOIL/MATRIX				
<input type="checkbox"/> Pottery <input type="checkbox"/> Tiles <input type="checkbox"/> Amphorae <input type="checkbox"/> Dolia <input type="checkbox"/> Mosaic tile(s) <input type="checkbox"/> Mortar <input type="checkbox"/> Coins <input type="checkbox"/> Metal (specify) <input type="checkbox"/> Collapse debris <input type="checkbox"/> Glass	<input type="checkbox"/> Nails <input type="checkbox"/> Marble <input type="checkbox"/> Quarried debris <input type="checkbox"/> Slag <input type="checkbox"/> Brick <input type="checkbox"/> Basalt slabs <input type="checkbox"/> Opus signinum <input type="checkbox"/> Painted plaster <input type="checkbox"/> Burnt Adobe <input type="checkbox"/> Other (specify)	<input type="checkbox"/> Tufo (specify) <input type="checkbox"/> Travertine <input type="checkbox"/> Other Limestone <input type="checkbox"/> Basalt <input type="checkbox"/> Clay <input type="checkbox"/> Sand <input type="checkbox"/> Silt <input type="checkbox"/> Pebbles (range) <input type="checkbox"/> Gravel (range)	clay ___% silt ___% sand ___% <input type="checkbox"/> Granular <input type="checkbox"/> Layered <input type="checkbox"/> Cohesive <table border="1"> <tr> <td>Compaction</td> <td>Color</td> </tr> <tr> <td> <input type="checkbox"/> Hard <input type="checkbox"/> Compact <input type="checkbox"/> Friable <input type="checkbox"/> Loose <input type="checkbox"/> Soft </td> <td> <input type="checkbox"/> Black <input type="checkbox"/> Brown <input type="checkbox"/> Gray <input type="checkbox"/> Light Brown <input type="checkbox"/> Light Gray <input type="checkbox"/> White <input type="checkbox"/> Yellow <input type="checkbox"/> Red <input type="checkbox"/> Light Yellow <input type="checkbox"/> Other (specify) </td> </tr> </table>	Compaction	Color	<input type="checkbox"/> Hard <input type="checkbox"/> Compact <input type="checkbox"/> Friable <input type="checkbox"/> Loose <input type="checkbox"/> Soft	<input type="checkbox"/> Black <input type="checkbox"/> Brown <input type="checkbox"/> Gray <input type="checkbox"/> Light Brown <input type="checkbox"/> Light Gray <input type="checkbox"/> White <input type="checkbox"/> Yellow <input type="checkbox"/> Red <input type="checkbox"/> Light Yellow <input type="checkbox"/> Other (specify)
Compaction	Color						
<input type="checkbox"/> Hard <input type="checkbox"/> Compact <input type="checkbox"/> Friable <input type="checkbox"/> Loose <input type="checkbox"/> Soft	<input type="checkbox"/> Black <input type="checkbox"/> Brown <input type="checkbox"/> Gray <input type="checkbox"/> Light Brown <input type="checkbox"/> Light Gray <input type="checkbox"/> White <input type="checkbox"/> Yellow <input type="checkbox"/> Red <input type="checkbox"/> Light Yellow <input type="checkbox"/> Other (specify)						

UNIT LIMITS (also indicate on overlay)

Northern Limit Original Not Original Excavation Limit Depth: Original Not Original

Southern Limit Original Not Original Excavation Limit

Western Limit Original Not Original Excavation Limit

Eastern Limit Original Not Original Excavation Limit

STRATIGRAPHICAL SEQUENCE

Is equal to:	Is bound to (only for masonry): 2055
Is abutted by: 2041, 2057, 2005,	Abuts:
Is covered by: 2000, 2017,	Covers:
Is cut by:	Cuts:
Is filled by:	Fills:

OBSERVATIONS

DESCRIPTION

Position within sector: East central

Shape: irregular rectangle

For layers complete this section:

Surface (slope direction; visible inclusions):

Observations about inclusions (Clusters? Deposition slope):

Observations about thickness (Increases? Decreases?):

Nature of the interface with layer below: sharp diffuse commingled other (specify)

<p>For cuts complete this section:</p> <p>Cut edges: <input type="checkbox"/> rounded <input type="checkbox"/> straight</p> <p>Cut sides <input type="checkbox"/> straight <input type="checkbox"/> concave <input type="checkbox"/> convex <input type="checkbox"/> sloping</p> <p>Cut bottom: <input type="checkbox"/> flat <input type="checkbox"/> concave <input type="checkbox"/> irregular</p> <p>How is cut top edge? <input type="checkbox"/> sharp <input type="checkbox"/> rounded</p> <p>How is cut bottom edge? <input type="checkbox"/> sharp <input type="checkbox"/> rounded</p> <p>Observations:</p>	<p>Sketch for layers and/or cuts (indicate North):</p>
---	--

For structural remains complete this section

Alignment: *North/South*

Building Technique: Adobe/Mud-brick Ashlar (blocks) Irregular (unworked) stone Concrete Other (specify)

Binding Agent: None Clay Mortar (if so, specify composition, color, compaction)

Concrete inclusions:

Material: Tufo Basalt Travertine Tiles Other (specify)
 Size: Small (range) _____ Medium (range) _____ Large (range) _____ Representative size: e.g. 2 x 1 x 2 cmz

Wall Facing:

Opus quadratum Opus incertum Opus reticulatum Petit appareil Opus testaceum Opus mixtum Opus vittatum Other (specify)

Complete this section for foundations Faced foundation Wooden shuttering No shuttering

Floor/revetment type

Floor type: Beaten Earth Opus signinum Opus scutulatum Opus Sectile Mosaic Opus spicatum Other (specify)

Wall finishing: Stucco Opus signinum Plaster Painted Plaster Other (specify)

Approx. length, width, height of structural remains: *l ≈ 2.88m, w ≈ 50cm, h ≈ 40cm*

Description:
North/South running wall of irregular stones of basalt, travertine, & tufo. Southern limit does not appear original. Travertine blocks appear to be on a lower course than the basalt above.

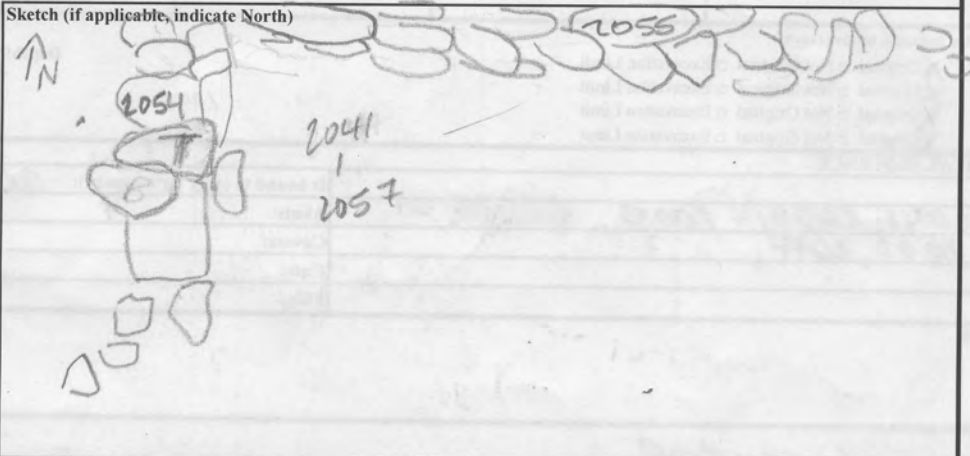

INTERPRETATION *Wall forming part of probable production area in NE portion of Area C*

<p>SOIL SAMPLING: <input type="checkbox"/> Yes <input checked="" type="checkbox"/> No Total volume of layer (buckets): Sample quantity (buckets): Sample fraction (%):</p>	<p>NON SOIL SAMPLES: <input type="checkbox"/> Yes <input checked="" type="checkbox"/> No If yes, specify (e.g. charcoal, mortar etc.): Size:</p>	<p>SIEVING: <input type="checkbox"/> Yes <input checked="" type="checkbox"/> No Total volume of layer (buckets): Sample quantity (buckets): Sample fraction (%):</p>
<p>STRATIGRAPHICAL RELIABILITY Good <input type="checkbox"/> Fair <input type="checkbox"/> Poor</p>		
<p>Filled-out by <i>NGM</i> on <i>23/7/09</i></p>		<p>Revised by <i>SZ/IFC</i> on <i>29/9/2009</i></p>
<p>PDFd by _____ on _____</p>		<p>Entered by _____ on _____</p>