

SITE	YEAR	AREA	SECTOR	ELEVATION	STRATIGRAPHICAL UNIT	
GPR	2010	C		Min: 61.3212 Max: 62.0292	2177 Natural <input type="checkbox"/> Anthropic <input type="checkbox"/>	

In cross-section? <input type="checkbox"/> Yes <input checked="" type="checkbox"/> No	In elevation drawing? <input type="checkbox"/> Yes <input checked="" type="checkbox"/> No	Photos: <input checked="" type="checkbox"/> Yes <input type="checkbox"/> No #: 1980-1988	Photo Model: <input type="checkbox"/> Yes <input checked="" type="checkbox"/> No #:
---	---	--	---

DEFINITION	Covered by	Fills	Filled by
LAYER OF BRN SILT IN SOUTH CENTRAL PART OF AREA	SU: 2137	SU:	SU:

HOW IS LAYER DISTINGUISHED?	FORMATION PROCESS
<input type="checkbox"/> Color <input type="checkbox"/> Composition <input checked="" type="checkbox"/> Compaction	<input checked="" type="checkbox"/> Accumulation <input type="checkbox"/> Construction <input type="checkbox"/> Cutting <input type="checkbox"/> Erosion <input type="checkbox"/> Collapse <input type="checkbox"/> Intentional deposition

INCLUSIONS For each inclusion specify frequency: (f)requent, (m)edium, (r)are			SOIL/MATRIX				
Anthropic	Geological	Organic	clay 10% silt 90% sand -% <input checked="" type="checkbox"/> Granular <input type="checkbox"/> Layered <input type="checkbox"/> Cohesive				
<input checked="" type="checkbox"/> Pottery M <input type="checkbox"/> Nails R <input checked="" type="checkbox"/> Tiles R <input type="checkbox"/> Marble <input checked="" type="checkbox"/> Amphorae R <input type="checkbox"/> Quarried debris <input type="checkbox"/> Dolia <input type="checkbox"/> Slag <input type="checkbox"/> Brick <input checked="" type="checkbox"/> Mosaic tile(s) R <input type="checkbox"/> Basalt slabs <input type="checkbox"/> Mortar <input type="checkbox"/> Opus signinum <input checked="" type="checkbox"/> Coins R <input type="checkbox"/> Painted plaster <input checked="" type="checkbox"/> Metal (specify) R <input type="checkbox"/> Burnt Adobe <input type="checkbox"/> Collapse debris <input type="checkbox"/> Other (specify) <input type="checkbox"/> Glass	<input checked="" type="checkbox"/> Tufo (specify) R <input type="checkbox"/> Travertine <input type="checkbox"/> Other Limestone <input type="checkbox"/> Basalt <input type="checkbox"/> Clay <input type="checkbox"/> Sand <input type="checkbox"/> Silt <input type="checkbox"/> Pebbles (range) <input type="checkbox"/> Gravel (range)	<input type="checkbox"/> Charcoal <input type="checkbox"/> Ash <input checked="" type="checkbox"/> Animal bones R <input type="checkbox"/> Human bones <input checked="" type="checkbox"/> Animal teeth R <input type="checkbox"/> Human teeth <input type="checkbox"/> Shells <input type="checkbox"/> Other (specify)	<table border="1"> <tr> <td>Compaction</td> <td>Color</td> </tr> <tr> <td> <input type="checkbox"/> Hard <input type="checkbox"/> Compact <input type="checkbox"/> Friable <input type="checkbox"/> Loose <input type="checkbox"/> Soft </td> <td> <input type="checkbox"/> Black <input type="checkbox"/> Brown <input type="checkbox"/> Gray <input type="checkbox"/> Light Brown <input type="checkbox"/> Light Gray <input type="checkbox"/> White <input type="checkbox"/> Yellow <input type="checkbox"/> Red <input type="checkbox"/> Light Yellow <input type="checkbox"/> Other (specify) </td> </tr> </table>	Compaction	Color	<input type="checkbox"/> Hard <input type="checkbox"/> Compact <input type="checkbox"/> Friable <input type="checkbox"/> Loose <input type="checkbox"/> Soft	<input type="checkbox"/> Black <input type="checkbox"/> Brown <input type="checkbox"/> Gray <input type="checkbox"/> Light Brown <input type="checkbox"/> Light Gray <input type="checkbox"/> White <input type="checkbox"/> Yellow <input type="checkbox"/> Red <input type="checkbox"/> Light Yellow <input type="checkbox"/> Other (specify)
Compaction	Color						
<input type="checkbox"/> Hard <input type="checkbox"/> Compact <input type="checkbox"/> Friable <input type="checkbox"/> Loose <input type="checkbox"/> Soft	<input type="checkbox"/> Black <input type="checkbox"/> Brown <input type="checkbox"/> Gray <input type="checkbox"/> Light Brown <input type="checkbox"/> Light Gray <input type="checkbox"/> White <input type="checkbox"/> Yellow <input type="checkbox"/> Red <input type="checkbox"/> Light Yellow <input type="checkbox"/> Other (specify)						

UNIT LIMITS (also indicate on overlay)	Depth: <input checked="" type="checkbox"/> Original <input type="checkbox"/> Not Original
Northern Limit <input checked="" type="checkbox"/> Original <input type="checkbox"/> Not Original <input type="checkbox"/> Excavation Limit Southern Limit <input type="checkbox"/> Original <input type="checkbox"/> Not Original <input checked="" type="checkbox"/> Excavation Limit Western Limit <input checked="" type="checkbox"/> Original <input type="checkbox"/> Not Original <input type="checkbox"/> Excavation Limit Eastern Limit <input type="checkbox"/> Original <input type="checkbox"/> Not Original <input checked="" type="checkbox"/> Excavation Limit	

STRATIGRAPHICAL SEQUENCE	
Is equal to:	Is bound to (only for masonry):
Is abutted by:	Abuts: 2186, 2187, 2203
Is covered by: 2137	Covers: 2204, 2202, 2208, 2214, 2207
Is cut by:	Cuts:
Is filled by:	Fills:

OBSERVATIONS: LAYER UNCOVERED ON 2/17/10

DESCRIPTION

Position within sector: SOUTH CENTRAL PART OF AREA

Shape: SU CONTAINS LIMITS THAT ARE NOT ORIGINAL

For layers complete this section:

Surface (slope direction: visible inclusions): SLIGHT SLOPE FROM NORTHWEST TO SOUTHEAST; FEW TUFO INCLUSIONS

Observations about inclusions (Clusters? Deposition slope): NO DISCERNABLE CLUSTERS

Observations about thickness (Increases? Decreases?): THICKNESS INCREASES SLIGHTLY FROM N TO S THROUGHOUT EXTENT OF SU AND MARKEDLY FROM W TO E TOWARD THE W EDGE OF THE SU

Nature of the interface with layer below: sharp diffuse conflagled other (specify)

For cuts complete this section:

Cut edges: rounded straight

Cut sides: straight concave convex sloping

Cut bottom: flat concave irregular

How is cut top edge? sharp rounded

How is cut bottom edge? sharp rounded

Observations:

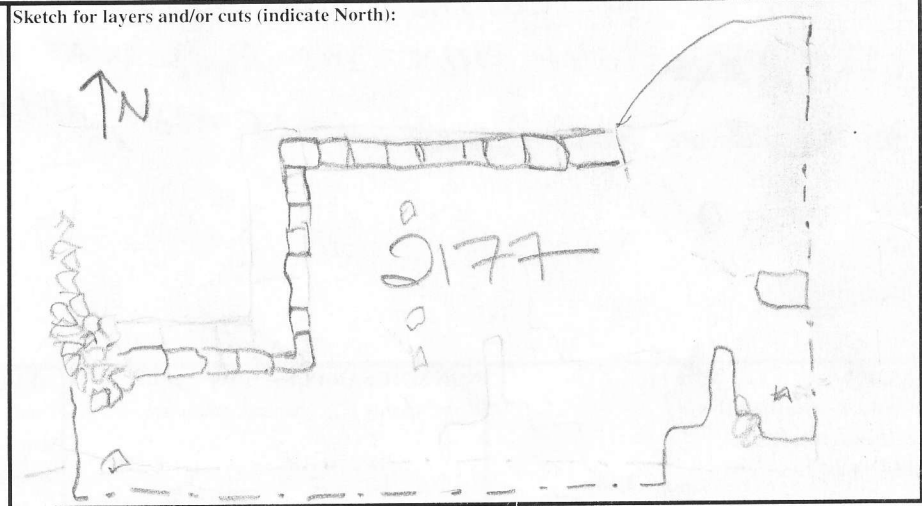

For structural remains complete this section

Alignment:

Building Technique: Adobe/Mud-brick Ashlar (blocks) irregular (unworked) stone Concrete Other (specify)

Binding Agent: None Clay Mortar (if so, specify composition, color, compaction)

Concrete inclusions:

Material Tufo Basalt Travertine Tiles Other (specify)

Size Small (range) _____ Medium (range) _____ Large (range) _____ Representative size: e.g. 2 x 1 x 2 cmz

Wall Facing:

Opus quadratum Opus incertum Opus reticulatum Petit appareil Opus testaceum Opus mixtum Opus vittatum Other (specify)

Complete this section for foundations Faced foundation Wooden shuttering No shuttering

floor/revetment type

Floor type: Beaten Earth Opus signinum Opus scutulatum Opus Sectile Mosaic Opus spicatum Other (specify)

Wall finishing Stucco Opus signinum Plaster Painted Plaster Other (specify)

Approx. length, width, height of structural remains:

Description:

Sketch (if applicable, indicate North)

INTERPRETATION

THE SU COVERS THE FILL (SU 2207) OF A MODERN TRENCH (SU 2206). THE EDGES OF THE CUT, HOWEVER WERE NOT VISIBLE WITHIN SU 2177, SUGGESTING THAT THE LAYER WAS HEAVILY DISTURBED, PROBABLY BY THE USE OF DEEP PLOWS IN THIS AREA, AFTER SU 2206 WAS CUT

SOIL SAMPLING: Yes No

Total volume of layer (buckets):

Sample quantity (buckets):

Sample fraction (%):

NON SOIL SAMPLES: Yes No

If yes, specify (e.g. charcoal, mortar etc.):

Size:

SIEVING: Yes No

Total volume of layer (buckets):

Sample quantity (buckets):

Sample fraction (%):

STRATIGRAPHICAL RELIABILITY

Good Fair Poor

Filled-out by	IFC	on	21/07/2010
Revised by	JS	on	30/7/2010
PDFd by	JJM	on	30.07.2010
Entered by		on	