

SITE GPR	YEAR 2009	AREA A	SECTOR	ELEVATION Min: 64.28 Max: 64.28	STRATIGRAPHICAL UNIT 221 <input type="checkbox"/> Natural <input checked="" type="checkbox"/> Anthropic	 University of Manitoba History Museum of Archaeology Gabii Project 16 July 09
-------------	--------------	-----------	--------	---------------------------------------	--	--

In cross-section? <input type="checkbox"/> Yes <input checked="" type="checkbox"/> No	In elevation drawing? <input type="checkbox"/> Yes <input checked="" type="checkbox"/> No	Photos: <input checked="" type="checkbox"/> Yes <input type="checkbox"/> No #: 416-417	Photo Model: <input type="checkbox"/> Yes <input checked="" type="checkbox"/> No #:
---	---	--	---

DEFINITION CIRCULAR CUT IN TUFO EAST OF HUT	Covered by <input type="checkbox"/> SU:	Fills <input type="checkbox"/> SU:	Filed by <input type="checkbox"/> SU: 222
--	--	---------------------------------------	--

HOW IS LAYER DISTINGUISHED? <input type="checkbox"/> Color <input type="checkbox"/> Composition <input type="checkbox"/> Compaction	FORMATION PROCESS <input type="checkbox"/> Accumulation <input type="checkbox"/> Construction <input checked="" type="checkbox"/> Cutting <input type="checkbox"/> Erosion <input type="checkbox"/> Collapse <input type="checkbox"/> Intentional deposition
--	---

INCLUSIONS For each inclusion specify frequency: (f)requent, (m)edium, (r)are			SOIL/MATRIX clay ___% silt ___% sand ___%
Anthropic	Geological	Organic	<input type="checkbox"/> Granular <input type="checkbox"/> Layered <input type="checkbox"/> Cohesive
<input type="checkbox"/> Pottery <input type="checkbox"/> Tiles <input type="checkbox"/> Amphorae <input type="checkbox"/> Dolia <input type="checkbox"/> Mosaic tile(s) <input type="checkbox"/> Mortar <input type="checkbox"/> Coins <input type="checkbox"/> Metal (specify) <input type="checkbox"/> Collapse debris <input type="checkbox"/> Glass	<input type="checkbox"/> Tufo (specify) <input type="checkbox"/> Travertine <input type="checkbox"/> Other Limestone <input type="checkbox"/> Basalt <input type="checkbox"/> Clay <input type="checkbox"/> Sand <input type="checkbox"/> Silt <input type="checkbox"/> Pebbles (range) <input type="checkbox"/> Gravel (range)	<input type="checkbox"/> Charcoal <input type="checkbox"/> Ash <input type="checkbox"/> Animal bones <input type="checkbox"/> Human bones <input type="checkbox"/> Animal teeth <input type="checkbox"/> Human teeth <input type="checkbox"/> Shells <input type="checkbox"/> Other (specify)	<input type="checkbox"/> Hard <input type="checkbox"/> Compact <input type="checkbox"/> Friable <input type="checkbox"/> Loose <input type="checkbox"/> Soft
			Compaction <input type="checkbox"/> Black <input type="checkbox"/> Brown <input type="checkbox"/> Gray <input type="checkbox"/> Light Brown <input type="checkbox"/> Light Gray <input type="checkbox"/> White <input type="checkbox"/> Yellow <input type="checkbox"/> Red <input type="checkbox"/> Light Yellow <input type="checkbox"/> Other (specify)

UNIT LIMITS (also indicate on overlay)	Depth: <input type="checkbox"/> Original <input checked="" type="checkbox"/> Not Original
Northern Limit <input type="checkbox"/> Original <input checked="" type="checkbox"/> Not Original <input type="checkbox"/> Excavation Limit	
Southern Limit <input type="checkbox"/> Original <input checked="" type="checkbox"/> Not Original <input type="checkbox"/> Excavation Limit	
Western Limit <input type="checkbox"/> Original <input checked="" type="checkbox"/> Not Original <input type="checkbox"/> Excavation Limit	
Eastern Limit <input type="checkbox"/> Original <input checked="" type="checkbox"/> Not Original <input type="checkbox"/> Excavation Limit	

STRATIGRAPHICAL SEQUENCE	
Is equal to:	Is bound to (only for masonry):
Is abutted by:	Abuts:
Is covered by: 0	Covers:
Is cut by: 2	Cuts: 1
Is filled by: 222	Fills:

OBSERVATIONS
hand-travelled in sunny weather

DESCRIPTION
Position within sector: Southern central area A, East of hut
Shape: irregular

For layers complete this section:
Surface (slope direction; visible inclusions):
Observations about inclusions (Clusters? Deposition slope):
Observations about thickness (Increases? Decreases?):
Nature of the interface with layer below: sharp diffuse commingled other (specify)

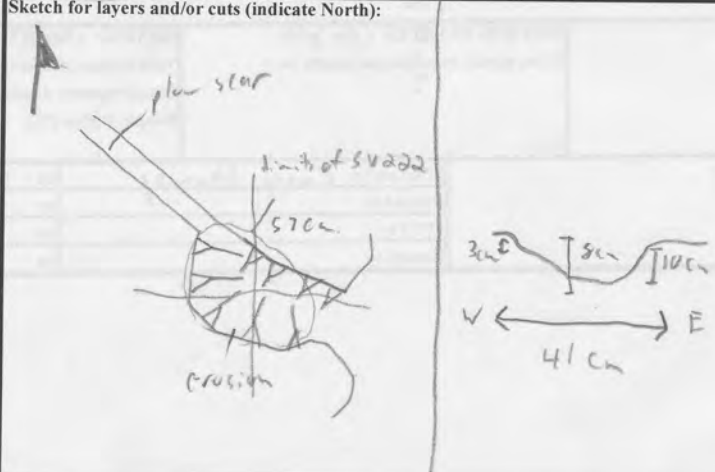
For cuts complete this section:	Sketch for layers and/or cuts (indicate North):
Cut edges: <input checked="" type="checkbox"/> rounded <input type="checkbox"/> straight Cut sides: <input type="checkbox"/> straight <input type="checkbox"/> concave <input type="checkbox"/> convex <input checked="" type="checkbox"/> sloping Cut bottom: <input type="checkbox"/> flat <input type="checkbox"/> concave <input checked="" type="checkbox"/> irregular How is cut top edge? <input checked="" type="checkbox"/> sharp <input checked="" type="checkbox"/> rounded How is cut bottom edge? <input checked="" type="checkbox"/> sharp <input checked="" type="checkbox"/> rounded Observations: sharp to East, rounded to west on sides and bottom	

221 CUT

For structural remains complete this section

Alignment:
 Building Technique: Adobe/Mud-brick Ashlar (blocks) irregular (unworked) stone Concrete Other (specify)

Binding Agent: None Clay Mortar (if so, specify composition, color, compaction)

Concrete inclusions:
 Material Tufo Basalt Travertine Tiles Other (specify)
 Size Small (range) _____ Medium (range) _____ Large (range) _____ Representative size: e.g. 2 x 1 x 2 cmz

Wall Facing:
 Opus quadratum Opus incertum Opus reticulatum Petit appareil Opus testaceum Opus mixtum Opus vittatum Other (specify)

Complete this section for foundations Faced foundation Wooden shuttering No shuttering

floor/revetment type
 Floor type: Beaten Earth Opus signinum Opus scutulatum Opus Sectile Mosaic Opus spicatum Other (specify)
 Wall finishing Stucco Opus signinum Plaster Painted Plaster Other (specify)

Approx. length, width, height of structural remains:

Description:

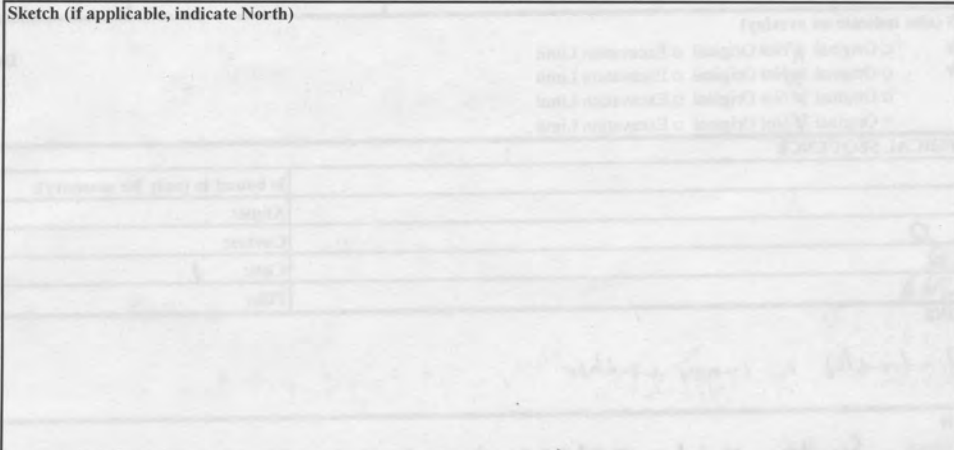

INTERPRETATION

Plow-scar cutting through natural erosion created a layer of fill that appeared circular from the top, but upon excavation the 'cut' proved to be irregular and non-circular - conforming with ^{other} similar erosion and plow-scar features in the area

THIS IS NOT A CIRCULAR FEATURE, BUT IS NATURAL.

SOIL SAMPLING: Yes No
 Total volume of layer (buckets):
 Sample quantity (buckets):
 Sample fraction (%):

NON SOIL SAMPLES: Yes No
 If yes, specify (e.g. charcoal, mortar etc.):
 Size:

SIEVING: Yes No
 Total volume of layer (buckets):
 Sample quantity (buckets):
 Sample fraction (%):

STRATIGRAPHICAL RELIABILITY
 Good Fair Poor

Filled-out by	Casey Shoney	on	16 Jul. 09
Revised by		on	
PDFd by		on	
Entered by		on	

TUG 100