

SITE GPR	YEAR 2011	AREA C	SECTOR	ELEVATION Min: 61.486 Max: 61.676	STRATIGRAPHICAL UNIT		 University of Michigan Center for Research in Earth Technology Gabil Project
					2017	<input type="checkbox"/> Natural <input checked="" type="checkbox"/> Anthropic	
In cross-section? <input checked="" type="checkbox"/> Yes <input type="checkbox"/> No			In elevation drawing? <input type="checkbox"/> Yes <input checked="" type="checkbox"/> No		Photos: <input checked="" type="checkbox"/> Yes <input type="checkbox"/> No #: James's cam 271-272		Photo Model: <input checked="" type="checkbox"/> Yes <input type="checkbox"/> No #: 209
DEFINITION Tract & wall of 700 blocks with E-W orientation in S-central part of Area					Covered by <input checked="" type="checkbox"/> SU: 2171?	Fills 4512-4813 <input type="checkbox"/> SU:	Filled by <input type="checkbox"/> SU:
HOW IS LAYER DISTINGUISHED? <input type="checkbox"/> Color <input type="checkbox"/> Composition <input type="checkbox"/> Compaction			FORMATION PROCESS <input type="checkbox"/> Accumulation <input checked="" type="checkbox"/> Construction <input type="checkbox"/> Cutting <input type="checkbox"/> Erosion <input type="checkbox"/> Collapse <input type="checkbox"/> Intentional deposition				
INCLUSIONS For each inclusion specify frequency: (f)requent, (m)edium, (r)are					SOIL/MATRIX		
<b>Anthropic</b>		<b>Geological</b>		<b>Organic</b>	clay ___% silt ___% sand ___%		
<input type="checkbox"/> Pottery <input type="checkbox"/> Tiles <input type="checkbox"/> Amphorae <input type="checkbox"/> Dolia <input type="checkbox"/> Mosaic tiles(s) <input type="checkbox"/> Mortar <input type="checkbox"/> Coins <input type="checkbox"/> Metal (specify) <input type="checkbox"/> Collapse debris <input type="checkbox"/> Glass		<input type="checkbox"/> Nails <input type="checkbox"/> Marble <input type="checkbox"/> Quarried debris <input type="checkbox"/> Slag <input type="checkbox"/> Brick <input type="checkbox"/> Basalt slabs <input type="checkbox"/> Opus signinum <input type="checkbox"/> Painted plaster <input type="checkbox"/> Burnt Adobe <input type="checkbox"/> Other (specify)		<input type="checkbox"/> Tufo (specify) <input type="checkbox"/> Travertine <input type="checkbox"/> Other Limestone <input type="checkbox"/> Basalt <input type="checkbox"/> Clay <input type="checkbox"/> Sand <input type="checkbox"/> Silt <input type="checkbox"/> Pebbles (range) <input type="checkbox"/> Gravel (range)	<input type="checkbox"/> Charcoal <input type="checkbox"/> Ash <input type="checkbox"/> Animal bones <input type="checkbox"/> Human bones <input type="checkbox"/> Animal teeth <input type="checkbox"/> Human teeth <input type="checkbox"/> Shells <input type="checkbox"/> Other (specify)	<input type="checkbox"/> Granular <input type="checkbox"/> Layered <input type="checkbox"/> Cohesive	
					<b>Compaction</b>	<b>Color</b>	
					<input type="checkbox"/> Hard <input type="checkbox"/> Compact <input type="checkbox"/> Friable <input type="checkbox"/> Loose <input type="checkbox"/> Soft	<input type="checkbox"/> Black <input type="checkbox"/> Brown <input type="checkbox"/> Gray <input type="checkbox"/> Light Brown <input type="checkbox"/> Light Gray <input type="checkbox"/> White <input type="checkbox"/> Yellow <input type="checkbox"/> Red <input type="checkbox"/> Light Yellow <input type="checkbox"/> Other (specify)	
UNIT LIMITS (also indicate on overlay)							
Northern Limit <input checked="" type="checkbox"/> Original <input type="checkbox"/> Not Original <input type="checkbox"/> Excavation Limit				Depth: <input type="checkbox"/> Original <input checked="" type="checkbox"/> Not Original			
Southern Limit <input checked="" type="checkbox"/> Original <input type="checkbox"/> Not Original <input type="checkbox"/> Excavation Limit							
Western Limit <input type="checkbox"/> Original <input checked="" type="checkbox"/> Not Original <input type="checkbox"/> Excavation Limit							
Eastern Limit <input type="checkbox"/> Original <input checked="" type="checkbox"/> Not Original <input type="checkbox"/> Excavation Limit							
STRATIGRAPHICAL SEQUENCE							
Is equal to:				Is bound to (only for masonry):			
Is abutted by:				Abuts:			
Is covered by: 2171?				Covers:			
Is cut by: 2206				Cuts:			
Is filled by:				Fills:			
OBSERVATIONS Small section of crumbly & truncated tufo ashlar wall.							
DESCRIPTION Position within sector: Central Area C, directly S of drainage channel Shape: Linear 2206.							
For layers complete this section: Surface (slope direction; visible inclusions): Observations about inclusions (Clusters? Deposition slope): Observations about thickness (Increases? Decreases?): Nature of the interface with layer below: <input type="checkbox"/> sharp <input type="checkbox"/> diffuse <input type="checkbox"/> commingled <input type="checkbox"/> other (specify)							
For cuts complete this section: Cut edges: <input type="checkbox"/> rounded <input type="checkbox"/> straight Cut sides <input type="checkbox"/> straight <input type="checkbox"/> concave <input type="checkbox"/> convex <input type="checkbox"/> sloping Cut bottom: <input type="checkbox"/> flat <input type="checkbox"/> concave <input type="checkbox"/> irregular How is cut top edge? <input type="checkbox"/> sharp <input type="checkbox"/> rounded How is cut bottom edge? <input type="checkbox"/> sharp <input type="checkbox"/> rounded Observations:				Sketch for layers and/or cuts (indicate North):			

mmmm

**For structural remains complete this section**

Alignment: **E-W**

Building Technique:  Adobe/Mud-brick  Ashlar (blocks)  irregular (unworked) stone  Concrete  Other (specify)

Binding Agent:  None  Clay  Mortar (if so, specify composition, color, compaction)

Concrete inclusions: **N/A**

Material:  Tufo  Basalt  Travertine  Tiles  Other (specify)

Size:  Small (range)  $18 \times 16 \times \frac{5}{5}$   Medium (range)  $23 \times 18 \times \frac{9}{9}$   Large (range)  $65 \times 43 \times \frac{17}{17}$  Representative size: e.g. 2 x 1 x 2 cmz

Wall Facing:

Opus quadratum  Opus incertum  Opus reticulatum  Petit appareil  Opus testaceum  Opus mixtum  Opus vittatum  Other (specify)

Complete this section for foundations:  Faeced foundation  Wooden shuttering  No shuttering

floor/revetment type

Floor type:  Beaten Earth  Opus signinum  Opus scutulatum  Opus Sectile  Mosaic  Opus spicatum  Other (specify)

Wall finishing:  Stucco  Opus signinum  Plaster  Painted Plaster  Other (specify) **None**

Approx. length, width, height of structural remains:

**1.56 m x 0.59 m x 0.23 m**

Description:

Short tract of E-W running wall/foundation made of large orange/gray tufo ashlar blocks. One course preserved, upper parts of blocks clearly eroded away. Ashlar blocks serve as both foundation + wall. Truncated on W by 2206 + possibly by robbing activity(?) + on E by unknown action.

Sketch (if applicable, indicate North)

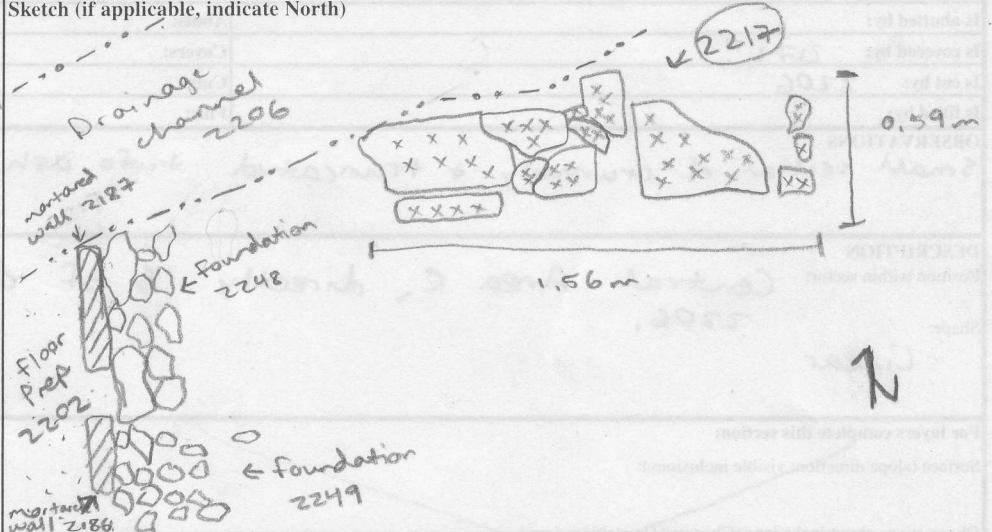

**INTERPRETATION**

E-W running wall made of large gray tufo ashlar blocks that serve as both foundation + first course of wall. Preserved only to first course. Truncated on W + possibly part of N by drainage channel 2206 + on E by unknown action. Possibly related to Z c. BCE "house", but relationship is not clear b/c of truncation on W. Block on E made of harder orange tufo that may belong to a different abutting wall, but aligns with gray tufo blocks of rest of wall + not enough preserved to tell for sure.

SOIL SAMPLING:  Yes  No

Total volume of layer (buckets):

Sample quantity (buckets):

Sample fraction (%):

NON SOIL SAMPLES:  Yes  No

If yes, specify (e.g. charcoal, mortar etc.):

Size:

SIEVING:  Yes  No

Total volume of layer (buckets):

Sample quantity (buckets):

Sample fraction (%):

**STRATIGRAPHICAL RELIABILITY**

Good  Fair  Poor

Filled-out by **E. Adkins**

on **30.6.2011**

Revised by **J. Sauer**

on **30.6.2011**

PDFd by **ECR**

on **19.7.2011**

Entered by

on