

SITE	YEAR	AREA	SECTOR	ELEVATION	STRATIGRAPHICAL UNIT
GPR	2011	C		Min: 61.0827 Max: 61.3693	2268 <input checked="" type="checkbox"/> Natural <input type="checkbox"/> Anthropic

In cross-section? Yes No
 In elevation drawing? Yes No
 Photos: Yes No #: 2182-81
 Photo Model: Yes No #:

DEFINITION: Layers to W of 2258
 Covered by SU: 0
 Fills SU:
 Filled by SU:

HOW IS LAYER DISTINGUISHED?
 Color Composition Compaction
 FORMATION PROCESS
 Accumulation Construction Cutting Erosion Collapse Intentional deposition

INCLUSIONS For each inclusion specify frequency: (f)requent, (m)edium, (r)are

Anthropic	Geological	Organic
<input checked="" type="checkbox"/> Pottery M <input checked="" type="checkbox"/> Tiles South F <input type="checkbox"/> Amphorae <input type="checkbox"/> Dolia <input type="checkbox"/> Mosaic tile(s) <input type="checkbox"/> Mortar <input type="checkbox"/> Coins <input type="checkbox"/> Metal (specify) <input type="checkbox"/> Collapse debris <input type="checkbox"/> Glass	<input checked="" type="checkbox"/> Tufo (specify) R <input checked="" type="checkbox"/> Travertine R <input type="checkbox"/> Other Limestone <input checked="" type="checkbox"/> Basalt M <input type="checkbox"/> Clay <input type="checkbox"/> Sand <input type="checkbox"/> Silt <input type="checkbox"/> Pebbles (range) <input type="checkbox"/> Gravel (range)	<input checked="" type="checkbox"/> Charcoal R <input type="checkbox"/> Ash <input checked="" type="checkbox"/> Animal bones R <input type="checkbox"/> Human bones <input checked="" type="checkbox"/> Animal teeth R <input type="checkbox"/> Human teeth <input type="checkbox"/> Shells <input type="checkbox"/> Other (specify)

SOIL/MATRIX
 clay 5% silt 90% sand 5%
 Granular Layered Cohesive

Compaction	Color
<input type="checkbox"/> Hard <input type="checkbox"/> Compact <input type="checkbox"/> Friable <input checked="" type="checkbox"/> Loose <input type="checkbox"/> Soft	<input type="checkbox"/> Black <input type="checkbox"/> Brown <input type="checkbox"/> Gray <input checked="" type="checkbox"/> Light Brown <input type="checkbox"/> Light Gray <input type="checkbox"/> White <input type="checkbox"/> Yellow <input type="checkbox"/> Red <input type="checkbox"/> Light Yellow <input type="checkbox"/> Other (specify)

UNIT LIMITS (also indicate on overlay)

Northern Limit Original Not Original Excavation Limit
 Southern Limit Original Not Original Excavation Limit
 Western Limit Original Not Original Excavation Limit
 Eastern Limit Original Not Original Excavation Limit

Depth: Original Not Original

STRATIGRAPHICAL SEQUENCE

Is equal to: 2226
 Is bound to (only for masonry):
 Is abutted by:
 Is covered by: 0; 2265, 2221, 2267
 Is cut by:
 Is filled by:
 Abuts: 2319, 2328, 2372
 Covers:
 Cuts:
 Fills:

OBSERVATIONS: Began excavating with pickaxe on July 8, 2011; High density of roof tiles; in S along wall 2259; traces of charcoal in S along wall 2259

DESCRIPTION
 Position within sector: SW part of area C
 Shape: Roughly rectangular

For layers complete this section:
 Surface (slope direction: visible inclusions): Gradual downward N→S scattered medium sized stones of basalt and tufo
 Observations about inclusions (Clusters? Deposition slope): clust of small stones in the NE corner
 Observations about thickness (Increases? Decreases?):
 Nature of the interface with layer below: sharp diffuse commingled other (specify)

For cuts complete this section:
 Cut edges: rounded straight
 Cut sides: straight concave convex sloping
 Cut bottom: flat concave irregular
 How is cut top edge? sharp rounded
 How is cut bottom edge? sharp rounded
 Observations:

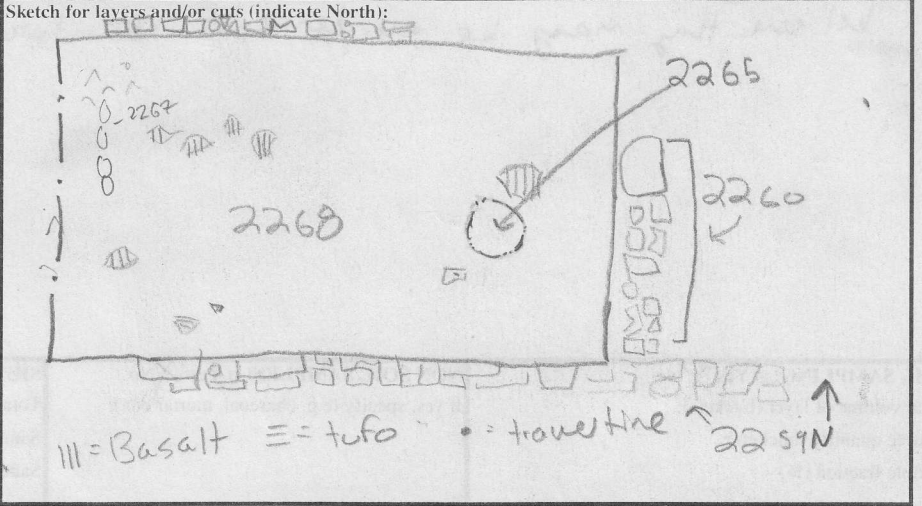

For structural remains complete this section

Alignment:

Building Technique: Adobe/Mud-brick Ashlar (blocks) irregular (unworked) stone Concrete Other (specify)

Binding Agent: None Clay Mortar (if so, specify composition, color, compaction)

Concrete inclusions:

Material Tufo Basalt Travertine Tiles Other (specify)

Size Small (range) _____ Medium (range) _____ Large (range) _____ Representative size: e.g. 2 x 1 x 2 cmz

Wall Facing:

Opus quadratum Opus incertum Opus reticulatum Petit appareil Opus testaceum Opus mixtum Opus vittatum Other (specify)

Complete this section for foundations Faced foundation Wooden shuttering No shuttering

floor/revetment type

Floor type: Beaten Earth Opus signinum Opus scutulatum Opus Sectile Mosaic Opus spicatum Other (specify)

Wall finishing Stucco Opus signinum Plaster Painted Plaster Other (specify)

Approx. length, width, height of structural remains:

Description:

Sketch (if applicable, indicate North)

INTERPRETATION

This is a layer of post-abandonment accumulation. Based on the frequency of stones, roof-tiles, and traces of charcoal in the soil, I believe they may be evidence of structural collapse.

SOIL SAMPLING: Yes No

Total volume of layer (buckets):

Sample quantity (buckets):

Sample fraction (%):

NON SOIL SAMPLES: Yes No

If yes, specify (e.g. charcoal, mortar etc.):

Size:

SIEVING: Yes No

Total volume of layer (buckets):

Sample quantity (buckets):

Sample fraction (%):

STRATIGRAPHICAL RELIABILITY

Good Fair Poor

Filled-out by *Eric F.*

on *11 July 2011*

Revised by *J. Sewell*

on *30.7.11*

PDFd by *ETR*

on *1-8-11*

Entered by

on