

SITE GPR	YEAR 11	AREA C	SECTOR	ELEVATION Min: 60.950 Max: 61.166	STRATIGRAPHICAL UNIT 2355 <input type="checkbox"/> Natural <input checked="" type="checkbox"/> Anthropic	
-------------	------------	-----------	--------	---	--	--

In cross-section? <input type="checkbox"/> Yes <input checked="" type="checkbox"/> No	In elevation drawing? <input type="checkbox"/> Yes <input checked="" type="checkbox"/> No	Photos: <input checked="" type="checkbox"/> Yes <input type="checkbox"/> No #: 2392-93	Photo Model: <input checked="" type="checkbox"/> Yes <input type="checkbox"/> No #: 297
---	---	--	---

DEFINITION <i>Linear Group of stones on E-W alignment, W of 2353</i>	Covered by <input checked="" type="checkbox"/> SU: 2323	Fills <input type="checkbox"/> SU:	Filled by <input type="checkbox"/> SU:
---	--	---------------------------------------	---

HOW IS LAYER DISTINGUISHED? <input type="checkbox"/> Color <input type="checkbox"/> Composition <input type="checkbox"/> Compaction	FORMATION PROCESS <input type="checkbox"/> Accumulation <input checked="" type="checkbox"/> Construction <input type="checkbox"/> Cutting <input type="checkbox"/> Erosion <input type="checkbox"/> Collapse <input type="checkbox"/> Intentional deposition
--	---

INCLUSIONS For each inclusion specify frequency: (f)requent, (m)edium, (r)are			SOIL/MATRIX clay ___% silt ___% sand ___% <input type="checkbox"/> Granular <input type="checkbox"/> Layered <input type="checkbox"/> Cohesive				
Anthropic	Geological	Organic					
<input type="checkbox"/> Pottery <input type="checkbox"/> Tiles <input type="checkbox"/> Amphorae <input type="checkbox"/> Dolia <input type="checkbox"/> Mosaic tile(s) <input checked="" type="checkbox"/> Mortar <input type="checkbox"/> Coins <input type="checkbox"/> Metal (specify) <input type="checkbox"/> Collapse debris <input type="checkbox"/> Glass	<input type="checkbox"/> Nails <input type="checkbox"/> Marble <input type="checkbox"/> Quarried debris <input type="checkbox"/> Slag <input type="checkbox"/> Brick <input type="checkbox"/> Basalt slabs <input type="checkbox"/> Opus signinum <input type="checkbox"/> Painted plaster <input type="checkbox"/> Burnt Adobe <input type="checkbox"/> Other (specify)	<input type="checkbox"/> Tufo (specify) <input type="checkbox"/> Travertine <input type="checkbox"/> Other Limestone <input type="checkbox"/> Basalt <input type="checkbox"/> Clay <input type="checkbox"/> Sand <input type="checkbox"/> Silt <input type="checkbox"/> Pebbles (range) <input type="checkbox"/> Gravel (range)	<input type="checkbox"/> Charcoal <input type="checkbox"/> Ash <input type="checkbox"/> Animal bones <input type="checkbox"/> Human bones <input type="checkbox"/> Animal teeth <input type="checkbox"/> Human teeth <input type="checkbox"/> Shells <input type="checkbox"/> Other (specify)				
			<table border="1"> <tr> <td>Compaction</td> <td>Color</td> </tr> <tr> <td> <input type="checkbox"/> Hard <input type="checkbox"/> Compact <input type="checkbox"/> Friable <input type="checkbox"/> Loose <input type="checkbox"/> Soft </td> <td> <input type="checkbox"/> Black <input type="checkbox"/> Brown <input type="checkbox"/> Gray <input type="checkbox"/> Light Brown <input type="checkbox"/> Light Gray <input type="checkbox"/> White <input type="checkbox"/> Yellow <input type="checkbox"/> Red <input type="checkbox"/> Light Yellow <input type="checkbox"/> Other (specify) </td> </tr> </table>	Compaction	Color	<input type="checkbox"/> Hard <input type="checkbox"/> Compact <input type="checkbox"/> Friable <input type="checkbox"/> Loose <input type="checkbox"/> Soft	<input type="checkbox"/> Black <input type="checkbox"/> Brown <input type="checkbox"/> Gray <input type="checkbox"/> Light Brown <input type="checkbox"/> Light Gray <input type="checkbox"/> White <input type="checkbox"/> Yellow <input type="checkbox"/> Red <input type="checkbox"/> Light Yellow <input type="checkbox"/> Other (specify)
Compaction	Color						
<input type="checkbox"/> Hard <input type="checkbox"/> Compact <input type="checkbox"/> Friable <input type="checkbox"/> Loose <input type="checkbox"/> Soft	<input type="checkbox"/> Black <input type="checkbox"/> Brown <input type="checkbox"/> Gray <input type="checkbox"/> Light Brown <input type="checkbox"/> Light Gray <input type="checkbox"/> White <input type="checkbox"/> Yellow <input type="checkbox"/> Red <input type="checkbox"/> Light Yellow <input type="checkbox"/> Other (specify)						

UNIT LIMITS (also indicate on overlay)		Depth: <input type="checkbox"/> Original <input checked="" type="checkbox"/> Not Original
Northern Limit	<input checked="" type="checkbox"/> Original <input type="checkbox"/> Not Original <input type="checkbox"/> Excavation Limit	
Southern Limit	<input checked="" type="checkbox"/> Original <input type="checkbox"/> Not Original <input type="checkbox"/> Excavation Limit	
Western Limit	<input type="checkbox"/> Original <input checked="" type="checkbox"/> Not Original <input type="checkbox"/> Excavation Limit	
Eastern Limit	<input type="checkbox"/> Original <input checked="" type="checkbox"/> Not Original <input type="checkbox"/> Excavation Limit	

STRATIGRAPHICAL SEQUENCE	
Is equal to:	Is bound to (only for masonry):
Is abutted by:	Abuts:
Is covered by: 2323	Covers: <i>Index covered further in 2011</i>
Is cut by:	Cuts:
Is filled by:	Fills:

OBSERVATIONS

DESCRIPTION

Position within sector:

SE corner of Area C, W of wall 2353

Shape: linear

For layers complete this section:

Surface (slope direction; visible inclusions):

Observations about inclusions (Clusters? Deposition slope)

Observations about thickness (Increases? Decreases?):

Nature of the interface with layer below: sharp diffuse commingled other (specify)

<p>For cuts complete this section:</p> <p>Cut edges: <input type="checkbox"/> rounded <input type="checkbox"/> straight</p> <p>Cut sides: <input type="checkbox"/> straight <input type="checkbox"/> concave <input type="checkbox"/> convex <input type="checkbox"/> sloping</p> <p>Cut bottom: <input type="checkbox"/> flat <input type="checkbox"/> concave <input type="checkbox"/> irregular</p> <p>How is cut top edge? <input type="checkbox"/> sharp <input type="checkbox"/> rounded</p> <p>How is cut bottom edge? <input type="checkbox"/> sharp <input type="checkbox"/> rounded</p> <p>Observations:</p>	<p>Sketch for layers and/or cuts (indicate North):</p>
--	--

For structural remains complete this section

Alignment:

E-W

Building Technique: Adobe/Mud-brick Ashlar (blocks) Irregular (unworked) stone Concrete Other (specify)

Binding Agent: None Clay Mortar (if so, specify composition, color, compaction)

Concrete inclusions:

Material: Tufo Basalt Travertine Tiles Other (specify)
 Size: Small (range) _____ Medium (range) _____ Large (range) _____ Representative size: e.g. 2 x 1 x 2 cmz

Wall Facing:

Opus quadratum Opus incertum Opus reticulatum Petit appareil Opus testaceum Opus mixtum Opus vittatum Other (specify)

Complete this section for foundations Faced foundation Wooden shuttering No shuttering

floor/revetment type:

Floor type: Beaten Earth Opus signinum Opus scutulatum Opus Sectile Mosaic Opus spicatum Other (specify)

Wall finishing Stucco Opus signinum Plaster Painted Plaster Other (specify)

Approx. length, width, height of structural remains:

280 x 60 x 25cm

Description:

linear group of unworked Stone, mix of basalt and tufa. Medium-sized stones

see PM 297

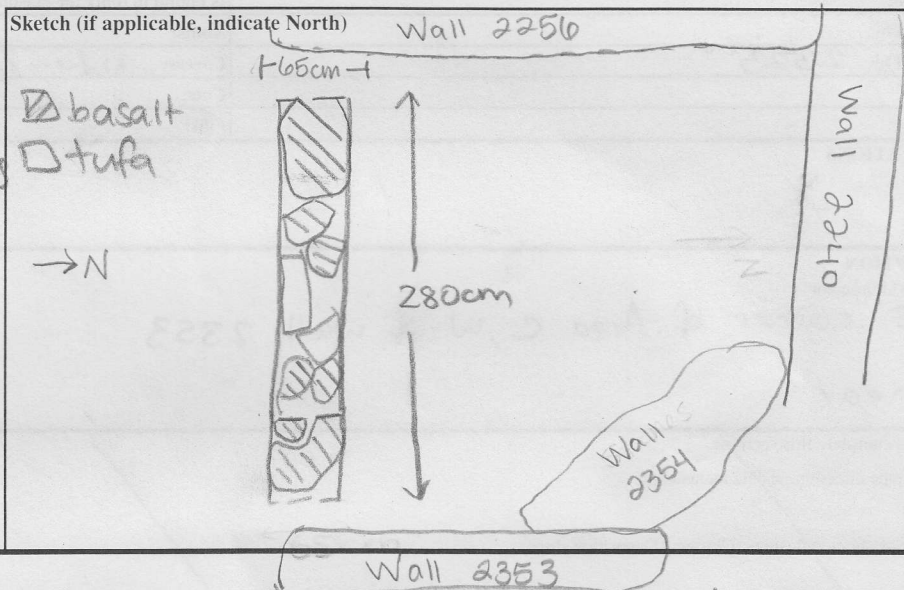

INTERPRETATION

Possible wall of unknown function and age. Stratigraphic relationships to other structures (2353, 2354, 2240) is unclear. Appears truncated on E and W limits. Layers to N and S appear to be different, so 2355 possibly delineates ~~two~~ 2 separate surfaces.

Suspected wall due to the alignment of stones, but this interpretation remains weak. Unknown function.

SOIL SAMPLING: Yes No

Total volume of layer (buckets):

Sample quantity (buckets):

Sample fraction (%):

NON SOIL SAMPLES: Yes No

If yes, specify (e.g. charcoal, mortar etc.):

Size:

SIEVING: Yes No

Total volume of layer (buckets):

Sample quantity (buckets):

Sample fraction (%):

STRATIGRAPHICAL RELIABILITY

Good Fair Poor

Filled-out by	sheira Cohen	on	26/7/11
Revised by	AS	on	28-7-2011
PDFd by	ECR	on	3-8-11
Entered by		on	