

SITE GPR	YEAR 2009	AREA A	SECTOR	ELEVATION Min: 64.3 Max: 64.15	STRATIGRAPHICAL UNIT 300 <input type="checkbox"/> Natural <input checked="" type="checkbox"/> Anthropic	University of Michigan Kelsey Museum of Archaeology Gabii Project 20 JULY 09
In cross-section? <input type="checkbox"/> Yes <input checked="" type="checkbox"/> No		In elevation drawing? <input type="checkbox"/> Yes <input checked="" type="checkbox"/> No		Photos: <input checked="" type="checkbox"/> Yes <input type="checkbox"/> No #: 584587		Photo Model: <input type="checkbox"/> Yes <input checked="" type="checkbox"/> No #:
DEFINITION Rectangular cut in tufo southwest of hut			Covered by <input type="checkbox"/> SU:	Fills <input type="checkbox"/> SU:	Filled by <input type="checkbox"/> SU: 280	
HOW IS LAYER DISTINGUISHED? <input type="checkbox"/> Color <input type="checkbox"/> Composition <input checked="" type="checkbox"/> Compaction			FORMATION PROCESS <input type="checkbox"/> Accumulation <input type="checkbox"/> Construction <input checked="" type="checkbox"/> Cutting <input type="checkbox"/> Erosion <input type="checkbox"/> Collapse <input type="checkbox"/> Intentional deposition			
INCLUSIONS For each inclusion specify frequency: (f)requent, (m)edium, (r)are					SOIL/MATRIX clay ___% silt ___% sand ___% <input type="checkbox"/> Granular <input type="checkbox"/> Layered <input type="checkbox"/> Cohesive	
Anthropic <input type="checkbox"/> Pottery <input type="checkbox"/> Tiles <input type="checkbox"/> Amphorae <input type="checkbox"/> Dolia <input type="checkbox"/> Mosaic tile(s) <input type="checkbox"/> Mortar <input type="checkbox"/> Coins <input type="checkbox"/> Metal (specify) <input type="checkbox"/> Collapse debris <input type="checkbox"/> Glass		Geological <input type="checkbox"/> Tufo (specify) <input type="checkbox"/> Travertine <input type="checkbox"/> Other Limestone <input type="checkbox"/> Basalt <input type="checkbox"/> Clay <input type="checkbox"/> Sand <input type="checkbox"/> Silt <input type="checkbox"/> Pebbles (range) <input type="checkbox"/> Gravel (range)		Organic <input type="checkbox"/> Charcoal <input type="checkbox"/> Ash <input type="checkbox"/> Animal bones <input type="checkbox"/> Human bones <input type="checkbox"/> Animal teeth <input type="checkbox"/> Human teeth <input type="checkbox"/> Shells <input type="checkbox"/> Other (specify)		Compaction <input type="checkbox"/> Hard <input type="checkbox"/> Compact <input type="checkbox"/> Friable <input type="checkbox"/> Loose <input type="checkbox"/> Soft
				Color <input type="checkbox"/> Black <input type="checkbox"/> Brown <input type="checkbox"/> Gray <input type="checkbox"/> Light Brown <input type="checkbox"/> Light Gray <input type="checkbox"/> White <input type="checkbox"/> Yellow <input type="checkbox"/> Red <input type="checkbox"/> Light Yellow <input type="checkbox"/> Other (specify)		
UNIT LIMITS (also indicate on overlay)						
Northern Limit		<input checked="" type="checkbox"/> Original <input type="checkbox"/> Not Original <input type="checkbox"/> Excavation Limit		Depth: <input type="checkbox"/> Original <input checked="" type="checkbox"/> Not Original		
Southern Limit		<input checked="" type="checkbox"/> Original <input type="checkbox"/> Not Original <input type="checkbox"/> Excavation Limit				
Western Limit		<input checked="" type="checkbox"/> Original <input type="checkbox"/> Not Original <input type="checkbox"/> Excavation Limit				
Eastern Limit		<input checked="" type="checkbox"/> Original <input type="checkbox"/> Not Original <input type="checkbox"/> Excavation Limit				
STRATIGRAPHICAL SEQUENCE						
Is equal to:			Is bound to (only for masonry):			
Is abutted by:			Abuts:			
Is covered by: a			Covers:			
Is cut by: 2			Cuts: 1, 307			
Is filled by: 280			Fills:			
OBSERVATIONS Cut in center of trench & western section lower than eastern Arbitrary excavation limit set on the western side where su 300 intersects su 301						
DESCRIPTION Position within sector: SOUTH AREA A, SWTH WEST OF HUT Shape: RECTANGULAR ELONGATED						
For layers complete this section: Surface (slope direction; visible inclusions): Observations about inclusions (Clusters? Deposition slope): Observations about thickness (Increases? Decreases?): Nature of the interface with layer below: <input type="checkbox"/> sharp <input type="checkbox"/> diffuse <input type="checkbox"/> commingled <input type="checkbox"/> other (specify)						
For cuts complete this section: Cut edges: <input type="checkbox"/> rounded <input checked="" type="checkbox"/> straight Cut sides: <input checked="" type="checkbox"/> straight <input type="checkbox"/> concave <input type="checkbox"/> convex <input type="checkbox"/> sloping Cut bottom: <input checked="" type="checkbox"/> flat <input type="checkbox"/> concave <input type="checkbox"/> irregular How is cut top edge? <input checked="" type="checkbox"/> sharp <input type="checkbox"/> rounded How is cut bottom edge? <input checked="" type="checkbox"/> sharp <input type="checkbox"/> rounded Observations: Cuts on su 307 (circle) on the north side and two definite circles on the southern side.			Sketch for layers and/or cuts (indicate North): North-South Profile of Western End North-South Profile of Western End			

room

For structural remains complete this section

Alignment: C. 1.00
S. 21.00
 Building Technique: Adobe/Mud-brick Ashlar (blocks) irregular (unworked) stone Concrete Other (specify)

Binding Agent: None Clay Mortar (if so, specify composition, color, compaction)

Concrete inclusions:
 Material Tufo Basalt Travertine Tiles Other (specify)
 Size Small (range) _____ Medium (range) _____ Large (range) _____ Representative size: e.g. 2 x 1 x 2 cmz

Wall Facing:
 Opus quadratum Opus incertum Opus reticulatum Petit appareil Opus testaceum Opus mixtum Opus vittatum Other (specify)

Complete this section for foundations Faced foundation Wooden shuttering No shuttering

floor/revetment type
 Floor type: Beaten Earth Opus signinum Opus scutulatum Opus Sectile Mosaic Opus spicatum Other (specify)
 Wall finishing Stucco Opus signinum Plaster Painted Plaster Other (specify)

Approx. length, width, height of structural remains:

Description:

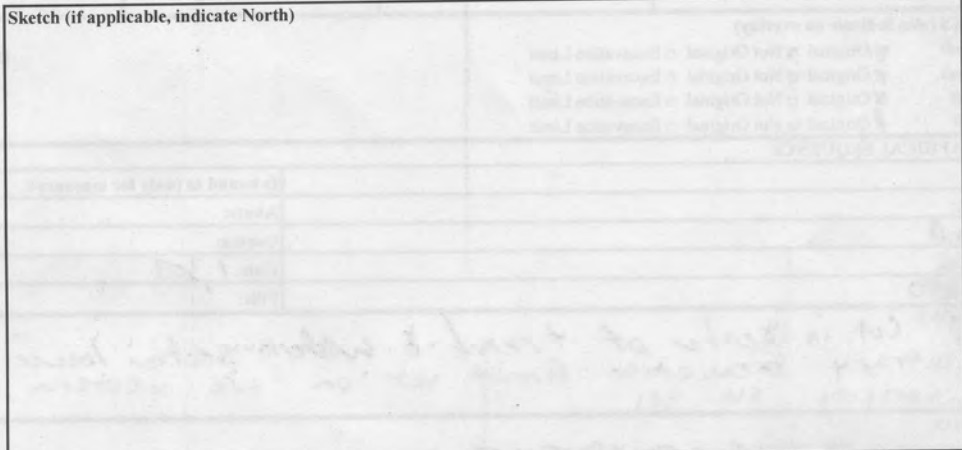

INTERPRETATION

Elongated, shallow trench cut into tufo bedrock, possibly for drainage, although neither end of the trench is visible due to erosion & other cuts

POSSIBLE WALL TRENCH

SOIL SAMPLING: Yes No
 Total volume of layer (buckets):
 Sample quantity (buckets):
 Sample fraction (%):

NON SOIL SAMPLES: Yes No
 If yes, specify (e.g. charcoal, mortar etc.):
 Size:

SIEVING: Yes No
 Total volume of layer (buckets):
 Sample quantity (buckets):
 Sample fraction (%):

STRATIGRAPHICAL RELIABILITY
 Good Fair Poor

Filled-out by	NK FWA	on	July 20 09
Revised by		on	
PDFd by		on	
Entered by		on	

