

SITE GPR	YEAR 2009	AREA A	SECTOR	ELEVATION Min: 64.27 Max: 64.28	STRATIGRAPHICAL UNIT 304 Natural 555-556 Anthropic	 University of Memphis Shelby Museum of Archaeology Gabii Project 21 July 09
In cross-section? <input type="checkbox"/> Yes <input checked="" type="checkbox"/> No		In elevation drawing? <input type="checkbox"/> Yes <input checked="" type="checkbox"/> No		Photos: <input checked="" type="checkbox"/> Yes <input type="checkbox"/> No # 555-506	Photo Model: <input type="checkbox"/> Yes <input checked="" type="checkbox"/> No #:	

DEFINITION LAYER OF SANDY SILT	INCL. SU: 305	Covered by <input type="checkbox"/> SU: 0	Fills <input checked="" type="checkbox"/> SU: 305	Filled by <input type="checkbox"/> SU:
-----------------------------------	---------------	--	--	---

HOW IS LAYER DISTINGUISHED? <input checked="" type="checkbox"/> Color <input checked="" type="checkbox"/> Composition <input type="checkbox"/> Compaction	FORMATION PROCESS <input checked="" type="checkbox"/> Accumulation <input type="checkbox"/> Construction <input type="checkbox"/> Cutting <input type="checkbox"/> Erosion <input type="checkbox"/> Collapse <input type="checkbox"/> Intentional deposition
--	---

INCLUSIONS For each inclusion specify frequency: (f)requent, (m)edium, (r)are			SOIL/MATRIX				
Anthropic <input type="checkbox"/> Pottery <input type="checkbox"/> Tiles <input type="checkbox"/> Amphorae <input type="checkbox"/> Dolia <input type="checkbox"/> Mosaic tile(s) <input type="checkbox"/> Mortar <input type="checkbox"/> Coins <input type="checkbox"/> Metal (specify) <input type="checkbox"/> Collapse debris <input type="checkbox"/> Glass <input type="checkbox"/> Nails <input type="checkbox"/> Marble <input type="checkbox"/> Quarried debris <input type="checkbox"/> Slag <input type="checkbox"/> Brick <input type="checkbox"/> Basalt slabs <input type="checkbox"/> Opus signinum <input type="checkbox"/> Painted plaster <input type="checkbox"/> Burnt Adobe <input checked="" type="checkbox"/> Other (specify) None	Geological <input checked="" type="checkbox"/> Tufo (specify) M <input type="checkbox"/> Travertine <input type="checkbox"/> Other Limestone <input type="checkbox"/> Basalt <input type="checkbox"/> Clay <input type="checkbox"/> Sand <input type="checkbox"/> Silt <input type="checkbox"/> Pebbles (range) <input type="checkbox"/> Gravel (range)	Organic <input type="checkbox"/> Charcoal <input type="checkbox"/> Ash <input type="checkbox"/> Animal bones <input type="checkbox"/> Human bones <input type="checkbox"/> Animal teeth <input type="checkbox"/> Human teeth <input type="checkbox"/> Shells <input checked="" type="checkbox"/> Other (specify) None	clay ___% silt 80% sand 20% <input checked="" type="checkbox"/> Granular <input type="checkbox"/> Layered <input type="checkbox"/> Cohesive <table border="1"> <tr> <th>Compaction</th> <th>Color</th> </tr> <tr> <td><input type="checkbox"/> Hard <input checked="" type="checkbox"/> Compact <input type="checkbox"/> Friable <input type="checkbox"/> Loose <input type="checkbox"/> Soft</td> <td><input type="checkbox"/> Black <input checked="" type="checkbox"/> Brown <input type="checkbox"/> Gray <input type="checkbox"/> Light Brown <input type="checkbox"/> Light Gray <input type="checkbox"/> White <input type="checkbox"/> Yellow <input type="checkbox"/> Red <input type="checkbox"/> Light Yellow <input type="checkbox"/> Other (specify)</td> </tr> </table>	Compaction	Color	<input type="checkbox"/> Hard <input checked="" type="checkbox"/> Compact <input type="checkbox"/> Friable <input type="checkbox"/> Loose <input type="checkbox"/> Soft	<input type="checkbox"/> Black <input checked="" type="checkbox"/> Brown <input type="checkbox"/> Gray <input type="checkbox"/> Light Brown <input type="checkbox"/> Light Gray <input type="checkbox"/> White <input type="checkbox"/> Yellow <input type="checkbox"/> Red <input type="checkbox"/> Light Yellow <input type="checkbox"/> Other (specify)
Compaction	Color						
<input type="checkbox"/> Hard <input checked="" type="checkbox"/> Compact <input type="checkbox"/> Friable <input type="checkbox"/> Loose <input type="checkbox"/> Soft	<input type="checkbox"/> Black <input checked="" type="checkbox"/> Brown <input type="checkbox"/> Gray <input type="checkbox"/> Light Brown <input type="checkbox"/> Light Gray <input type="checkbox"/> White <input type="checkbox"/> Yellow <input type="checkbox"/> Red <input type="checkbox"/> Light Yellow <input type="checkbox"/> Other (specify)						

UNIT LIMITS (also indicate on overlay)	Depth: <input type="checkbox"/> Original <input checked="" type="checkbox"/> Not Original
Northern Limit <input checked="" type="checkbox"/> Original <input type="checkbox"/> Not Original <input type="checkbox"/> Excavation Limit	
Southern Limit <input checked="" type="checkbox"/> Original <input type="checkbox"/> Not Original <input type="checkbox"/> Excavation Limit	
Western Limit <input checked="" type="checkbox"/> Original <input type="checkbox"/> Not Original <input type="checkbox"/> Excavation Limit	
Eastern Limit <input checked="" type="checkbox"/> Original <input type="checkbox"/> Not Original <input type="checkbox"/> Excavation Limit	

STRATIGRAPHICAL SEQUENCE	
Is equal to:	Is bound to (only for masonry):
Is abutted by:	Abuts:
Is covered by: 0	Covers:
Is cut by: 2	Cuts:
Is filled by:	Fills: 305

OBSERVATIONS
hard travelled

DESCRIPTION
Position within sector: SOUTH AREA A IN CUT SU305
Shape: oval

For layers complete this section:
Surface (slope direction; visible inclusions): flat
Observations about inclusions (Clusters? Deposition slope): ROUGH GRAVELS OF TUFO SPREAD RANDOMLY
Observations about thickness (Increases? Decreases?): EVEN THICKNESS
Nature of the interface with layer below: sharp diffuse commingled other (specify)

For cuts complete this section:
Cut edges: rounded straight
Cut sides: straight concave convex sloping
Cut bottom: flat concave irregular
How is cut top edge? sharp rounded
How is cut bottom edge? sharp rounded
Observations:

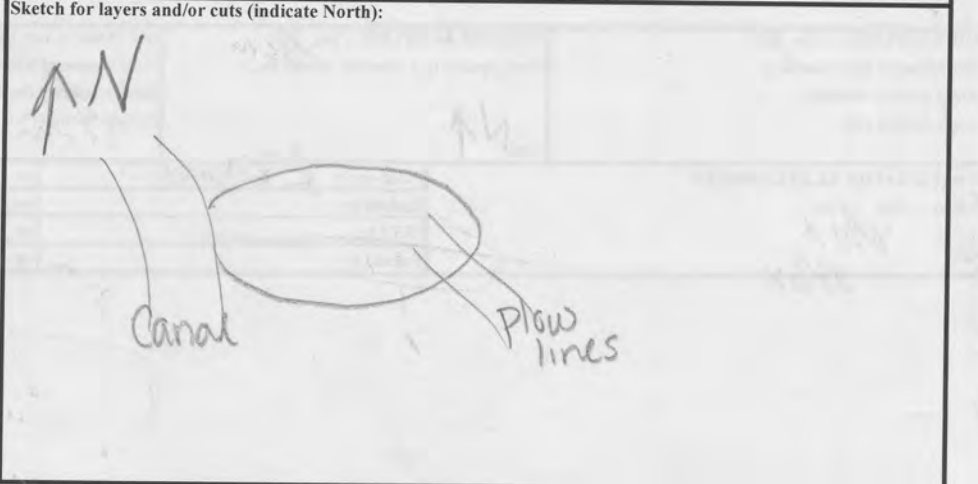

304 Fill

For structural remains complete this section

Alignment:
Building Technique: Adobe/Mud-brick Ashlar (blocks) irregular (unworked) stone Concrete Other (specify)

Binding Agent: None Clay Mortar (if so, specify composition, color, compaction)

Concrete inclusions:
Material Tufo Basalt Travertine Tiles Other (specify)
Size Small (range) _____ Medium (range) _____ Large (range) _____ Representative size: e.g. 2 x 1 x 2 cmz

Wall Facing:
 Opus quadratum Opus incertum Opus reticulatum Petit appareil Opus testaceum Opus mixtum Opus vittatum Other (specify)

Complete this section for foundations Faced foundation Wooden shuttering No shuttering

floor/revetment type
Floor type: Beaten Earth Opus signinum Opus scutulatum Opus Sectile Mosaic Opus spicatum Other (specify)
Wall finishing Stucco Opus signinum Plaster Painted Plaster Other (specify)

Approx. length, width, height of structural remains:

Description:

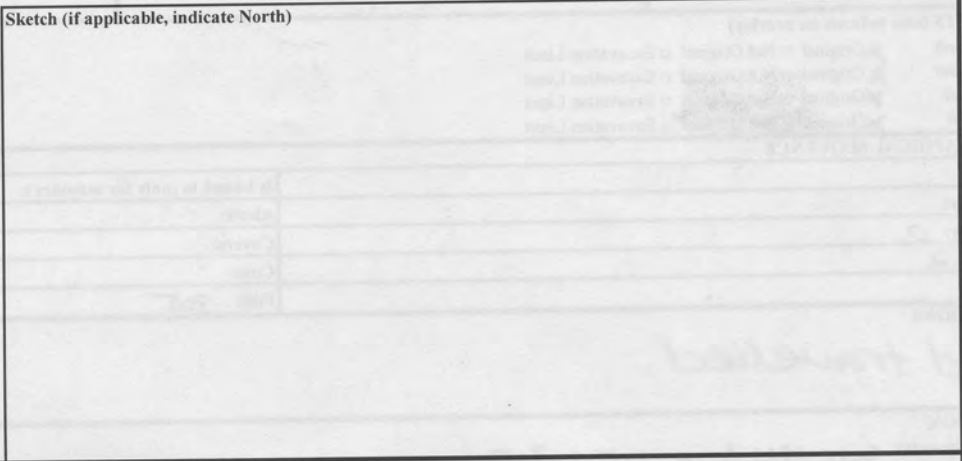

INTERPRETATION

~~parabola shape + opus sectile as floor~~
~~fill is due to erosion from stratification~~
Fill is ALLUVIAL AND FINE SUBSOIL

SOIL SAMPLING: Yes No
Total volume of layer (buckets):
Sample quantity (buckets):
Sample fraction (%):

NON SOIL SAMPLES: Yes No
If yes, specify (e.g. charcoal, mortar etc.):
Size:

SIEVING: Yes No
Total volume of layer (buckets):
Sample quantity (buckets):
Sample fraction (%):

STRATIGRAPHICAL RELIABILITY

Good Fair Poor

Filled-out by	K DAVIO	on	21 JULY 09
Revised by		on	
PDFd by		on	
Entered by		on	