

SITE GPR	YEAR	AREA	SECTOR	ELEVATION	STRATIGRAPHICAL UNIT		University of Michigan Museum of Anthropology Gabii Project
	2011	D		Min: 61.586 Max: 61.821	3069 <input type="checkbox"/> Natural <input checked="" type="checkbox"/> Anthropic		

In cross-section? Yes No In elevation drawing? Yes No Photos: Yes No #: 285-286 Photo Model: Yes No #:

DEFINITION
PLASTER IN ROOM 1

Covered by SU: Fills SU: Filled by SU:

HOW IS LAYER DISTINGUISHED? Color Composition Compaction

FORMATION PROCESS Accumulation Construction Cutting Erosion Collapse Intentional deposition

INCLUSIONS For each inclusion specify frequency: (f)requent, (m)edium, (r)are

Anthropic	Geological	Organic	SOIL/MATRIX	
<input type="checkbox"/> Pottery <input type="checkbox"/> Tiles <input type="checkbox"/> Amphorae <input type="checkbox"/> Dolia <input type="checkbox"/> Mosaic tile(s) <input type="checkbox"/> Mortar <input type="checkbox"/> Coins <input type="checkbox"/> Metal (specify) <input type="checkbox"/> Collapse debris <input type="checkbox"/> Glass	<input type="checkbox"/> Nails <input type="checkbox"/> Marble <input type="checkbox"/> Quarried debris <input type="checkbox"/> Slag <input type="checkbox"/> Brick <input type="checkbox"/> Basalt slabs <input type="checkbox"/> Opus signinum <input type="checkbox"/> Painted plaster <input type="checkbox"/> Burnt Adobe <input type="checkbox"/> Other (specify)	<input type="checkbox"/> Tufo (specify) <input type="checkbox"/> Travertine <input type="checkbox"/> Other Limestone <input type="checkbox"/> Basalt <input type="checkbox"/> Clay <input type="checkbox"/> Sand <input type="checkbox"/> Silt <input type="checkbox"/> Pebbles (range) <input type="checkbox"/> Gravel (range)	<input type="checkbox"/> Charcoal <input type="checkbox"/> Ash <input type="checkbox"/> Animal bones <input type="checkbox"/> Human bones <input type="checkbox"/> Animal teeth <input type="checkbox"/> Human teeth <input type="checkbox"/> Shells <input type="checkbox"/> Other (specify)	clay ___% silt ___% sand ___% <input type="checkbox"/> Granular <input type="checkbox"/> Layered <input type="checkbox"/> Cohesive
			Compaction	Color
			<input type="checkbox"/> Hard <input type="checkbox"/> Compact <input type="checkbox"/> Friable <input type="checkbox"/> Loose <input type="checkbox"/> Soft	<input type="checkbox"/> Black <input type="checkbox"/> Brown <input type="checkbox"/> Gray <input type="checkbox"/> Light Brown <input type="checkbox"/> Light Gray <input type="checkbox"/> White <input type="checkbox"/> Yellow <input type="checkbox"/> Red <input type="checkbox"/> Light Yellow <input type="checkbox"/> Other (specify)

UNIT LIMITS (also indicate on overlay)

Northern Limit Original Not Original Excavation Limit Depth: Original Not Original

Southern Limit Original Not Original Excavation Limit

Western Limit Original Not Original Excavation Limit

Eastern Limit Original Not Original Excavation Limit

STRATIGRAPHICAL SEQUENCE

Is equal to:	Is bound to (only for masonry):
Is abutted by: 3044, 3063	Abuts:
Is covered by: 3004	Covers:
Is cut by:	Cuts:
Is filled by:	Fills:

OBSERVATIONS
DOCUMENTED ON 20.7.11.

DESCRIPTION
Position within sector: IN CENTRAL PART OF AREA, IN CENTER OF ROOM 1.
Shape: SQUARE.

For layers complete this section:

Surface (slope direction; visible inclusions):

Observations about inclusions (Clusters? Deposition slope)

Observations about thickness (Increases? Decreases?):

Nature of the interface with layer below: sharp diffuse commingled other (specify)

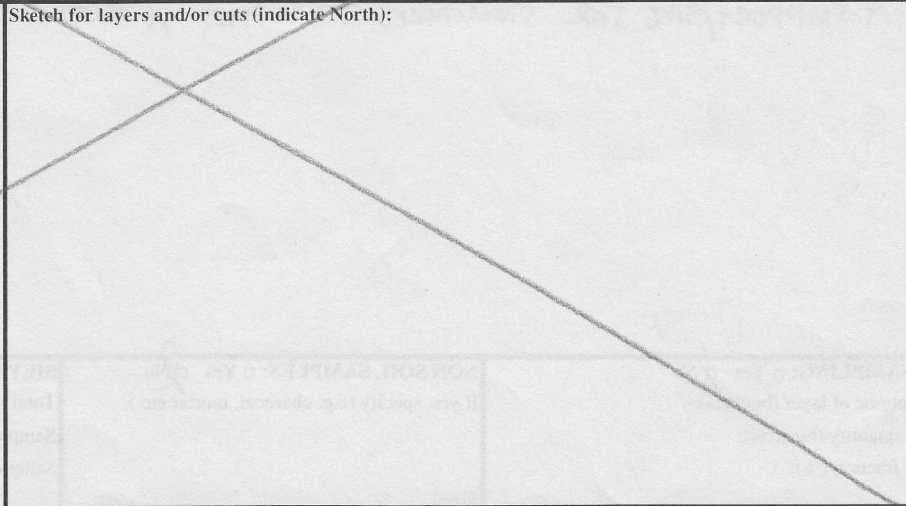
<p>For cuts complete this section:</p> <p>Cut edges: <input type="checkbox"/> rounded <input type="checkbox"/> straight</p> <p>Cut sides <input type="checkbox"/> straight <input type="checkbox"/> concave <input type="checkbox"/> convex <input type="checkbox"/> sloping</p> <p>Cut bottom: <input type="checkbox"/> flat <input type="checkbox"/> concave <input type="checkbox"/> irregular</p> <p>How is cut top edge? <input type="checkbox"/> sharp <input type="checkbox"/> rounded</p> <p>How is cut bottom edge? <input type="checkbox"/> sharp <input type="checkbox"/> rounded</p> <p>Observations:</p>	<p>Sketch for layers and/or cuts (indicate North):</p> 
---	---

For structural remains complete this section

Alignment:

Building Technique: Adobe/Mud-brick Ashlar (blocks) irregular (unworked) stone Concrete Other (specify) **TUFO**

Binding Agent: None Clay Mortar (if so, specify composition, color, compaction)

Concrete inclusions:

Material Tufo Basalt Travertine Tiles Other (specify)
 Size Small (range) _____ Medium (range) _____ Large (range) _____ Representative size: e.g. 2 x 1 x 2 cmz

Wall Facing:

Opus quadratum Opus incertum Opus reticulatum Petit appareil Opus testaceum Opus mixtum Opus vittatum Other (specify)

Complete this section for foundations Faced foundation Wooden shuttering No shuttering

floor/revetment type

Floor type: Beaten Earth Opus signinum Opus scutulatum Opus Sectile Mosaic Opus spicatum Other (specify)

Wall finishing Stucco Opus signinum Plaster Painted Plaster Other (specify)

Approx. length, width, height of structural remains:

Description:

**SQUARE TUFO STONE
 DEPOSITED IN MIDDLE OF
 ROOM 1**

Sketch (if applicable, indicate North)

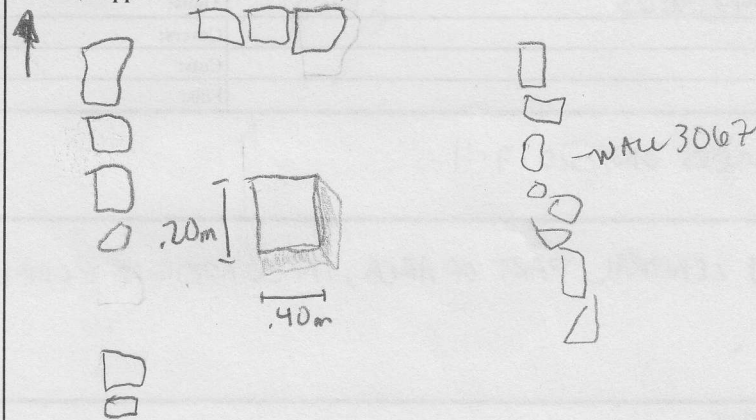

INTERPRETATION

**PILASTER LOCATED APPROXIMATELY IN THE CENTER OF ROOM 1. IT WAS LIKELY
 A SUPPORT/BASE FOR STRUCTURES TO SUPPORT A ROOF.**

SOIL SAMPLING: Yes No

Total volume of layer (buckets):

Sample quantity (buckets):

Sample fraction (%):

NON SOIL SAMPLES: Yes No

If yes, specify (e.g. charcoal, mortar etc.):

Size:

SIEVING: Yes No

Total volume of layer (buckets):

Sample quantity (buckets):

Sample fraction (%):

STRATIGRAPHICAL RELIABILITY

Good Fair Poor

Filled-out by **JME**

on **20-7-11**

Revised by **DA**

on **3-8-11**

PDFd by **ECR**

on **4-8-11**

Entered by

on