



SITE GPR	YEAR 2009	AREA A	SECTOR	ELEVATION Min: 63.56 Max: 63.59	STRATIGRAPHICAL UNIT 350 <input type="checkbox"/> Natural <input checked="" type="checkbox"/> Anthropic	 
				In cross-section? <input type="checkbox"/> Yes <input checked="" type="checkbox"/> No	In elevation drawing? <input type="checkbox"/> Yes <input checked="" type="checkbox"/> No	

DEFINITION RECTANGULAR CUT IN BEDROCK IN 128	Covered by <input type="checkbox"/> SU:	Fills <input type="checkbox"/> SU:	Filled by <input type="checkbox"/> SU: 348
---	--	---------------------------------------	---

HOW IS LAYER DISTINGUISHED? <input type="checkbox"/> Color <input type="checkbox"/> Composition <input type="checkbox"/> Compaction	FORMATION PROCESS <input type="checkbox"/> Accumulation <input type="checkbox"/> Construction <input checked="" type="checkbox"/> Cutting <input type="checkbox"/> Erosion <input type="checkbox"/> Collapse <input type="checkbox"/> Intentional deposition
--	---

INCLUSIONS For each inclusion specify frequency: (f)requent, (m)edium, (r)are			SOIL/MATRIX clay ___% silt ___% sand ___% <input type="checkbox"/> Granular <input type="checkbox"/> Layered <input type="checkbox"/> Cohesive	
Anthropic	Geological	Organic	Compaction	
<input type="checkbox"/> Pottery <input type="checkbox"/> Tiles <input type="checkbox"/> Amphorae <input type="checkbox"/> Dolia <input type="checkbox"/> Mosaic tile(s) <input type="checkbox"/> Mortar <input type="checkbox"/> Coins <input type="checkbox"/> Metal (specify) <input type="checkbox"/> Collapse debris <input type="checkbox"/> Glass	<input type="checkbox"/> Tufo (specify) <input type="checkbox"/> Travertine <input type="checkbox"/> Other Limestone <input type="checkbox"/> Basalt <input type="checkbox"/> Clay <input type="checkbox"/> Sand <input type="checkbox"/> Silt <input type="checkbox"/> Pebbles (range) <input type="checkbox"/> Gravel (range)	<input type="checkbox"/> Charcoal <input type="checkbox"/> Ash <input type="checkbox"/> Animal bones <input type="checkbox"/> Human bones <input type="checkbox"/> Animal teeth <input type="checkbox"/> Human teeth <input type="checkbox"/> Shells <input type="checkbox"/> Other (specify)	<input type="checkbox"/> Hard <input type="checkbox"/> Compact <input type="checkbox"/> Friable <input type="checkbox"/> Loose <input type="checkbox"/> Soft	
			Color	
			<input type="checkbox"/> Black <input type="checkbox"/> Brown <input type="checkbox"/> Gray <input type="checkbox"/> Light Brown <input type="checkbox"/> Light Gray <input type="checkbox"/> White <input type="checkbox"/> Yellow <input type="checkbox"/> Red <input type="checkbox"/> Light Yellow <input type="checkbox"/> Other (specify)	

UNIT LIMITS (also indicate on overlay)	Depth: <input type="checkbox"/> Original <input checked="" type="checkbox"/> Not Original
Northern Limit <input checked="" type="checkbox"/> Original <input type="checkbox"/> Not Original <input type="checkbox"/> Excavation Limit	
Southern Limit <input checked="" type="checkbox"/> Original <input type="checkbox"/> Not Original <input type="checkbox"/> Excavation Limit	
Western Limit <input checked="" type="checkbox"/> Original <input type="checkbox"/> Not Original <input type="checkbox"/> Excavation Limit	
Eastern Limit <input checked="" type="checkbox"/> Original <input type="checkbox"/> Not Original <input type="checkbox"/> Excavation Limit	

STRATIGRAPHICAL SEQUENCE	
Is equal to:	Is bound to (only for masonry):
Is abutted by:	Abuts:
Is covered by:	Covers:
Is cut by: 128	Cuts: 1
Is filled by: 348, 334, 338, 339, 340, 341, 342, 343, 344	Fills:

OBSERVATIONS 345, 346, 347, 349

DESCRIPTION
Position within sector: the cut is plowed in south eastern part of zone A, inside cut SU 128
Shape: rectangular

For layers complete this section:
Surface (slope direction; visible inclusions):
Observations about inclusions (Clusters? Deposition slope):
Observations about thickness (Increases? Decreases?):
Nature of the interface with layer below: sharp diffuse commingled other (specify)

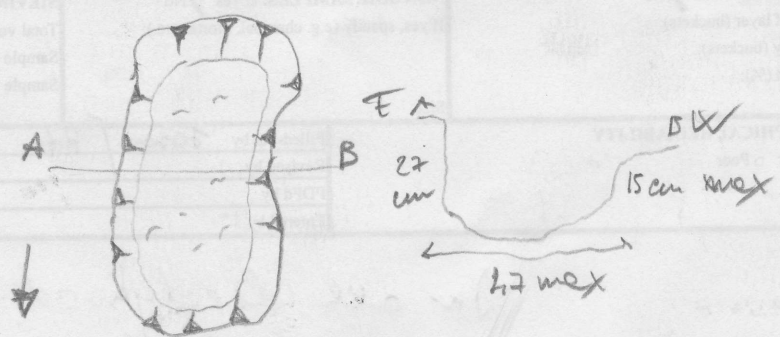
For cuts complete this section:	Sketch for layers and/or cuts (indicate North):
Cut edges: <input type="checkbox"/> rounded <input checked="" type="checkbox"/> straight <input checked="" type="checkbox"/> irregular Cut sides: <input type="checkbox"/> straight <input checked="" type="checkbox"/> concave <input type="checkbox"/> convex <input type="checkbox"/> sloping Cut bottom: <input type="checkbox"/> flat <input type="checkbox"/> concave <input checked="" type="checkbox"/> irregular How is cut top edge? <input type="checkbox"/> sharp <input checked="" type="checkbox"/> rounded How is cut bottom edge? <input checked="" type="checkbox"/> sharp <input type="checkbox"/> rounded Observations: The cut edges are very irregular; with cut top edge rounded, except at least one linear - the cut sides are concave, in particular on east	

For structural remains complete this section

Alignment:

Building Technique: Adobe/Mud-brick Ashlar (blocks) irregular (unworked) stone Concrete Other (specify)

Binding Agent: None Clay Mortar (if so, specify composition, color, compaction)

Concrete inclusions:

Material Tufo Basalt Travertine Tiles Other (specify)

Size Small (range) _____ Medium (range) _____ Large (range) _____ Representative size: e.g. 2 x 1 x 2 cmz

Wall Facing:

Opus quadratum Opus incertum Opus reticulatum Petit appareil Opus testaceum Opus mixtum Opus vittatum Other (specify)

Complete this section for foundations Faced foundation Wooden shuttering No shuttering

floor/revetment type

Floor type: Beaten Earth Opus signinum Opus scutulatum Opus Sectile Mosaic Opus spicatum Other (specify)

Wall finishing Stucco Opus signinum Plaster Painted Plaster Other (specify)

Approx. length, width, height of structural remains:

Description:

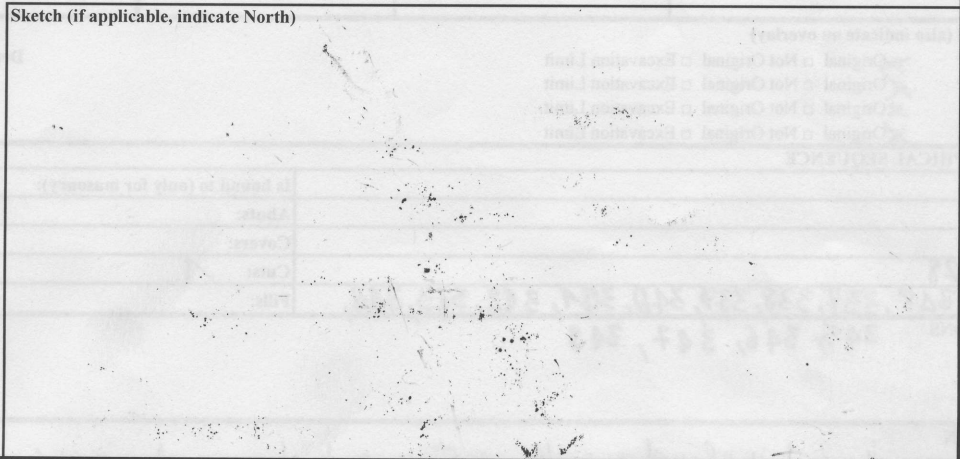

INTERPRETATION

See 350 is the cut for an inhumation grave of a child (skeleton SU 348), which also contained numerous intact ceramic vessels & brown objects. The cut is oriented north-south, and its east & west sides are stepped, as if they once supported some sort of covering over the body.

A few large stones were found in the fill SU 333 along the edges of the cut but not enough fully cover the body. ^{on all} likelihood this cut was widened with cut SU 128 during the quarry's activity because the first fill SU 126 was composed by a lot of quarried debris and because there is a step on top edge and the cut over SU 128 is more large.

SOIL SAMPLING: <input type="checkbox"/> Yes <input checked="" type="checkbox"/> No Total volume of layer (buckets): Sample quantity (buckets): Sample fraction (%):	NON SOIL SAMPLES: <input type="checkbox"/> Yes <input checked="" type="checkbox"/> No If yes, specify (e.g. charcoal, mortar etc.): Size:	SIEVING: <input type="checkbox"/> Yes <input checked="" type="checkbox"/> No Total volume of layer (buckets): Sample quantity (buckets): Sample fraction (%):
STRATIGRAPHICAL RELIABILITY <input checked="" type="checkbox"/> Good <input type="checkbox"/> Fair <input type="checkbox"/> Poor		
Filled-out by <i>Joran / Rf</i>		on <i>29/07/09</i>
Revised by		on
PDFd by		on
Entered by		on

In all likelihood

Post