

SITE GPR	YEAR 10	AREA A	SECTOR	ELEVATION Min: 64.3244 Max: 65.0067	STRATIGRAPHICAL UNIT 390 <input checked="" type="checkbox"/> Natural <input type="checkbox"/> Anthropic	 University of Michigan Kelsey Museum of Archaeology Gabii Project
-------------	------------	-----------	--------	---	---	--

In cross-section? Yes No In elevation drawing? Yes No Photos: Yes No #: 868-870 Photo Model: Yes No #:

DEFINITION: Layer beneath SU 389

Covered by SU: 389 Fills SU: Filled by SU:

HOW IS LAYER DISTINGUISHED? Color Composition Compaction

FORMATION PROCESS Accumulation Construction Cutting Erosion Collapse Intentional deposition

INCLUSIONS For each inclusion specify frequency: (f)requent, (m)edium, (r)are

Anthropic	Geological	Organic	SOIL/MATRIX														
<input checked="" type="checkbox"/> Pottery f <input type="checkbox"/> Tiles <input type="checkbox"/> Amphorae <input type="checkbox"/> Dolia <input type="checkbox"/> Mosaic tile(s) <input type="checkbox"/> Mortar <input type="checkbox"/> Coins <input checked="" type="checkbox"/> Metal (specify) r <input type="checkbox"/> Collapse debris <input type="checkbox"/> Glass <i>iron spearpoint, bronze object</i>	<input type="checkbox"/> Tufo (specify) <i>brown & m grey</i> <input checked="" type="checkbox"/> Travertine r <input type="checkbox"/> Other Limestone <input type="checkbox"/> Basalt <input type="checkbox"/> Clay <input type="checkbox"/> Sand <input type="checkbox"/> Silt <input type="checkbox"/> Pebbles (range) <input checked="" type="checkbox"/> Gravel (range) f (>1cm)	<input checked="" type="checkbox"/> Charcoal r <input type="checkbox"/> Ash <input checked="" type="checkbox"/> Animal bones r <input type="checkbox"/> Human bones <input checked="" type="checkbox"/> Animal teeth r <input type="checkbox"/> Human teeth <input type="checkbox"/> Shells <input type="checkbox"/> Other (specify)	clay 10% silt 85% sand 5% <input checked="" type="checkbox"/> Granular <input type="checkbox"/> Layered <input type="checkbox"/> Cohesive <table border="1"> <thead> <tr> <th>Compaction</th> <th>Color</th> </tr> </thead> <tbody> <tr> <td><input type="checkbox"/> Hard</td> <td><input type="checkbox"/> Black <input checked="" type="checkbox"/> Brown</td> </tr> <tr> <td><input type="checkbox"/> Compact</td> <td><input type="checkbox"/> Gray <input checked="" type="checkbox"/> Light Brown</td> </tr> <tr> <td><input checked="" type="checkbox"/> Friable</td> <td><input type="checkbox"/> Light Gray <input type="checkbox"/> White</td> </tr> <tr> <td><input type="checkbox"/> Loose</td> <td><input type="checkbox"/> Yellow <input type="checkbox"/> Red</td> </tr> <tr> <td><input type="checkbox"/> Soft</td> <td><input type="checkbox"/> Light Yellow</td> </tr> <tr> <td></td> <td><input type="checkbox"/> Other (specify)</td> </tr> </tbody> </table>	Compaction	Color	<input type="checkbox"/> Hard	<input type="checkbox"/> Black <input checked="" type="checkbox"/> Brown	<input type="checkbox"/> Compact	<input type="checkbox"/> Gray <input checked="" type="checkbox"/> Light Brown	<input checked="" type="checkbox"/> Friable	<input type="checkbox"/> Light Gray <input type="checkbox"/> White	<input type="checkbox"/> Loose	<input type="checkbox"/> Yellow <input type="checkbox"/> Red	<input type="checkbox"/> Soft	<input type="checkbox"/> Light Yellow		<input type="checkbox"/> Other (specify)
Compaction	Color																
<input type="checkbox"/> Hard	<input type="checkbox"/> Black <input checked="" type="checkbox"/> Brown																
<input type="checkbox"/> Compact	<input type="checkbox"/> Gray <input checked="" type="checkbox"/> Light Brown																
<input checked="" type="checkbox"/> Friable	<input type="checkbox"/> Light Gray <input type="checkbox"/> White																
<input type="checkbox"/> Loose	<input type="checkbox"/> Yellow <input type="checkbox"/> Red																
<input type="checkbox"/> Soft	<input type="checkbox"/> Light Yellow																
	<input type="checkbox"/> Other (specify)																

UNIT LIMITS (also indicate on overlay)

Northern Limit Original Not Original Excavation Limit Depth: Original Not Original

Southern Limit Original Not Original Excavation Limit

Western Limit Original Not Original Excavation Limit

Eastern Limit Original Not Original Excavation Limit

STRATIGRAPHICAL SEQUENCE

Is equal to:	Is bound to (only for masonry):
Is abutted by:	Abuts:
Is covered by: 389	Covers: 369, 394
Is cut by: 386, 396	Cuts:
Is filled by:	Fills:

OBSERVATIONS

special find Δ100 - half of a spindle whorl
 special find Δ122 - iron spearpoint / arrowhead.
 special find Δ124 - bronze object

DESCRIPTION

Position within sector: Borders on cut 386 to the west. Artificial southern limits corresponds with border to Area B.

Shape: Rhomboid

For layers complete this section:

Surface (slope direction; visible inclusions): Sloping down to the east, slightly south
 - tufa fragments >4cm, rare - very rare small pottery shards, >3cm
 Observations about inclusions (Clusters? Deposition slope): travertine, very rare >2cm
 Equally distributed throughout

Observations about thickness (Increases? Decreases?): Thicker towards south

Nature of the interface with layer below: sharp diffuse commingled other (specify)

For cuts complete this section:

Cut edges: rounded straight

Cut sides: straight concave convex sloping

Cut bottom: flat concave irregular

How is cut top edge? sharp rounded

How is cut bottom edge? sharp rounded

Observations:

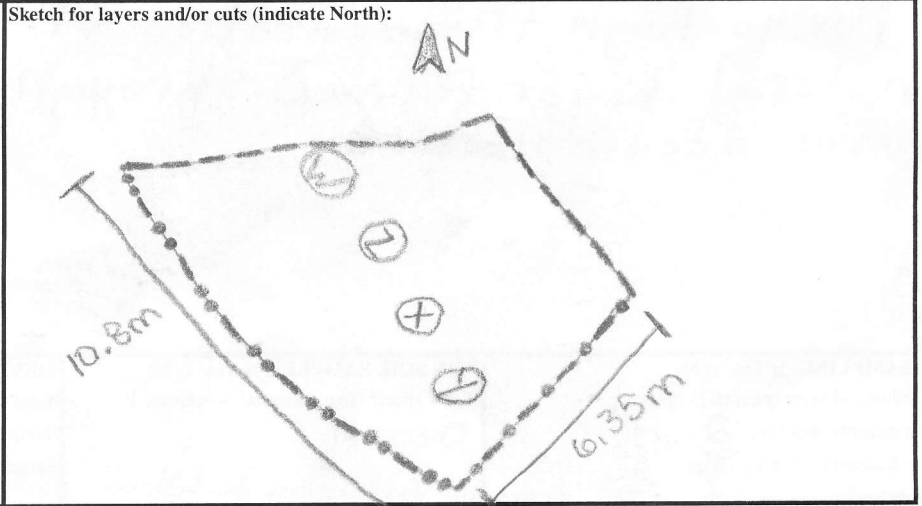

For structural remains complete this section

Alignment:
 Building Technique: Adobe/Mud-brick Ashlar (blocks) irregular (unworked) stone Concrete Other (specify)

Binding Agent: None Clay Mortar (if so, specify composition, color, compaction)

Concrete inclusions:

Material: Tufo Basalt Travertine Tiles Other (specify)
 Size: Small (range) _____ Medium (range) _____ Large (range) _____ Representative size: e.g. 2 x 1 x 2 cmz

Wall Facing:
 Opus quadratum Opus incertum Opus reticulatum Petit appareil Opus testaceum Opus mixtum Opus vittatum Other (specify)
 Complete this section for foundations Faced foundation Wooden shuttering No shuttering

floor/revetment type
 Floor type: Beaten Earth Opus signinum Opus scutulatum Opus Sectile Mosaic Opus spicatum Other (specify)
 Wall finishing: Stucco Opus signinum Plaster Painted Plaster Other (specify)

Approx. length, width, height of structural remains:

Description:

Sketch (if applicable, indicate North)

INTERPRETATION

Silty layer, artificially defined.
 Due to high fragmentation of pottery, could be natural layer formed through process of erosion and accumulation.

SOIL SAMPLING: Yes No

Total volume of layer (buckets): 764

Sample quantity (buckets): 2

Sample fraction (%): 0.26

NON SOIL SAMPLES: Yes No

If yes, specify (e.g. charcoal, mortar etc.):

Charcoal

Size: Various, upto 1.5cm

SIEVING: Yes No

Total volume of layer (buckets): 764

Sample quantity (buckets): 4

Sample fraction (%): 0.52

STRATIGRAPHICAL RELIABILITY

Good Fair Poor

Filled-out by Sean Doyle

on July 7/2010

Revised by Andrea

on 16.7.2010

PDFd by JJM

on 21.07.2010

Entered by

on