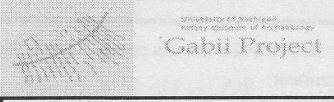

SITE GPR	YEAR 2011	AREA E	SECTOR	ELEVATION Min: 60.950 Max: 61.264	STRATIGRAPHICAL UNIT 4013 <input type="checkbox"/> Natural <input checked="" type="checkbox"/> Anthropropic	
				In cross-section? <input type="checkbox"/> Yes <input checked="" type="checkbox"/> No	In elevation drawing? <input type="checkbox"/> Yes <input checked="" type="checkbox"/> No	
DEFINITION NIS running tufo asklar wall E of 4010				Covered by <input type="checkbox"/> SU: 0	Fills <input type="checkbox"/> SU:	Filled by <input type="checkbox"/> SU:
HOW IS LAYER DISTINGUISHED? <input type="checkbox"/> Color <input type="checkbox"/> Composition <input type="checkbox"/> Compaction			FORMATION PROCESS <input type="checkbox"/> Accumulation <input checked="" type="checkbox"/> Construction <input type="checkbox"/> Cutting <input type="checkbox"/> Erosion <input type="checkbox"/> Collapse <input type="checkbox"/> Intentional deposition			
INCLUSIONS For each inclusion specify frequency: (f)requent, (m)edium, (r)are					SOIL/MATRIX clay ___% silt ___% sand ___% <input type="checkbox"/> Granular <input type="checkbox"/> Layered <input type="checkbox"/> Cohesive	
Anthropic		Geological		Organic		
<input type="checkbox"/> Pottery <input type="checkbox"/> Tiles <input type="checkbox"/> Amphorae <input type="checkbox"/> Dolia <input type="checkbox"/> Mosaic tile(s) <input type="checkbox"/> Mortar <input type="checkbox"/> Coins <input type="checkbox"/> Metal (specify) <input type="checkbox"/> Collapse debris <input type="checkbox"/> Glass		<input type="checkbox"/> Nails <input type="checkbox"/> Marble <input type="checkbox"/> Quarried debris <input type="checkbox"/> Slag <input type="checkbox"/> Brick <input type="checkbox"/> Basalt slabs <input type="checkbox"/> Opus signinum <input type="checkbox"/> Painted plaster <input type="checkbox"/> Burnt Adobe <input type="checkbox"/> Other (specify)		<input type="checkbox"/> Tufo (specify) <input type="checkbox"/> Travertine <input type="checkbox"/> Other Limestone <input type="checkbox"/> Basalt <input type="checkbox"/> Clay <input type="checkbox"/> Sand <input type="checkbox"/> Silt <input type="checkbox"/> Pebbles (range) <input type="checkbox"/> Gravel (range)		
				<input type="checkbox"/> Charcoal <input type="checkbox"/> Ash <input type="checkbox"/> Animal bones <input type="checkbox"/> Human bones <input type="checkbox"/> Animal teeth <input type="checkbox"/> Human teeth <input type="checkbox"/> Shells <input type="checkbox"/> Other (specify)		
					Compaction: <input type="checkbox"/> Hard <input type="checkbox"/> Compact <input type="checkbox"/> Friable <input type="checkbox"/> Loose <input type="checkbox"/> Soft Color: <input type="checkbox"/> Black <input type="checkbox"/> Brown <input type="checkbox"/> Gray <input type="checkbox"/> Light Brown <input type="checkbox"/> Light Gray <input type="checkbox"/> White <input type="checkbox"/> Yellow <input type="checkbox"/> Red <input type="checkbox"/> Light Yellow <input type="checkbox"/> Other (specify)	
UNIT LIMITS (also indicate on overlay)						
Northern Limit			<input type="checkbox"/> Original <input checked="" type="checkbox"/> Not Original <input type="checkbox"/> Excavation Limit		Depth: <input type="checkbox"/> Original <input checked="" type="checkbox"/> Not Original	
Southern Limit			<input type="checkbox"/> Original <input checked="" type="checkbox"/> Not Original <input type="checkbox"/> Excavation Limit			
Western Limit			<input checked="" type="checkbox"/> Original <input type="checkbox"/> Not Original <input type="checkbox"/> Excavation Limit			
Eastern Limit			<input checked="" type="checkbox"/> Original <input type="checkbox"/> Not Original <input type="checkbox"/> Excavation Limit			
STRATIGRAPHICAL SEQUENCE						
Is equal to:				Is bound to (only for masonry):		
Is abutted by:				Abuts: 4037		
Is covered by: 0				Covers:		
Is cut by:				Cuts:		
Is filled by:				Fills:		
OBSERVATIONS Relationship between 4013 + 4037 unclear - to be clarified upon excavation of layers around both.						
DESCRIPTION Position within sector: South West corner of Area E near east side of NIS road Shape: Linear						
For layers complete this section: Surface (slope direction; visible inclusions): Observations about inclusions (Clusters? Deposition slope): Observations about thickness (Increases? Decreases?): Nature of the interface with layer below: <input type="checkbox"/> sharp <input type="checkbox"/> diffuse <input type="checkbox"/> commigled <input type="checkbox"/> other (specify)						
For cuts complete this section: Cut edges: <input type="checkbox"/> rounded <input type="checkbox"/> straight Cut sides: <input type="checkbox"/> straight <input type="checkbox"/> concave <input type="checkbox"/> convex <input type="checkbox"/> sloping Cut bottom: <input type="checkbox"/> flat <input type="checkbox"/> concave <input type="checkbox"/> irregular How is cut top edge? <input type="checkbox"/> sharp <input type="checkbox"/> rounded How is cut bottom edge? <input type="checkbox"/> sharp <input type="checkbox"/> rounded Observations:				Sketch for layers and/or cuts (indicate North):		

* Needs measurements in 2012.

For structural remains complete this section

Alignment: North / South

Building Technique: Adobe/Mud-brick Ashlar (blocks) irregular (unworked) stone Concrete Other (specify)

Binding Agent: None Clay Mortar (if so, specify composition, color, compaction)

Concrete inclusions: N/A

Material: Tufo Basalt Travertine Tiles Other (specify)

Size: Small (range) _____ Medium (range) _____ Large (range) _____ Representative size: e.g. 2 x 1 x 2 cmz

Wall Facing:

Opus quadratum Opus incertum Opus reticulatum Petit appareil Opus testaceum Opus mixtum Opus vittatum Other (specify)

Complete this section for foundations Faced foundation Wooden shuttering No shuttering

floor/revetment type

Floor type: Beaten Earth Opus signinum Opus scutulatum Opus Sectile Mosaic Opus spicatum Other (specify)

Wall finishing Stucco Opus signinum Plaster Painted Plaster Other (specify)

→ Approx. length, width, height of structural remains:

Description:

N/S running tufo ashlar wall, possibly a retaining wall for eastern limit of road 4010. Between wall and road is a possible sidewalk area. ^{Wall} Consists of 3 large/long tufo blocks, northernmost block sunken into next layer, can only identify top surface.

Sketch (if applicable, indicate North)

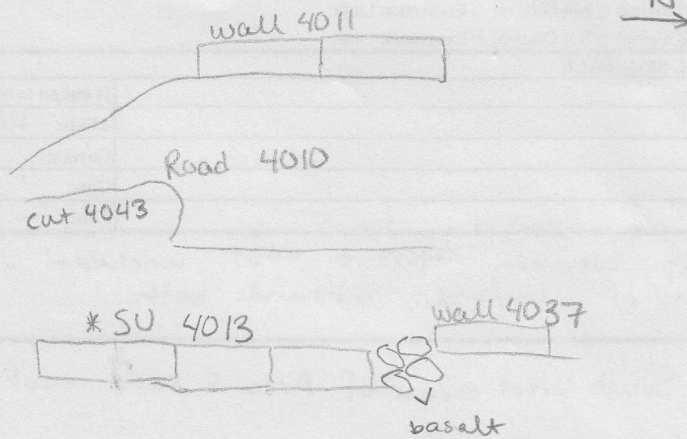

INTERPRETATION

Section of retaining wall for the road 4010 along eastern edge. Possibly serves same function as wall 4037 directly north, although alignment is different. There is a space between this wall and the road 4010 which could have functioned as a type of sidewalk, though Areas ^{to} _W of the wall are yet unexcavated. This may be a later structure near road 4010, perhaps marking a possible curb, ~~drain~~, or sidewalk. Building materials & alignment similar to wall 4011, so perhaps contemporaneous.

SOIL SAMPLING: Yes No
 Total volume of layer (buckets): _____
 Sample quantity (buckets): _____
 Sample fraction (%): _____

NON SOIL SAMPLES: Yes No
 If yes, specify (e.g. charcoal, mortar etc.): _____
 Size: _____

SIEVING: Yes No
 Total volume of layer (buckets): _____
 Sample quantity (buckets): _____
 Sample fraction (%): _____

STRATIGRAPHICAL RELIABILITY

Good Fair Poor

Filled-out by <u>J Ryan</u>	on <u>29.7.2011</u>
Revised by <u>F. Adkins</u>	on <u>3.8.2011</u>
PDFd by <u>ECR</u>	on <u>4.8.2011</u>
Entered by _____	on _____