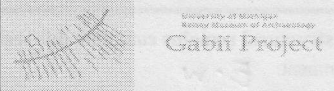

SITE GPR	YEAR 2011	AREA E	SECTOR	ELEVATION Min: 60.780 Max: 60.978	STRATIGRAPHICAL UNIT 4055 <input type="checkbox"/> Natural <input checked="" type="checkbox"/> Anthropic	
	In cross-section? <input type="checkbox"/> Yes <input checked="" type="checkbox"/> No		In elevation drawing? <input type="checkbox"/> Yes <input checked="" type="checkbox"/> No		Photos: <input checked="" type="checkbox"/> Yes <input type="checkbox"/> No #: 2284-87	
DEFINITION Pavement of large tufo slabs in S				Covered by <input checked="" type="checkbox"/> SU: 4054	Fills <input type="checkbox"/> SU: /	Filled by <input type="checkbox"/> SU: /
HOW IS LAYER DISTINGUISHED? <input type="checkbox"/> Color <input type="checkbox"/> Composition <input type="checkbox"/> Compaction			FORMATION PROCESS <input type="checkbox"/> Accumulation <input checked="" type="checkbox"/> Construction <input type="checkbox"/> Cutting <input type="checkbox"/> Erosion <input type="checkbox"/> Collapse <input type="checkbox"/> Intentional deposition			
INCLUSIONS For each inclusion specify frequency: (f)requent, (m)edium, (r)are					SOIL/MATRIX clay ___% silt ___% sand ___%	
Anthropic		Geological		Organic		<input type="checkbox"/> Granular <input type="checkbox"/> Layered <input type="checkbox"/> Cohesive
<input type="checkbox"/> Pottery <input type="checkbox"/> Tiles <input type="checkbox"/> Amphorae <input type="checkbox"/> Dolia <input type="checkbox"/> Mosaic tile(s) <input type="checkbox"/> Mortar <input type="checkbox"/> Coins <input type="checkbox"/> Metal (specify) <input type="checkbox"/> Collapse debris <input type="checkbox"/> Glass		<input type="checkbox"/> Nails <input type="checkbox"/> Marble <input type="checkbox"/> Quarried debris <input type="checkbox"/> Slag <input type="checkbox"/> Brick <input type="checkbox"/> Basalt slabs <input type="checkbox"/> Opus signinum <input type="checkbox"/> Painted plaster <input type="checkbox"/> Burnt Adobe <input type="checkbox"/> Other (specify)		<input type="checkbox"/> Tufo (specify) <input type="checkbox"/> Travertine <input type="checkbox"/> Other Limestone <input type="checkbox"/> Basalt <input type="checkbox"/> Clay <input type="checkbox"/> Sand <input type="checkbox"/> Silt <input type="checkbox"/> Pebbles (range) <input type="checkbox"/> Gravel (range)		<input type="checkbox"/> Charcoal <input type="checkbox"/> Ash <input type="checkbox"/> Animal bones <input type="checkbox"/> Human bones <input type="checkbox"/> Animal teeth <input type="checkbox"/> Human teeth <input type="checkbox"/> Shells <input type="checkbox"/> Other (specify)
					Compaction	Color
					<input type="checkbox"/> Hard <input type="checkbox"/> Compact <input type="checkbox"/> Friable <input type="checkbox"/> Loose <input type="checkbox"/> Soft	<input type="checkbox"/> Black <input type="checkbox"/> Brown <input type="checkbox"/> Gray <input type="checkbox"/> Light Brown <input type="checkbox"/> Light Gray <input type="checkbox"/> White <input type="checkbox"/> Yellow <input type="checkbox"/> Red <input type="checkbox"/> Light Yellow <input type="checkbox"/> Other (specify)
UNIT LIMITS (also indicate on overlay)						
Northern Limit			<input checked="" type="checkbox"/> Original <input checked="" type="checkbox"/> Not Original <input type="checkbox"/> Excavation Limit		Depth: <input checked="" type="checkbox"/> Original <input type="checkbox"/> Not Original	
Southern Limit			<input checked="" type="checkbox"/> Original <input checked="" type="checkbox"/> Not Original <input type="checkbox"/> Excavation Limit			
Western Limit			<input checked="" type="checkbox"/> Original <input type="checkbox"/> Not Original <input type="checkbox"/> Excavation Limit			
Eastern Limit			<input checked="" type="checkbox"/> Original <input checked="" type="checkbox"/> Not Original <input type="checkbox"/> Excavation Limit			
STRATIGRAPHICAL SEQUENCE						
Is equal to:				Is bound to (only for masonry):		
Is abutted by:				Abuts:		
Is covered by: 4054, 4057?				Covers:		
Is cut by:				Cuts:		
Is filled by:				Fills:		
OBSERVATIONS Slabs cracked; at least one (probably two) missing in S center. Not fully exposed in NW corner - to be exposed + documentation completed in 2012. Photographed, photo modeled, + shot in in 2011						
DESCRIPTION Position within sector: SE Area E Shape: Rectangular						
For layers complete this section: Surface (slope direction; visible inclusions): Observations about inclusions (Clusters? Deposition slope): Observations about thickness (Increases? Decreases?): Nature of the interface with layer below: <input type="checkbox"/> sharp <input type="checkbox"/> diffuse <input type="checkbox"/> commigled <input type="checkbox"/> other (specify)						
For cuts complete this section: Cut edges: <input type="checkbox"/> rounded <input type="checkbox"/> straight Cut sides <input type="checkbox"/> straight <input type="checkbox"/> concave <input type="checkbox"/> convex <input type="checkbox"/> sloping Cut bottom: <input type="checkbox"/> flat <input type="checkbox"/> concave <input type="checkbox"/> irregular How is cut top edge? <input type="checkbox"/> sharp <input type="checkbox"/> rounded How is cut bottom edge? <input type="checkbox"/> sharp <input type="checkbox"/> rounded Observations:				Sketch for layers and/or cuts (indicate North):		

* measurements
* TOPO
* interpretation

* Needs measurements in 2012.

For structural remains complete this section

Alignment: E-W

Building Technique: Adobe/Mud-brick Ashlar (blocks) irregular (unworked) stone Concrete Other (specify) Rectangular tufo slabs.

Binding Agent: None Clay Mortar (if so, specify composition, color, compaction)

Concrete inclusions: N/A

Material Building materials Tufo Basalt Travertine Tiles Other (specify)

Size Small (range) _____ Medium (range) _____ Large (range) _____ Representative size: e.g. 2 x 1 x 2 cmz

Wall Facing:

Opus quadratum Opus incertum Opus reticulatum Petit appareil Opus testaceum Opus mixtum Opus vittatum Other (specify)

Complete this section for foundations Faced foundation Wooden shuttering No shuttering

floor/revetment type

Floor type: Beaten Earth Opus signinum Opus scutulatum Opus Sectile Mosaic Opus spicatum Other (specify) Large tufo slabs

Wall finishing Stucco Opus signinum Plaster Painted Plaster Other (specify)

→ Approx. length, width, height of structural remains:

Description:

Paving comprised of large, rectangular tufo slabs arranged roughly in lines of 7 slabs E-W, 3 N-S, with lengths running N-S. On SE corner, E, + part of N sides, there is a raised lip running around the outside of the paving. Depth of slabs unknown. 1-2 slabs missing in S part, remains of one may be visible standing at an angle.

Sketch (if applicable, indicate North)

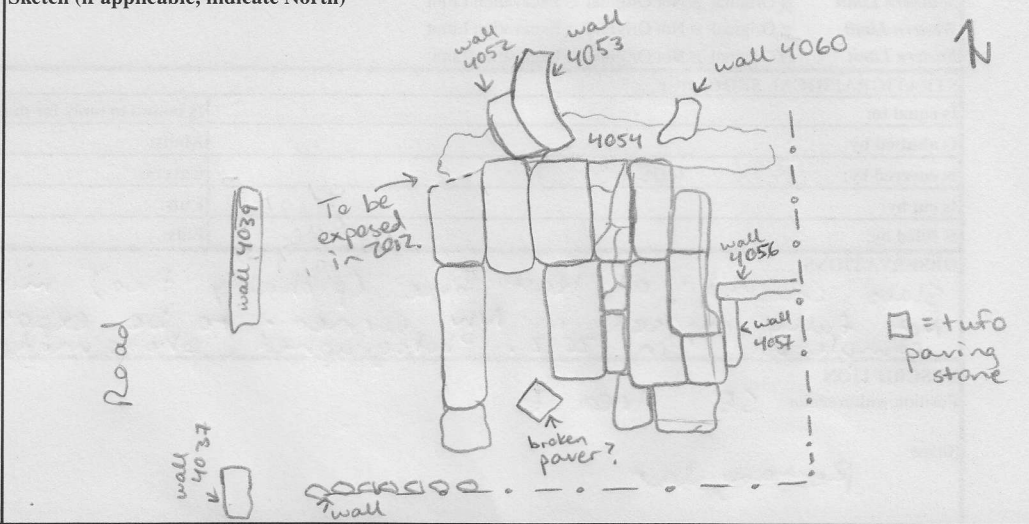

INTERPRETATION

Large area of monumental tufo paving slabs in SE-most corner of Area E. Covered on N by partially exposed layer 4054. S extent uncertain in places - SE corner probably original because of raised lip on tufo paver, but rest possibly truncated. 1-2 slabs may be missing in SW, with one slanted tufo block possibly a broken paving stone. W extent appears to be original, though NW corner remains to be exposed in 2012. E side at least partially truncated + walls 4056 + 4057 most likely covered the paving stones here (raised lip on E edge of slabs here may be related to these walls). Function of paved space + relationship with layer 4054 + the circular structure to the N (4050-4053, 4060) uncertain.

SOIL SAMPLING: Yes No

Total volume of layer (buckets):

Sample quantity (buckets):

Sample fraction (%):

NON SOIL SAMPLES: Yes No

If yes, specify (e.g. charcoal, mortar etc.):

Size:

SIEVING: Yes No

Total volume of layer (buckets):

Sample quantity (buckets):

Sample fraction (%):

STRATIGRAPHICAL RELIABILITY

Good Fair Poor

Filled-out by E. Adkins

on 2.8.2011

Revised by E. Adkins

on 3.8.2011

PDFd by EUR

on 4.8.2011

Entered by

on