

SITE	YEAR	AREA	SECTOR	ELEVATION	STRATIGRAPHICAL UNIT
GPR	2012	F		Min: 53.1667 Max: 65.146	5003 <input type="checkbox"/> Natural <input checked="" type="checkbox"/> Anthropic

In cross-section? Yes No In elevation drawing? Yes No Photos: Yes No # 23110-17 Photo Model: Yes No #:

DEFINITION: Irregular modern (?) cut bounded by 5010

HOW IS LAYER DISTINGUISHED? Color Composition Compaction

FORMATION PROCESS: Accumulation Construction Cutting Erosion Collapse Intentional deposition

INCLUSIONS For each inclusion specify frequency: (f)requent, (m)edium, (r)are

Anthropic	Geological	Organic	SOIL/MATRIX				
<input type="checkbox"/> Pottery <input type="checkbox"/> Nails <input type="checkbox"/> Tiles <input type="checkbox"/> Marble <input type="checkbox"/> Amphorae <input type="checkbox"/> Quarried debris <input type="checkbox"/> Dolia <input type="checkbox"/> Slag <input type="checkbox"/> Brick <input type="checkbox"/> Mosaic tiles(s) <input type="checkbox"/> Basalt slabs <input type="checkbox"/> Mortar <input type="checkbox"/> Opus signinum <input type="checkbox"/> Coins <input type="checkbox"/> Painted plaster <input type="checkbox"/> Metal (specify) <input type="checkbox"/> Burnt Adobe <input type="checkbox"/> Collapse debris <input type="checkbox"/> Other (specify) <input type="checkbox"/> Glass	<input type="checkbox"/> Tuffs (specify) <input type="checkbox"/> Travertine <input type="checkbox"/> Other Limestone <input type="checkbox"/> Basalt <input type="checkbox"/> Clay <input type="checkbox"/> Sand <input type="checkbox"/> Silt <input type="checkbox"/> Pebbles (range) <input type="checkbox"/> Gravel (range)	<input type="checkbox"/> Charcoal <input type="checkbox"/> Ash <input type="checkbox"/> Animal bones <input type="checkbox"/> Human bones <input type="checkbox"/> Animal teeth <input type="checkbox"/> Human teeth <input type="checkbox"/> Shells <input type="checkbox"/> Other (specify)	clay ___% silt ___% sand ___% <input type="checkbox"/> Granular <input type="checkbox"/> Layered <input type="checkbox"/> Cohesive <table border="1"> <tr> <th>Compaction</th> <th>Color</th> </tr> <tr> <td> <input type="checkbox"/> Hard <input type="checkbox"/> Compact <input type="checkbox"/> Friable <input type="checkbox"/> Loose <input type="checkbox"/> Soft </td> <td> <input type="checkbox"/> Black <input type="checkbox"/> Brown <input type="checkbox"/> Gray <input type="checkbox"/> Light Brown <input type="checkbox"/> Light Gray <input type="checkbox"/> White <input type="checkbox"/> Yellow <input type="checkbox"/> Red <input type="checkbox"/> Light Yellow <input type="checkbox"/> Other (specify) </td> </tr> </table>	Compaction	Color	<input type="checkbox"/> Hard <input type="checkbox"/> Compact <input type="checkbox"/> Friable <input type="checkbox"/> Loose <input type="checkbox"/> Soft	<input type="checkbox"/> Black <input type="checkbox"/> Brown <input type="checkbox"/> Gray <input type="checkbox"/> Light Brown <input type="checkbox"/> Light Gray <input type="checkbox"/> White <input type="checkbox"/> Yellow <input type="checkbox"/> Red <input type="checkbox"/> Light Yellow <input type="checkbox"/> Other (specify)
Compaction	Color						
<input type="checkbox"/> Hard <input type="checkbox"/> Compact <input type="checkbox"/> Friable <input type="checkbox"/> Loose <input type="checkbox"/> Soft	<input type="checkbox"/> Black <input type="checkbox"/> Brown <input type="checkbox"/> Gray <input type="checkbox"/> Light Brown <input type="checkbox"/> Light Gray <input type="checkbox"/> White <input type="checkbox"/> Yellow <input type="checkbox"/> Red <input type="checkbox"/> Light Yellow <input type="checkbox"/> Other (specify)						

UNIT LIMITS (also indicate on overlay)

Northern Limit: Original Not Original Excavation Limit Depth: Original Not Original

Southern Limit: Original Not Original Excavation Limit

Western Limit: Original Not Original Excavation Limit

Eastern Limit: Original Not Original Excavation Limit

STRATIGRAPHICAL SEQUENCE

Is equal to: _____ Is bound to (only for masonry): _____

Is abuted by: _____ Abuts: _____

Is covered by: _____ Covers: _____

Is cut by: _____ Cuts: 5052

Is filled by: 5002 Fills: _____

OBSERVATIONS: Hot sunny day.

DESCRIPTION

Position within sector: NW of Area F

Shape: Roughly rectangular

For layers complete this section:

Surface (slope direction, visible inclusions): _____

Observations about inclusions (Clusters? Deposition slope): _____

Observations about thickness (Increases? Decreases?): _____

Nature of the interface with layer below: sharp diffuse commingled other (specify)

For cuts complete this section:

Cut edge: rounded straight

Cut sides: straight concave convex sloping

Cut bottom: flat concave irregular - not reached

How is cut top edge?: sharp rounded

How is cut bottom edge?: sharp rounded - not reached

Observations: The bottom of the cut has not been defined because the fill has not been completely removed.

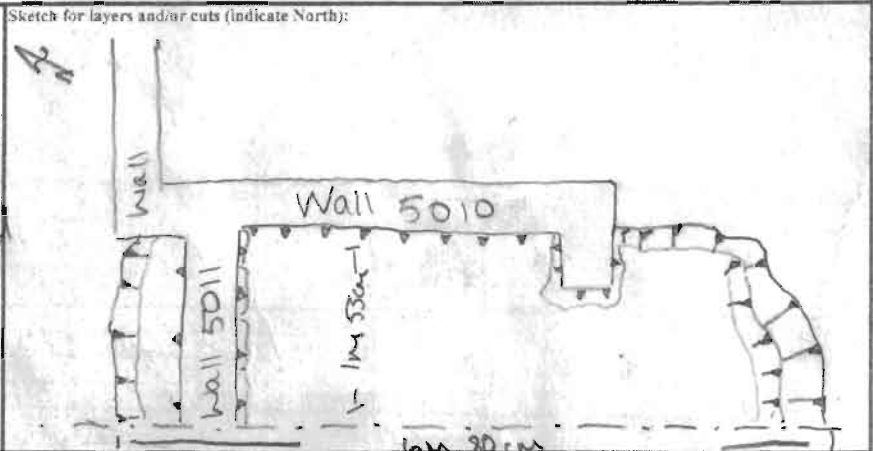

For structural remains complete this section

Alignment:

Building Technique: Adobe/Mud-brick Ashlar (blocks) Irregular (unworked) stone Concrete Other (specify)

Binding Agent: None Clay Mortar (if so, specify composition, color, compaction)

Concrete inclusions:

Material: Tufo Basalt Travertine Tiles Other (specify)

Size: Small (range) _____ Medium (range) _____ Large (range) _____ Representative size, e.g. 2 x 1 x 2 cm

Wall Facing:

Opus quadratum Opus incertum Opus reticulatum Petit appareil Opus testaceum Opus mixtum Opus vittatum Other (specify)

Complete this section for foundations Faced foundation Wooden shuttering No shuttering

Floor/revetment type

Floor type: Beaten Earth Opus signinum Opus scintillatum Opus Sectile Mosaic Opus spicatum Other (specify)

Wall finishing: Stucco Opus signinum Plaster Painted Plaster Other (specify)

Approx. length, width, height of structural remains.

Description:

Sketch (if applicable, indicate North)

INTERPRETATION

Post abandonment cut. Possibly robbers or antiquarian. Cut is much deeper on Southern side of wall 5011, likely because southern side is interior. See 5002 for further explanation

SOIL SAMPLING: Yes No

Total volume of layer (buckets):

Sample quantity (buckets):

Sample fractions (%):

NON SOIL SAMPLES: Yes No

If yes, specify (e.g. charcoal, mortar etc.):

Size:

SIEVING: Yes No

Total volume of layer (buckets):

Sample quantity (buckets):

Sample fractions (%):

STRATIGRAPHICAL RELIABILITY

Good Fair Poor

Filled-out by

Revised by

POF'd by

Entered by

on

on

on

on

3-7-12

6-7-12

8-7-12

MS

J. Small

ECR

AP