



SITE GPR	YEAR 2012	AREA F	SECTOR	ELEVATION Min: 64.0114 Max: 64.9232	STRATIGRAPHICAL UNIT 5088 <input type="checkbox"/> Natural <input checked="" type="checkbox"/> Anthropic	 	
	In cross-section? <input type="checkbox"/> Yes <input type="checkbox"/> No		In elevation drawing? <input type="checkbox"/> Yes <input type="checkbox"/> No		Photos: <input checked="" type="checkbox"/> Yes <input type="checkbox"/> No #: 2436-37		Photo Model: <input type="checkbox"/> Yes <input type="checkbox"/> No #:
DEFINITION Eastern of three buttresses against wall 5009 (others are 5089, 5084)					Covered by 5091 <input checked="" type="checkbox"/> SU: 5091	Fills <input type="checkbox"/> SU:	Filled by <input type="checkbox"/> SU:
HOW IS LAYER DISTINGUISHED? <input type="checkbox"/> Color <input type="checkbox"/> Composition <input type="checkbox"/> Compaction			FORMATION PROCESS <input type="checkbox"/> Accumulation <input checked="" type="checkbox"/> Construction <input type="checkbox"/> Cutting <input type="checkbox"/> Erosion <input type="checkbox"/> Collapse <input type="checkbox"/> Intentional deposition				
INCLUSIONS For each inclusion specify frequency: (f)requent, (m)edium, (r)are					SOIL/MATRIX		
Anthropic		Geological		Organic	clay ___% silt ___% sand ___%		
<input type="checkbox"/> Pottery <input type="checkbox"/> Nails <input type="checkbox"/> Tiles <input type="checkbox"/> Marble <input type="checkbox"/> Amphorac <input type="checkbox"/> Quarried debris <input type="checkbox"/> Dolia <input type="checkbox"/> Slag <input type="checkbox"/> Brick <input type="checkbox"/> Mosaic tile(s) <input type="checkbox"/> Basalt slabs <input checked="" type="checkbox"/> Mortar f <input type="checkbox"/> Opus signinum <input type="checkbox"/> Coins <input type="checkbox"/> Painted plaster <input type="checkbox"/> Metal (specify) <input type="checkbox"/> Burnt Adobe <input type="checkbox"/> Collapse debris <input type="checkbox"/> Other (specify) <input type="checkbox"/> Glass		<input checked="" type="checkbox"/> Tufo (specify) f <input type="checkbox"/> Travertine <input type="checkbox"/> Other Limestone <input type="checkbox"/> Basalt <input type="checkbox"/> Clay <input type="checkbox"/> Sand <input type="checkbox"/> Silt <input type="checkbox"/> Pebbles (range) <input type="checkbox"/> Gravel (range)		<input type="checkbox"/> Charcoal <input type="checkbox"/> Ash <input type="checkbox"/> Animal bones <input type="checkbox"/> Human bones <input type="checkbox"/> Animal teeth <input type="checkbox"/> Human teeth <input type="checkbox"/> Shells <input type="checkbox"/> Other (specify)	<input type="checkbox"/> Granular <input type="checkbox"/> Layered <input type="checkbox"/> Cohesive  <b>Compaction</b> <input type="checkbox"/> Hard <input type="checkbox"/> Compact <input type="checkbox"/> Friable <input type="checkbox"/> Loose <input type="checkbox"/> Soft		
					<b>Color</b> <input type="checkbox"/> Black <input type="checkbox"/> Brown <input type="checkbox"/> Gray <input type="checkbox"/> Light Brown <input type="checkbox"/> Light Gray <input type="checkbox"/> White <input type="checkbox"/> Yellow <input type="checkbox"/> Red <input type="checkbox"/> Light Yellow <input type="checkbox"/> Other (specify)		
UNIT LIMITS (also indicate on overlay)							
Northern Limit <input checked="" type="checkbox"/> Original <input type="checkbox"/> Not Original <input type="checkbox"/> Excavation Limit				Depth: <input checked="" type="checkbox"/> Original <input type="checkbox"/> Not Original			
Southern Limit <input checked="" type="checkbox"/> Original <input type="checkbox"/> Not Original <input type="checkbox"/> Excavation Limit							
Western Limit <input checked="" type="checkbox"/> Original <input type="checkbox"/> Not Original <input type="checkbox"/> Excavation Limit							
Eastern Limit <input checked="" type="checkbox"/> Original <input type="checkbox"/> Not Original <input type="checkbox"/> Excavation Limit							
STRATIGRAPHICAL SEQUENCE							
Is equal to:				Is bound to (only for masonry): wall SU 5009			
Is abutted by:				Abuts:			
Is covered by: 5091				Covers:			
Is cut by:				Cuts:			
Is filled by:				Fills:			
OBSERVATIONS Gray tufo blocks bonded with mortar to create buttress. Large blocks of tufo used in the preserved section protruding from the wall; smaller pieces of tufo seen used in the wall. Not as well preserved as SU 5089.							
DESCRIPTION Position within sector: Northeast of Area F; south of wall SU 5009. Shape: The section protruding from the wall is square; what remains of it on the wall (SU 5009) is irregular.							
For layers complete this section: Surface (slope direction; visible inclusions): Observations about inclusions (Clusters? Deposition slope): Observations about thickness (Increases? Decreases?): Nature of the interface with layer below: <input type="checkbox"/> sharp <input type="checkbox"/> diffuse <input type="checkbox"/> commingled <input type="checkbox"/> other (specify)							
For cuts complete this section: Cut edges: <input type="checkbox"/> rounded <input type="checkbox"/> straight Cut sides: <input type="checkbox"/> straight <input type="checkbox"/> concave <input type="checkbox"/> convex <input type="checkbox"/> sloping Cut bottom: <input type="checkbox"/> flat <input type="checkbox"/> concave <input type="checkbox"/> irregular How is cut top edge? <input type="checkbox"/> sharp <input type="checkbox"/> rounded How is cut bottom edge? <input type="checkbox"/> sharp <input type="checkbox"/> rounded Observations:				Sketch for layers and/or cuts (indicate North):			

**For structural remains complete this section**

Alignment: **N-S/E-W**

Building Technique:  Adobe/Mud-brick  Ashlar (blocks)  Irregular (unworked) stone  Concrete  Other (specify)

Binding Agent:  None  Clay  Mortar (if so, specify composition, color, compaction)  
*white; crumbles easily*

Concrete inclusions:

Material:  Tufo  Basalt  Travertine  Tiles  Other (specify)  
 Size:  Small (range) \_\_\_\_\_  Medium (range) \_\_\_\_\_  Large (range) \_\_\_\_\_ Representative size: e.g. 2 x 1 x 2 cmz

Wall Facing:

Opus quadratum  Opus incertum  Opus reticulatum  Petit appareil  Opus testaceum  Opus mixtum  Opus vittatum  Other (specify)

Complete this section for foundations  Faced foundation  Wooden shuttering  No shuttering

Floor/revetment type

Floor type:  Beaten Earth  Opus signinum  Opus scutulatum  Opus Sectile  Mosaic  Opus spicatum  Other (specify)

Wall finishing  Stucco  Opus signinum  Plaster  Painted Plaster  Other (specify)

Approx. length, width, height of structural remains:

**l = 67cm, w = 48cm, h = 63cm**

Description:

Buttress built into the sub-ashlar wall (SU 5009) using tufo blocks (of different sizes and shapes) bound together with mortar. Its construction technique differs from the wall. The visible tufo appears to be all of the same kind - gray. Not as well preserved as the westernmost buttress SU 5089.

Sketch (if applicable, indicate North)

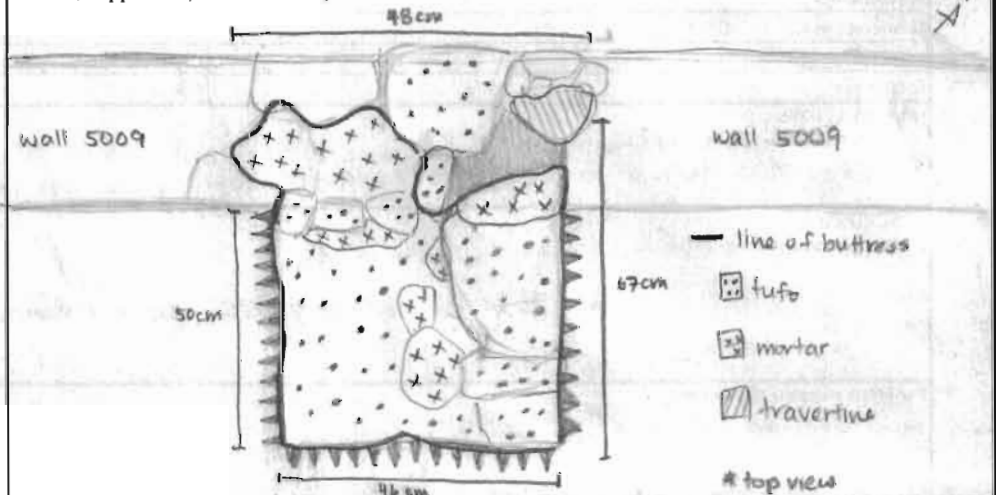

**INTERPRETATION**

This buttress (one of three, the others are SU 5084 and SU 5089) appears to have been built after the construction of wall SU 5009 to provide support and to prevent the wall from falling over. (The wall leans to the south.) Construction technique and material is similar to SU 5084 and SU 5088 - they <sup>may</sup> ~~must~~ have all been built around the same time.

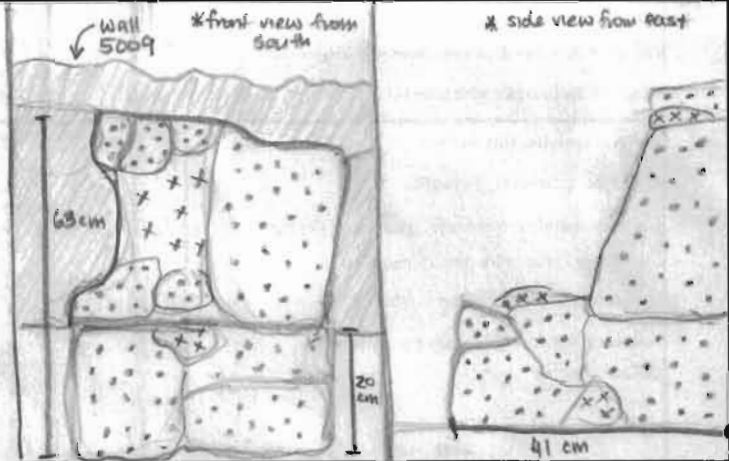

SOIL SAMPLING:  Yes  No

Total volume of layer (buckets):

Sample quantity (buckets):

Sample fraction (%):

NON SOIL SAMPLES:  Yes  No

If yes, specify (e.g. charcoal, mortar etc.):

Size:

SIEVING:  Yes  No

Total volume of layer (buckets):

Sample quantity (buckets):

Sample fraction (%):

**STRATIGRAPHICAL RELIABILITY**

Good  Fair  Poor

Filled-out by	<b>C. Cha</b>	on	<b>24/07/2012</b>
Revised by	<b>J.S.</b>	on	<b>25/7/2012</b>
PDFd by	<b>GP</b>	on	<b>27.9.2012</b>
Entered by		on	