



SITE GPR	YEAR 2002	AREA F	SECTOR	ELEVATION Min: Max:	STRATIGRAPHICAL UNIT 5123 <input type="checkbox"/> Natural <input checked="" type="checkbox"/> Anthropic	 Gabii Project
In cross-section? <input type="checkbox"/> Yes <input checked="" type="checkbox"/> No		In elevation drawing? <input type="checkbox"/> Yes <input checked="" type="checkbox"/> No		Photos: <input checked="" type="checkbox"/> Yes <input type="checkbox"/> No #:	2442-44	Photo Model: <input checked="" type="checkbox"/> Yes <input type="checkbox"/> No #: 421
DEFINITION Header of wall on W side of 5007				Covered by <input type="checkbox"/> SU:	Fills <input checked="" type="checkbox"/> SU: 5051	Filled by <input type="checkbox"/> SU:
HOW IS LAYER DISTINGUISHED? <input type="checkbox"/> Color <input type="checkbox"/> Composition <input type="checkbox"/> Compaction			FORMATION PROCESS <input type="checkbox"/> Accumulation <input checked="" type="checkbox"/> Construction <input type="checkbox"/> Cutting <input type="checkbox"/> Erosion <input type="checkbox"/> Collapse <input type="checkbox"/> Intentional deposition			
INCLUSIONS For each inclusion specify frequency: (f)requent, (m)edium, (r)are					SOIL/MATRIX	
Anthropic		Geological		Organic		clay ___% silt ___% sand ___%
<input type="checkbox"/> Pottery <input type="checkbox"/> Nails <input type="checkbox"/> Tiles <input type="checkbox"/> Marble <input type="checkbox"/> Amphorae <input type="checkbox"/> Quarried debris <input type="checkbox"/> Dolia <input type="checkbox"/> Slag <input type="checkbox"/> Brick <input type="checkbox"/> Mosaic tile(s) <input type="checkbox"/> Basalt slabs <input type="checkbox"/> Mortar <input type="checkbox"/> Opus signinum <input type="checkbox"/> Coins <input type="checkbox"/> Painted plaster <input type="checkbox"/> Metal (specify) <input type="checkbox"/> Burnt Adobe <input type="checkbox"/> Collapse debris <input type="checkbox"/> Other (specify) <input type="checkbox"/> Glass		<input type="checkbox"/> Tufo (specify) <input type="checkbox"/> Travertine <input type="checkbox"/> Other Limestone <input type="checkbox"/> Basalt <input type="checkbox"/> Clay <input type="checkbox"/> Sand <input type="checkbox"/> Silt <input type="checkbox"/> Pebbles (range) <input type="checkbox"/> Gravel (range)		<input type="checkbox"/> Charcoal <input type="checkbox"/> Ash <input type="checkbox"/> Animal bones <input type="checkbox"/> Human bones <input type="checkbox"/> Animal teeth <input type="checkbox"/> Human teeth <input type="checkbox"/> Shells <input type="checkbox"/> Other (specify)		<input type="checkbox"/> Granular <input type="checkbox"/> Layered <input type="checkbox"/> Cohesive Compaction <input type="checkbox"/> Hard <input type="checkbox"/> Compact <input type="checkbox"/> Friable <input type="checkbox"/> Loose <input type="checkbox"/> Soft Color <input type="checkbox"/> Black <input type="checkbox"/> Brown <input type="checkbox"/> Gray <input type="checkbox"/> Light Brown <input type="checkbox"/> Light Gray <input type="checkbox"/> White <input type="checkbox"/> Yellow <input type="checkbox"/> Red <input type="checkbox"/> Light Yellow <input type="checkbox"/> Other (specify)
UNIT LIMITS (also indicate on overlay)						
Northern Limit		<input checked="" type="checkbox"/> Original <input type="checkbox"/> Not Original <input type="checkbox"/> Excavation Limit		Depth: <input type="checkbox"/> Original <input checked="" type="checkbox"/> Not Original		
Southern Limit		<input checked="" type="checkbox"/> Original <input type="checkbox"/> Not Original <input type="checkbox"/> Excavation Limit				
Western Limit		<input checked="" type="checkbox"/> Original <input type="checkbox"/> Not Original <input type="checkbox"/> Excavation Limit				
Eastern Limit		<input checked="" type="checkbox"/> Original <input type="checkbox"/> Not Original <input type="checkbox"/> Excavation Limit				
STRATIGRAPHICAL SEQUENCE						
Is equal to: 5125, 5136				Is bound to (only for masonry):		
Is abutted by:				Abuts: 5007		
Is covered by: 5138				Covers:		
Is cut by:				Cuts:		
Is filled by:				Fills: 5051		
OBSERVATIONS						
DESCRIPTION						
Position within sector: Southern edge of Area F, west of wall 5007. oriented N-S lengthwise						
Shape: Rectangular						
For layers complete this section:						
Surface (slope direction; visible inclusions):						
Observations about inclusions (Clusters? Deposition slope):						
Observations about thickness (Increases? Decreases?):						
Nature of the interface with layer below: <input type="checkbox"/> sharp <input type="checkbox"/> diffuse <input type="checkbox"/> commingled <input type="checkbox"/> other (specify)						
For cuts complete this section:			Sketch for layers and/or cuts (indicate North):			
Cut edges: <input type="checkbox"/> rounded <input type="checkbox"/> straight			Ashlar blocks: view from 5050/5051			
Cut sides: <input type="checkbox"/> straight <input type="checkbox"/> concave <input type="checkbox"/> convex <input type="checkbox"/> sloping						
Cut bottom: <input type="checkbox"/> flat <input type="checkbox"/> concave <input type="checkbox"/> irregular						
How is cut top edge? <input type="checkbox"/> sharp <input type="checkbox"/> rounded						
How is cut bottom edge? <input type="checkbox"/> sharp <input type="checkbox"/> rounded						
Observations:						

- surface covered by soil/silt
 - wear consistent w/ use of tong crane
 - chisel markings

For structural remains complete this section

Alignment: **N-S**

Building Technique: Adobe/Mud-brick Ashlar (blocks) irregular (unworked) stone Concrete Other (specify)

Binding Agent: None Clay Mortar (if so, specify composition, color, compaction)

Concrete inclusions:

Material Tufo Basalt Travertine Tiles Other (specify)
 Size Small (range) _____ Medium (range) _____ Large (range) _____ Representative size: e.g. 2 x 1 x 2 cmz

NIA

Wall Facing:

Opus quadratum Opus incertum Opus reticulatum Petit appareil Opus testaceum Opus mixtum Opus vittatum Other (specify)

Complete this section for foundations Faced foundation Wooden shuttering No shuttering

NIA

floor/revetment type

Floor type: Beaten Earth Opus signinum Opus scutulatum Opus Sectile Mosaic Opus spicatum Other (specify)

Wall finishing Stucco Opus signinum Plaster Painted Plaster Other (specify)

NIA

Approx. length, width, height of structural remains: (cm)

102 x 56 x 42

Description:

two ashlar blocks visible (stacked) of orange tufo
 Note: Wall 5007 has grey tufo blocks

Sketch (if applicable, indicate North)

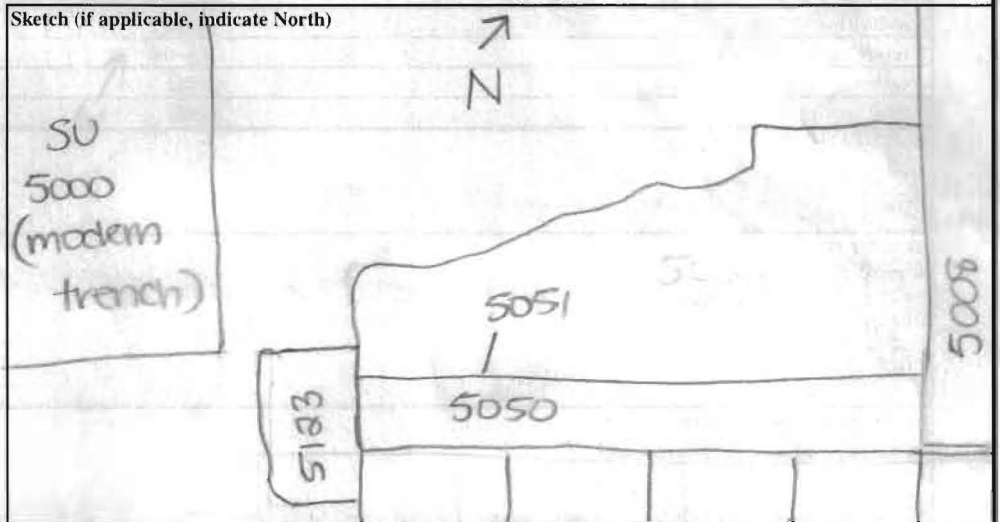

INTERPRETATION

5123 is the header to the west of wall 5007. It is oriented N-S and was likely used to support 5007. The upper block shows holes/wear on opposing visible faces consistent w/ those used in conjunction w/ long cranes. 5123 corresponds with a similar orange tufo header (SU 5125) in Wall 5006. Interesting orange-grey header-stretcher effect likely visible on the southern face of the terracing wall.

SOIL SAMPLING: <input type="checkbox"/> Yes <input checked="" type="checkbox"/> No Total volume of layer (buckets): Sample quantity (buckets): Sample fraction (%):	NON SOIL SAMPLES: <input type="checkbox"/> Yes <input checked="" type="checkbox"/> No If yes, specify (e.g. charcoal, mortar etc.): Size:	SIEVING: <input type="checkbox"/> Yes <input checked="" type="checkbox"/> No Total volume of layer (buckets): Sample quantity (buckets): Sample fraction (%):
---	--	---

STRATIGRAPHICAL RELIABILITY <input checked="" type="checkbox"/> Good <input type="checkbox"/> Fair <input type="checkbox"/> Poor	Filled-out by Shalini Kulkarni on July 24, 2012
	Revised by J.S on 30 7.12
	PDFd by _____ on _____
	Entered by _____ on _____