

SITE GPR	YEAR 2012	AREA F	SECTOR	ELEVATION Min: Max:	STRATIGRAPHICAL UNIT 5146 <input type="checkbox"/> Natural <input checked="" type="checkbox"/> Anthropic	
In cross-section? <input type="checkbox"/> Yes <input checked="" type="checkbox"/> No		In elevation drawing? <input type="checkbox"/> Yes <input checked="" type="checkbox"/> No		Photos: <input type="checkbox"/> Yes <input type="checkbox"/> No #: 2745-47	Photo Model: <input type="checkbox"/> Yes <input checked="" type="checkbox"/> No #:	
DEFINITION rubble wall south of B-house				Covered by <input checked="" type="checkbox"/> SU: 0	Fills <input type="checkbox"/> SU:	Filled by <input type="checkbox"/> SU:
HOW IS LAYER DISTINGUISHED? <input type="checkbox"/> Color <input type="checkbox"/> Composition <input type="checkbox"/> Compaction			FORMATION PROCESS <input type="checkbox"/> Accumulation <input checked="" type="checkbox"/> Construction <input type="checkbox"/> Cutting <input type="checkbox"/> Erosion <input type="checkbox"/> Collapse <input type="checkbox"/> Intentional deposition			
INCLUSIONS For each inclusion specify frequency: (frequent, (m)edium, (r)are)				SOIL/MATRIX clay ___% silt ___% sand ___% <input type="checkbox"/> Granular <input type="checkbox"/> Layered <input type="checkbox"/> Cohesive		
Anthropic		Geological		Organic		Compaction <input type="checkbox"/> Hard <input type="checkbox"/> Compact <input type="checkbox"/> Friable <input type="checkbox"/> Loose <input type="checkbox"/> Soft
<input type="checkbox"/> Pottery <input type="checkbox"/> Tiles <input type="checkbox"/> Amphorae <input type="checkbox"/> Dolia <input type="checkbox"/> Mosaic tile(s) <input type="checkbox"/> Mortar <input type="checkbox"/> Coins <input type="checkbox"/> Metal (specify) <input type="checkbox"/> Collapse debris <input type="checkbox"/> Glass		<input type="checkbox"/> Nails <input type="checkbox"/> Marble <input type="checkbox"/> Quarried debris <input type="checkbox"/> Slag <input type="checkbox"/> Brick <input type="checkbox"/> Basalt slabs <input type="checkbox"/> Opus signinum <input type="checkbox"/> Painted plaster <input type="checkbox"/> Burnt Adobe <input type="checkbox"/> Other (specify)		<input type="checkbox"/> Tufo (specify) <input type="checkbox"/> Travertine <input type="checkbox"/> Other Limestone <input type="checkbox"/> Basalt <input type="checkbox"/> Clay <input type="checkbox"/> Sand <input type="checkbox"/> Silt <input type="checkbox"/> Pebbles (range) <input type="checkbox"/> Gravel (range)		
						Color <input type="checkbox"/> Black <input type="checkbox"/> Brown <input type="checkbox"/> Gray <input type="checkbox"/> Light Brown <input type="checkbox"/> Light Gray <input type="checkbox"/> White <input type="checkbox"/> Yellow <input type="checkbox"/> Red <input type="checkbox"/> Light Yellow <input type="checkbox"/> Other (specify)
UNIT LIMITS (also indicate on overlay)						Depth: <input type="checkbox"/> Original <input checked="" type="checkbox"/> Not Original
Northern Limit		<input type="checkbox"/> Original <input type="checkbox"/> Not Original <input type="checkbox"/> Excavation Limit				
Southern Limit		<input type="checkbox"/> Original <input type="checkbox"/> Not Original <input checked="" type="checkbox"/> Excavation Limit				
Western Limit		<input checked="" type="checkbox"/> Original <input type="checkbox"/> Not Original <input type="checkbox"/> Excavation Limit				
Eastern Limit		<input checked="" type="checkbox"/> Original <input type="checkbox"/> Not Original <input type="checkbox"/> Excavation Limit				
STRATIGRAPHICAL SEQUENCE						
Is equal to:				Is bound to (only for masonry):		
Is abuted by:				Abuts:		
Is covered by:				Covers:		
Is cut by:				Cuts:		
Is filled by:				Fills:		
OBSERVATIONS wall was excavated previously by the Italian state archaeology and it's connection with our excavation got clearer in 2012						
DESCRIPTION Position within sector: south-eastern edge of trench F						
Shape: linear						
For layers complete this section: Surface (slope direction, visible inclusions): Observations about inclusions (Clusters? Deposition slope): Observations about thickness (Increases? Decreases?): Nature of the interface with layer below: <input type="checkbox"/> sharp <input type="checkbox"/> diffuse <input type="checkbox"/> commingled <input type="checkbox"/> other (specify):						
For cuts complete this section: Cut edges: <input type="checkbox"/> rounded <input type="checkbox"/> straight Cut sides: <input type="checkbox"/> straight <input type="checkbox"/> concave <input type="checkbox"/> convex <input type="checkbox"/> sloping Cut bottom: <input type="checkbox"/> flat <input type="checkbox"/> concave <input type="checkbox"/> irregular How is cut top edge? <input type="checkbox"/> sharp <input type="checkbox"/> rounded How is cut bottom edge? <input type="checkbox"/> sharp <input type="checkbox"/> rounded Observations:				Sketch for layers and/or cuts (indicate North):		

For structural remains complete this section

Alignment:

Building Technique: Adobe/Mud-brick Ashlar (blocks) Irregular (unworked) stone Concrete Other (specify)

Binding Agent: None Clay Mortar (if so, specify composition, color, compaction)

greyish, difficult to judge since it has been restored by Italian workmen

Concrete inclusions:

Material: Tufo Basalt Travertine Tiles Other (specify)
 Size: Small (range) _____ Medium (range) _____ Large (range) _____ Representative size: e.g. 2 x 1 x 2 cmz

Wall Facing:

Opus quadratum Opus incertum Opus reticulatum Petit appareil Opus testaceum Opus mixtum Opus vittatum Other (specify)

Complete this section for foundations Faced foundation Wooden shuttering No shuttering

Floor/revetment type

Floor type: Beaten Earth Opus signinum Opus scutulatum Opus Sectile Mosaic Opus spicatum Other (specify)

Wall finishing: Stucco Opus signinum Plaster Painted Plaster Other (specify)

Approx. length, width, height of structural remains:

*Ca. 13,5 m of wall within our excavation permit
 width: Ca. 1,50m, height: 0,91m*

Description:

Sketch (if applicable, indicate North)

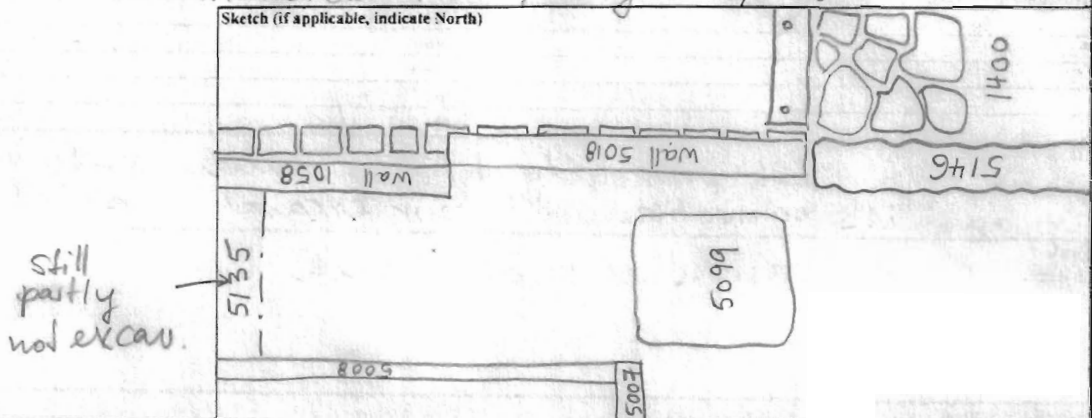

INTERPRETATION

Retaining wall for a street, heavily restored and excavated without stratigraphical recording. Therefore it is difficult to assume it's original state.

SOIL SAMPLING: Yes No

Total volume of layer (buckets):

Sample quantity (buckets):

Sample fraction (%):

NON SOIL SAMPLES: Yes No

If yes, specify (e.g. charcoal, mortar etc.):

Size:

SIEVING: Yes No

Total volume of layer (buckets):

Sample quantity (buckets):

Sample fraction (%):

STRATIGRAPHICAL RELIABILITY

Good Fair Poor

Filled-out by: *CMH*

Revised by: *CMH*

PDFd by:

Entered by:

on: *30.7.2012*

on: *1.9.2012*

on:

on: