

SITE	YEAR	AREA	SECTOR	ELEVATION	STRATIGRAPHICAL UNIT	University of Michigan Gabiil Project	
GPR	2013	F		Min: 62.0335 Max: 62.1315	5152 <input type="checkbox"/> Natural <input checked="" type="checkbox"/> Anthropic		
In cross-section? <input type="checkbox"/> Yes <input checked="" type="checkbox"/> No			In elevation drawing? <input type="checkbox"/> Yes <input checked="" type="checkbox"/> No		Photos: <input checked="" type="checkbox"/> Yes <input type="checkbox"/> No #: 3139-40	Photo Model: <input checked="" type="checkbox"/> Yes <input type="checkbox"/> No #: #34	
DEFINITION Single block partially dislodged from wall 5006					Covered by <input checked="" type="checkbox"/> SU: 5109	Fills <input type="checkbox"/> SU:	Filled by <input type="checkbox"/> SU:
HOW IS LAYER DISTINGUISHED? <input checked="" type="checkbox"/> Color <input checked="" type="checkbox"/> Composition <input checked="" type="checkbox"/> Compaction			FORMATION PROCESS <input type="checkbox"/> Accumulation <input checked="" type="checkbox"/> Construction <input type="checkbox"/> Cutting <input type="checkbox"/> Erosion <input type="checkbox"/> Collapse <input type="checkbox"/> Intentional deposition				
INCLUSIONS For each inclusion specify frequency: (f)requent, (m)edium, (r)are					SOIL/MATRIX		
Anthropic		Geological		Organic		clay % silt % sand %	
<input type="checkbox"/> Pottery <input type="checkbox"/> Tiles <input type="checkbox"/> Amphorae <input type="checkbox"/> Dolia <input type="checkbox"/> Mosaic tile(s) <input type="checkbox"/> Mortar <input type="checkbox"/> Coins <input type="checkbox"/> Metal (specify) <input type="checkbox"/> Collapse debris <input type="checkbox"/> Glass		<input type="checkbox"/> Nails <input type="checkbox"/> Marble <input type="checkbox"/> Quarried debris <input type="checkbox"/> Slag <input type="checkbox"/> Brick <input type="checkbox"/> Basalt slabs <input type="checkbox"/> Opus signinum <input type="checkbox"/> Painted plaster <input type="checkbox"/> Burnt Adobe <input type="checkbox"/> Other (specify)		<input checked="" type="checkbox"/> Tufo (specify) GRAY <input type="checkbox"/> Travertine <input type="checkbox"/> Other Limestone <input type="checkbox"/> Basalt <input type="checkbox"/> Clay <input type="checkbox"/> Sand <input type="checkbox"/> Silt <input type="checkbox"/> Pebbles (range) <input type="checkbox"/> Gravel (range)		<input type="checkbox"/> Charcoal <input type="checkbox"/> Ash <input type="checkbox"/> Animal bones <input type="checkbox"/> Human bones <input type="checkbox"/> Animal teeth <input type="checkbox"/> Human teeth <input type="checkbox"/> Shells <input type="checkbox"/> Other (specify)	
					<input type="checkbox"/> Granular <input type="checkbox"/> Layered <input checked="" type="checkbox"/> Cohesive		
					Compaction <input type="checkbox"/> Hard <input type="checkbox"/> Compact <input type="checkbox"/> Friable <input type="checkbox"/> Loose <input type="checkbox"/> Soft		Color <input type="checkbox"/> Black <input type="checkbox"/> Brown <input type="checkbox"/> Gray <input type="checkbox"/> Light Brown <input type="checkbox"/> Light Gray <input type="checkbox"/> White <input type="checkbox"/> Yellow <input type="checkbox"/> Red <input type="checkbox"/> Light Yellow <input type="checkbox"/> Other (specify)
UNIT LIMITS (also indicate on overlay)							
Northern Limit		<input checked="" type="checkbox"/> Original <input type="checkbox"/> Not Original <input type="checkbox"/> Excavation Limit				Depth: <input checked="" type="checkbox"/> Original <input type="checkbox"/> Not Original	
Southern Limit		<input checked="" type="checkbox"/> Original <input type="checkbox"/> Not Original <input type="checkbox"/> Excavation Limit					
Western Limit		<input checked="" type="checkbox"/> Original <input type="checkbox"/> Not Original <input type="checkbox"/> Excavation Limit					
Eastern Limit		<input checked="" type="checkbox"/> Original <input type="checkbox"/> Not Original <input type="checkbox"/> Excavation Limit					
STRATIGRAPHICAL SEQUENCE							
Is equal to: 5006, 5153				Is bound to (only for masonry):			
Is abutted by:				Abuts:			
Is covered by: 5109, 5136				Covers:			
Is cut by:				Cuts:			
Is filled by:				Fills:			
OBSERVATIONS							
Single block of ashlar wall 5006, partially dislodged so removed by back hoe on 2/16. N.B. → originally documented as part of WALL SU 5006 in 2012; Given new SU # in 2013							
DESCRIPTION							
Position within sector: Southern area F, along ashlar wall 5006							
Shape: Block							
For layers complete this section:							
Surface (slope direction; visible inclusions):							
Observations about inclusions (Clusters? Deposition slope):							
Observations about thickness (Increases? Decreases?):							
Nature of the interface with layer below: <input type="checkbox"/> sharp <input type="checkbox"/> diffuse <input type="checkbox"/> commingled <input type="checkbox"/> other (specify)							
For cuts complete this section:				Sketch for layers and/or cuts (indicate North):			
Cut edges: <input type="checkbox"/> rounded <input type="checkbox"/> straight							
Cut sides: <input type="checkbox"/> straight <input type="checkbox"/> concave <input type="checkbox"/> convex <input type="checkbox"/> sloping							
Cut bottom: <input type="checkbox"/> flat <input type="checkbox"/> concave <input type="checkbox"/> irregular							
How is cut top edge? <input type="checkbox"/> sharp <input type="checkbox"/> rounded							
How is cut bottom edge? <input type="checkbox"/> sharp <input type="checkbox"/> rounded							
Observations:							

For structural remains complete this section

Alignment: E-W

Building Technique: Adobe/Mud-brick Ashlar (blocks) irregular (unworked) stone Concrete Other (specify)

Binding Agent: None Clay Mortar (if so, specify composition, color, compaction)

Concrete inclusions: —

Material Tufo Basalt Travertine Tiles Other (specify)

Size Small (range) _____ Medium (range) _____ Large (range) _____ Representative size: e.g. 2 x 1 x 2 cmz

Wall Facing:

Opus quadratum Opus incertum Opus reticulatum Petit appareil Opus testaceum Opus mixtum Opus vittatum Other (specify)

Complete this section for foundations Faced foundation Wooden shuttering No shuttering

floor/revetment type —

Floor type: Beaten Earth Opus signinum Opus scutulatum Opus Sectile Mosaic Opus spicatum Other (specify)

Wall finishing Stucco Opus signinum Plaster Painted Plaster Other (specify)

Approx. length, width, height of structural remains:

Description: Simple Gray tufo blocks, part of wall 5006. Partially collapsing & leaning out, but more or less in its original position in the wall.

Sketch (if applicable, indicate North)

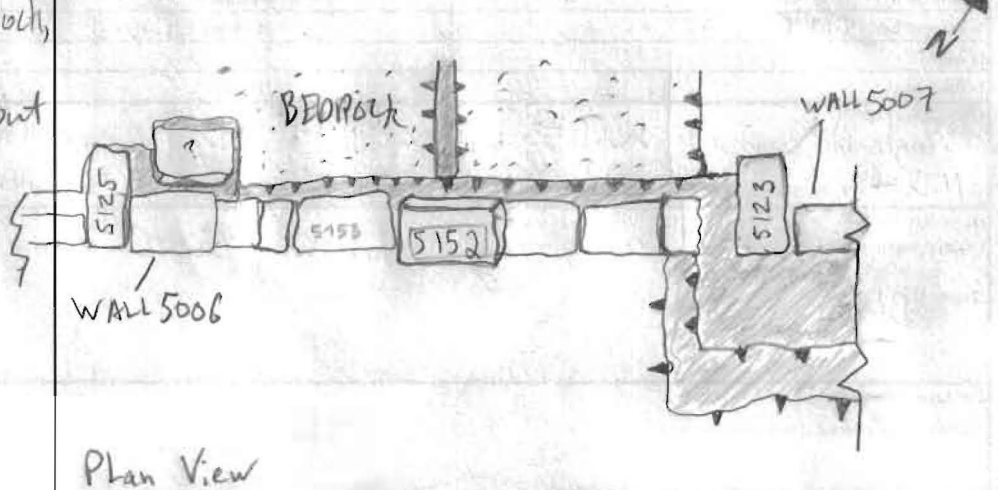

INTERPRETATION

This block was originally part of wall su 5006, but has been slightly disturbed by a post-abandonment collapse/dumping process. This process is also represented by blocks within the collapse layers (SU 5147 + 5148).

SOIL SAMPLING: Yes No

Total volume of layer (buckets):

Sample quantity (buckets):

Sample fraction (%):

NON SOIL SAMPLES: Yes No

If yes, specify (e.g. charcoal, mortar etc.):

Size:

SIEVING: Yes No

Total volume of layer (buckets):

Sample quantity (buckets):

Sample fraction (%):

STRATIGRAPHICAL RELIABILITY

Good Fair Poor

Filled-out by J. FARR

on 20.6.13

Revised by ACD

on 23/6/13

PDFd by JCN

on 3/7/13

Entered by ACD

on 2/7/13