

| SITE | YEAR | AREA | SECTOR | ELEVATION | STRATIGRAPHICAL UNIT | University of Michigan History Museum of Anthropology Gabi Project | |
|---|------|--|---|---|--|--|---|
| GPR | 13 | Area F | S | Min: 59.70 Max: 60.89 | 5340 <input type="checkbox"/> Natural <input checked="" type="checkbox"/> Anthropic | | |
| In cross-section? <input type="checkbox"/> Yes <input checked="" type="checkbox"/> No | | | In elevation drawing? <input type="checkbox"/> Yes <input checked="" type="checkbox"/> No | | Photos: <input checked="" type="checkbox"/> Yes <input type="checkbox"/> No #: 3275-3278 | Photo Model: <input checked="" type="checkbox"/> Yes <input type="checkbox"/> No #: 478.40 | |
| DEFINITION Eleven slabs of grey tufa along roadway S of 5339 | | | | | Covered by <input checked="" type="checkbox"/> SU: 5340 | Fills <input type="checkbox"/> SU: | Filled by <input type="checkbox"/> SU: |
| HOW IS LAYER DISTINGUISHED? <input type="checkbox"/> Color <input type="checkbox"/> Composition <input type="checkbox"/> Compaction | | | FORMATION PROCESS <input type="checkbox"/> Accumulation <input checked="" type="checkbox"/> Construction <input type="checkbox"/> Cutting <input type="checkbox"/> Erosion <input type="checkbox"/> Collapse <input type="checkbox"/> Intentional deposition | | | | |
| INCLUSIONS For each inclusion specify frequency: (f)requent, (m)edium, (r)are | | | | | SOIL/MATRIX clay ___% silt ___% sand ___% | | |
| Anthropic | | Geological | | Organic | <input type="checkbox"/> Granular <input type="checkbox"/> Layered <input type="checkbox"/> Cohesive | | |
| <input type="checkbox"/> Pottery <input type="checkbox"/> Nails | | <input type="checkbox"/> Tufo (specify) | | <input type="checkbox"/> Charcoal | | | |
| <input type="checkbox"/> Tiles <input type="checkbox"/> Marble | | <input type="checkbox"/> Travertine | | <input type="checkbox"/> Ash | | | |
| <input type="checkbox"/> Amphorae <input type="checkbox"/> Quarried debris | | <input type="checkbox"/> Other Limestone | | <input type="checkbox"/> Animal bones | | | |
| <input type="checkbox"/> Dolia <input type="checkbox"/> Slag <input type="checkbox"/> Brick | | <input type="checkbox"/> Basalt | | <input type="checkbox"/> Human bones | | | |
| <input type="checkbox"/> Mosaic tile(s) <input type="checkbox"/> Basalt slabs | | <input type="checkbox"/> Clay | | <input type="checkbox"/> Animal teeth | Compaction | | |
| <input type="checkbox"/> Mortar <input type="checkbox"/> Opus signinum | | <input type="checkbox"/> Sand | | <input type="checkbox"/> Human teeth | <input type="checkbox"/> Hard | | |
| <input type="checkbox"/> Coins <input type="checkbox"/> Painted plaster | | <input type="checkbox"/> Silt | | <input type="checkbox"/> Shells | <input type="checkbox"/> Compact | | |
| <input type="checkbox"/> Metal (specify) <input type="checkbox"/> Burnt Adobe | | <input type="checkbox"/> Pebbles (range) | | <input type="checkbox"/> Other (specify) | <input type="checkbox"/> Friable | | |
| <input type="checkbox"/> Collapse debris <input type="checkbox"/> Other (specify) | | <input type="checkbox"/> Gravel (range) | | | <input type="checkbox"/> Loose | | |
| <input type="checkbox"/> Glass | | | | | <input type="checkbox"/> Soft | | |
| | | | | | Color | | |
| | | | | | <input type="checkbox"/> Black <input type="checkbox"/> Brown | | |
| | | | | | <input type="checkbox"/> Gray <input type="checkbox"/> Light Brown | | |
| | | | | | <input type="checkbox"/> Light Gray <input type="checkbox"/> White | | |
| | | | | | <input type="checkbox"/> Yellow <input type="checkbox"/> Red | | |
| | | | | | <input type="checkbox"/> Light Yellow | | |
| | | | | | <input type="checkbox"/> Other (specify) | | |
| UNIT LIMITS (also indicate on overlay) | | | | | | | |
| Northern Limit | | <input type="checkbox"/> Original <input checked="" type="checkbox"/> Not Original | | <input type="checkbox"/> Excavation Limit | | Depth: <input checked="" type="checkbox"/> Original <input type="checkbox"/> Not Original | |
| Southern Limit | | <input type="checkbox"/> Original <input checked="" type="checkbox"/> Not Original | | <input type="checkbox"/> Excavation Limit | | | |
| Western Limit | | <input checked="" type="checkbox"/> Original <input type="checkbox"/> Not Original | | <input type="checkbox"/> Excavation Limit | | | |
| Eastern Limit | | <input checked="" type="checkbox"/> Original <input type="checkbox"/> Not Original | | <input type="checkbox"/> Excavation Limit | | | |
| STRATIGRAPHICAL SEQUENCE | | | | | | | |
| Is equal to: 5339 | | | | Is bound to (only for masonry): | | | |
| Is abutted by: | | | | Abuts: | | | |
| Is covered by: 5318 | | | | Covers: | | | |
| Is cut by: | | | | Cuts: | | | |
| Is filled by: | | | | Fills: | | | |
| OBSERVATIONS Eleven slabs of grey tufa along roadway S of 5339. Orientation NNW-SSE. (Site N-S). CONTINUES SOUTH UNDER OPUS SIGNINUM WALL 5318, THE FOUNDATION OF WHICH IS BUILT PARTLY UPON A SLAB OF THIS SU. | | | | | | | |
| DESCRIPTION Position within sector: along western limit of roadway, eastern end of F-S Shape: rectangular | | | | | | | |
| For layers complete this section: Surface (slope direction; visible inclusions): Observations about inclusions (Clusters? Deposition slope): Observations about thickness (Increases? Decreases?): Nature of the interface with layer below: <input type="checkbox"/> sharp <input type="checkbox"/> diffuse <input type="checkbox"/> commigled <input type="checkbox"/> other (specify) | | | | | | | |
| For cuts complete this section: Cut edges: <input type="checkbox"/> rounded <input type="checkbox"/> straight Cut sides: <input type="checkbox"/> straight <input type="checkbox"/> concave <input type="checkbox"/> convex <input type="checkbox"/> sloping Cut bottom: <input type="checkbox"/> flat <input type="checkbox"/> concave <input type="checkbox"/> irregular How is cut top edge? <input type="checkbox"/> sharp <input type="checkbox"/> rounded How is cut bottom edge? <input type="checkbox"/> sharp <input type="checkbox"/> rounded Observations: | | | | Sketch for layers and/or cuts (indicate North): | | | |

For structural remains complete this section

Alignment: *North-south (in line with 5339), on the axis of the complex,*

Building Technique: Adobe/Mud-brick Ashlar (blocks) irregular (unworked) stone Concrete Other (specify) *tufa slabs*

Binding Agent: None Clay Mortar (if so, specify composition, color, compaction)

Concrete inclusions:

Material Tufo Basalt Travertine Tiles Other (specify)
 Size Small (range) _____ Medium (range) _____ Large (range) _____ Representative size: e.g. 2 x 1 x 2 cmz

Wall Facing:

Opus quadratum Opus incertum Opus reticulatum Petit appareil Opus testaceum Opus mixtum Opus vittatum Other (specify)

Complete this section for foundations Faced foundation Wooden shuttering No shuttering

floor/revetment type

Floor type: Beaten Earth Opus signinum Opus scutulatum Opus Sectile Mosaic Opus spicatum Other (specify)

Wall finishing Stucco Opus signinum Plaster Painted Plaster Other (specify)

Approx. length, width, height of structural remains:

(145cm x 80cm x 20cm) per block x 11

Description:

Even grey tufa slabs oriented N-S along western edge of roadway south of 5339.

Sketch (if applicable, indicate North)

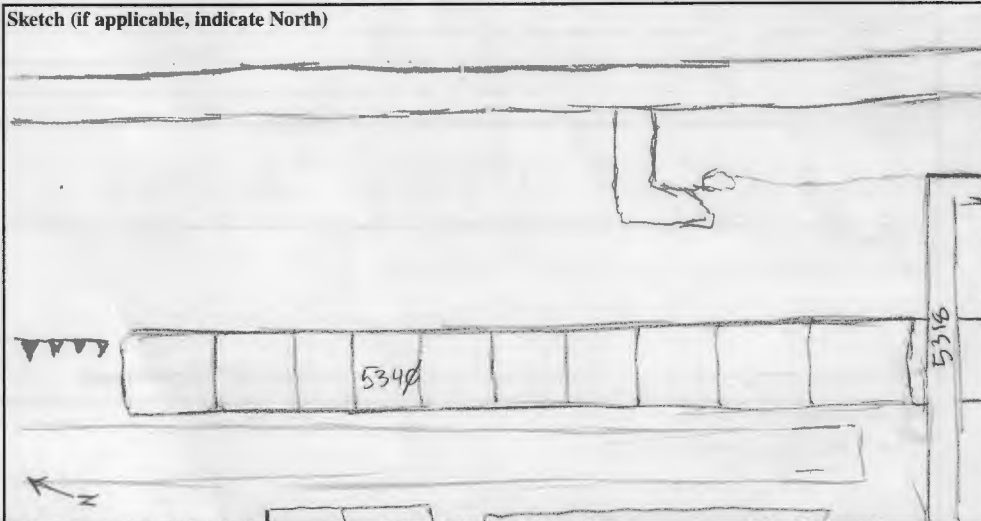

INTERPRETATION

Curb on the western side of the street which delimited eastern limit of city block. Likely in use when road surface paved with basalt blocks. Southern continuation of 5339.

SOIL SAMPLING: Yes No

Total volume of layer (buckets):
 Sample quantity (buckets):
 Sample fraction (%):

NON SOIL SAMPLES: Yes No

If yes, specify (e.g. charcoal, mortar etc.):
 Size:

SIEVING: Yes No

Total volume of layer (buckets):
 Sample quantity (buckets):
 Sample fraction (%):

STRATIGRAPHICAL RELIABILITY

Good Fair Poor

| | |
|--------------------------------|-------------------|
| Filled-out by <i>Ben Jorot</i> | on <i>12/7/13</i> |
| Revised by <i>ACD</i> | on <i>25/7/13</i> |
| PDFd by <i>JCN</i> | on <i>1/8/13</i> |
| Entered by | on |