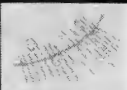

SITE GPR	YEAR 13	AREA F-South	SECTOR	ELEVATION Min: 60.3123 Max: 60.4132	STRATIGRAPHICAL UNIT 5368 <input type="checkbox"/> Natural <input type="checkbox"/> Anthropic	 University of Michigan Eastern Museum of Anthropology Gabii Project
-------------	------------	-----------------	--------	---	---	---

In cross-section? Yes No In elevation drawing? Yes No Photos: Yes No #: 2822-2824 Photo Model: Yes No #: 504

DEFINITION
Threshold beneath wall 5367

Covered by SU: 5367 Fills SU: Filled by SU:

HOW IS LAYER DISTINGUISHED?
 Color Composition Compaction

FORMATION PROCESS
 Accumulation Construction Cutting Erosion Collapse Intentional deposition

INCLUSIONS For each inclusion specify frequency: (f)requent, (m)edium, (r)are

Anthropic	Geological	Organic	SOIL/MATRIX
<input type="checkbox"/> Pottery <input type="checkbox"/> Tiles <input type="checkbox"/> Amphorae <input type="checkbox"/> Dolia <input type="checkbox"/> Mosaic tile(s) <input type="checkbox"/> Mortar <input type="checkbox"/> Coins <input type="checkbox"/> Metal (specify) <input type="checkbox"/> Collapse debris <input type="checkbox"/> Glass	<input type="checkbox"/> Nails <input type="checkbox"/> Marble <input type="checkbox"/> Quarried debris <input type="checkbox"/> Slag <input type="checkbox"/> Brick <input type="checkbox"/> Basalt slabs <input type="checkbox"/> Opus signinum <input type="checkbox"/> Painted plaster <input type="checkbox"/> Burnt Adobe <input type="checkbox"/> Other (specify)	<input type="checkbox"/> Tufo (specify) <input type="checkbox"/> Travertine <input type="checkbox"/> Other Limestone <input type="checkbox"/> Basalt <input type="checkbox"/> Clay <input type="checkbox"/> Sand <input type="checkbox"/> Silt <input type="checkbox"/> Pebbles (range) <input type="checkbox"/> Gravel (range)	<input type="checkbox"/> Charcoal <input type="checkbox"/> Ash <input type="checkbox"/> Animal bones <input type="checkbox"/> Human bones <input type="checkbox"/> Animal teeth <input type="checkbox"/> Human teeth <input type="checkbox"/> Shells <input type="checkbox"/> Other (specify)
			clay ___% silt ___% sand ___% <input type="checkbox"/> Granular <input type="checkbox"/> Layered <input type="checkbox"/> Cohesive
			Compaction <input type="checkbox"/> Hard <input type="checkbox"/> Compact <input type="checkbox"/> Friable <input type="checkbox"/> Loose <input type="checkbox"/> Soft
			Color <input type="checkbox"/> Black <input type="checkbox"/> Brown <input type="checkbox"/> Gray <input type="checkbox"/> Light Brown <input type="checkbox"/> Light Gray <input type="checkbox"/> White <input type="checkbox"/> Yellow <input type="checkbox"/> Red <input type="checkbox"/> Light Yellow <input type="checkbox"/> Other (specify)

UNIT LIMITS (also indicate on overlay)

Northern Limit Original Not Original Excavation Limit Depth: Original Not Original

Southern Limit Original Not Original Excavation Limit

Western Limit Original Not Original Excavation Limit

Eastern Limit Original Not Original Excavation Limit

STRATIGRAPHICAL SEQUENCE

Is equal to:	Is bound to (only for masonry):
Is abutted by:	Abuts:
Is covered by: 5367	Covers:
Is cut by:	Cuts:
Is filled by:	Fills:

OBSERVATIONS
previously excavated feature, re-exposed by our team in 2013

DESCRIPTION
Position within sector:
beneath wall 5367 in northern part of room 11 of Area F-South
Shape:
linear

For layers complete this section:

Surface (slope direction; visible inclusions):

Observations about inclusions (Clusters? Deposition slope)

Observations about thickness (Increases? Decreases?):

Nature of the interface with layer below: sharp diffuse commingled other (specify)

For cuts complete this section:

Cut edges: rounded straight

Cut sides: straight concave convex sloping

Cut bottom: flat concave irregular

How is cut top edge? sharp rounded

How is cut bottom edge? sharp rounded

Observations:

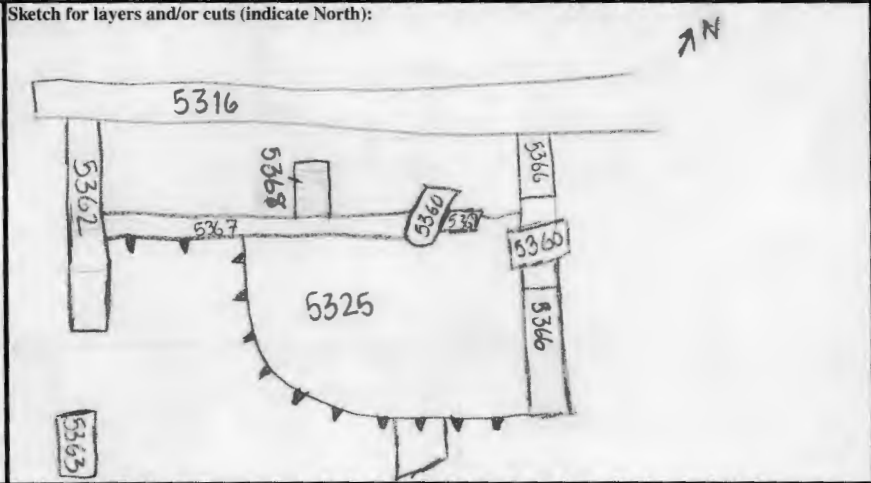

For structural remains complete this section

Alignment:

Building Technique: Adobe/Mud-brick Ashlar (blocks) irregular (unworked) stone Concrete Other (specify)

Binding Agent: None Clay Mortar (if so, specify composition, color, compaction)

Concrete inclusions:

Material Tufo Basalt Travertine Tiles Other (specify)
 Size Small (range) _____ Medium (range) _____ Large (range) _____ Representative size: e.g. 2 x 1 x 2 cmz

Wall Facing:

Opus quadratum Opus incertum Opus reticulatum Petit appareil Opus testaceum Opus mixtum Opus vittatum Other (specify)

Complete this section for foundations Faced foundation Wooden shuttering No shuttering

Floor/revetment type

Floor type: Beaten Earth Opus signinum Opus scutulatum Opus Sectile Mosaic Opus spicatum Other (specify)

Wall finishing Stucco Opus signinum Plaster Painted Plaster Other (specify)

Approx. length, width, height of structural remains:

height: 12cm / length: 41cm
width: 21cm

Description: Tufo

threshold block covered by wall
 5367. linear indentation running
 through center of block. Block
 extends beneath Floor 5325.

Sketch (if applicable, indicate North)

INTERPRETATION

Su 5368 is the threshold of ^{Far room}. Two seemingly identical thresholds lie to the north of wall 5318, associated with the earlier, monumental phase of ashlar architecture. This threshold is clearly associated with a similar red tufo ashlar wall, visible in section just to the south, on the same orientation of those to the north (Su's 5347, 5345, etc.) when this structure had gone out of use, it was built over by the concrete wall 5367 & associated Floor 5325.

SOIL SAMPLING: Yes No

Total volume of layer (buckets):

Sample quantity (buckets):

Sample fraction (%):

NON SOIL SAMPLES: Yes No

If yes, specify (e.g. charcoal, mortar etc.):

Size:

SIEVING: Yes No

Total volume of layer (buckets):

Sample quantity (buckets):

Sample fraction (%):

STRATIGRAPHICAL RELIABILITY

Good Fair Poor

Filled-out by S. Santos

on 17-07-13

Revised by J. FARR

on 19.7.13

PDFd by MCN

on 24.7.13

Entered by

on