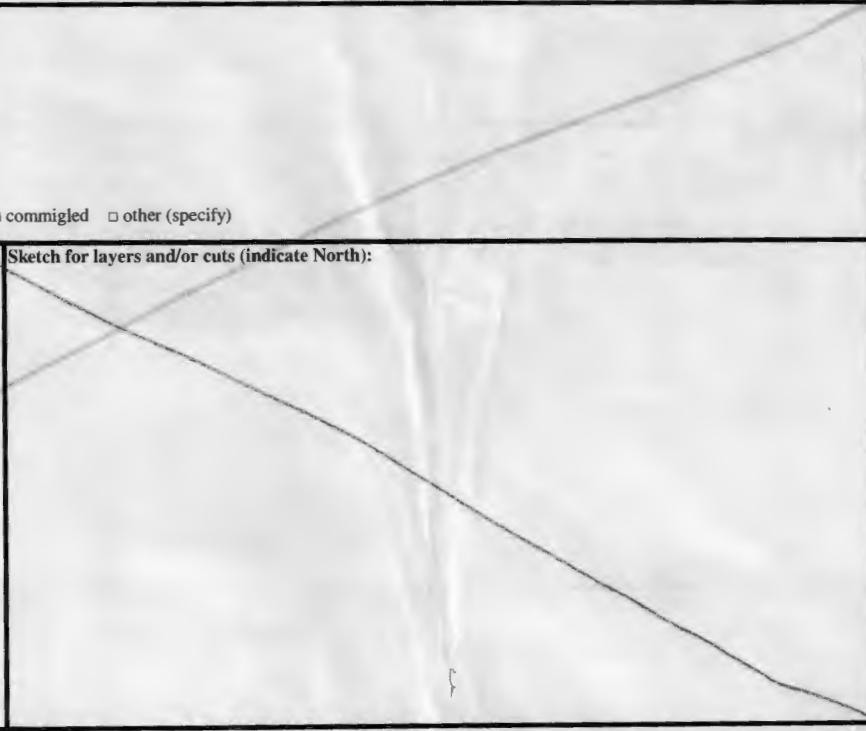

SITE GPR	YEAR 2013	AREA F	SECTOR S	ELEVATION Min: 60.5543 Max: 60.5775	STRATIGRAPHICAL UNIT 5373 <input type="checkbox"/> Natural <input checked="" type="checkbox"/> Anthropic	 Gabil Project	
				In cross-section? <input type="checkbox"/> Yes <input checked="" type="checkbox"/> No			In elevation drawing? <input type="checkbox"/> Yes <input checked="" type="checkbox"/> No
DEFINITION Western wall of room #1				Covered by <input type="checkbox"/> SU: 5314	Fills <input type="checkbox"/> SU:	Filled by <input type="checkbox"/> SU:	
HOW IS LAYER DISTINGUISHED? <input type="checkbox"/> Color <input type="checkbox"/> Composition <input type="checkbox"/> Compaction			FORMATION PROCESS <input type="checkbox"/> Accumulation <input checked="" type="checkbox"/> Construction <input type="checkbox"/> Cutting <input type="checkbox"/> Erosion <input type="checkbox"/> Collapse <input type="checkbox"/> Intentional deposition				
INCLUSIONS For each inclusion specify frequency: (f)requent, (m)edium, (r)are				SOIL/MATRIX			
Anthropic		Geological		Organic		clay ___% silt ___% sand ___%	
<input type="checkbox"/> Pottery <input type="checkbox"/> Tiles <input type="checkbox"/> Amphorae <input type="checkbox"/> Dolia <input type="checkbox"/> Mosaic tile(s) <input type="checkbox"/> Mortar <input type="checkbox"/> Coins <input type="checkbox"/> Metal (specify) <input type="checkbox"/> Collapse debris <input type="checkbox"/> Glass		<input type="checkbox"/> Nails <input type="checkbox"/> Marble <input type="checkbox"/> Quarried debris <input type="checkbox"/> Slag <input type="checkbox"/> Brick <input type="checkbox"/> Basalt slabs <input type="checkbox"/> Opus signinum <input type="checkbox"/> Painted plaster <input type="checkbox"/> Burnt Adobe <input type="checkbox"/> Other (specify)		<input type="checkbox"/> Tufo (specify) <input type="checkbox"/> Travertine <input type="checkbox"/> Other Limestone <input type="checkbox"/> Basalt <input type="checkbox"/> Clay <input type="checkbox"/> Sand <input type="checkbox"/> Silt <input type="checkbox"/> Pebbles (range) <input type="checkbox"/> Gravel (range)		<input type="checkbox"/> Charcoal <input type="checkbox"/> Ash <input type="checkbox"/> Animal bones <input type="checkbox"/> Human bones <input type="checkbox"/> Animal teeth <input type="checkbox"/> Human teeth <input type="checkbox"/> Shells <input type="checkbox"/> Other (specify)	<input type="checkbox"/> Granular <input type="checkbox"/> Layered <input type="checkbox"/> Cohesive  Compaction <input type="checkbox"/> Hard <input type="checkbox"/> Compact <input type="checkbox"/> Friable <input type="checkbox"/> Loose <input type="checkbox"/> Soft
						<input type="checkbox"/> Black <input type="checkbox"/> Brown <input type="checkbox"/> Gray <input type="checkbox"/> Light Brown <input type="checkbox"/> Light Gray <input type="checkbox"/> White <input type="checkbox"/> Yellow <input type="checkbox"/> Red <input type="checkbox"/> Light Yellow <input type="checkbox"/> Other (specify)	
UNIT LIMITS (also indicate on overlay)							
Northern Limit		<input checked="" type="checkbox"/> Original <input type="checkbox"/> Not Original <input type="checkbox"/> Excavation Limit		Depth: <input checked="" type="checkbox"/> Original <input checked="" type="checkbox"/> Not Original			
Southern Limit		<input type="checkbox"/> Original <input type="checkbox"/> Not Original <input checked="" type="checkbox"/> Excavation Limit					
Western Limit		<input checked="" type="checkbox"/> Original <input type="checkbox"/> Not Original <input type="checkbox"/> Excavation Limit					
Eastern Limit		<input checked="" type="checkbox"/> Original <input type="checkbox"/> Not Original <input type="checkbox"/> Excavation Limit					
STRATIGRAPHICAL SEQUENCE							
Is equal to: 5308; 5372				Is bound to (only for masonry):			
Is abutted by:				Abuts:			
Is covered by: 5314, 5375, 5476				Covers:			
Is cut by:				Cuts:			
Is filled by: (of room 6)				Fills:			
OBSERVATIONS on the west where the floor has been robbed there seems to be a foundation trench, but was not excavated in 2013. This is the western wall of room #1. Covered by SU 5314 and on the eastern side SU 5375 and 5476. It is equal to SU 5308. In the block #4 there is a break or cut half way.							
DESCRIPTION Position within sector: runs north to south on the western side of Area F - south							
Shape: Rectangular							
For layers complete this section:							
Surface (slope direction; visible inclusions):							
Observations about inclusions (Clusters? Deposition slope)							
Observations about thickness (Increases? Decreases?):							
Nature of the interface with layer below: <input type="checkbox"/> sharp <input type="checkbox"/> diffuse <input type="checkbox"/> commingled <input type="checkbox"/> other (specify)							
For cuts complete this section:				Sketch for layers and/or cuts (indicate North):			
Cut edges: <input type="checkbox"/> rounded <input type="checkbox"/> straight							
Cut sides: <input type="checkbox"/> straight <input type="checkbox"/> concave <input type="checkbox"/> convex <input type="checkbox"/> sloping							
Cut bottom: <input type="checkbox"/> flat <input type="checkbox"/> concave <input type="checkbox"/> irregular							
How is cut top edge? <input type="checkbox"/> sharp <input type="checkbox"/> rounded							
How is cut bottom edge? <input type="checkbox"/> sharp <input type="checkbox"/> rounded							
Observations:							

*Handwritten signature or initials in the bottom right corner.*

For structural remains complete this section

Alignment: North-South, on same axis as complex

Building Technique:  Adobe/Mud-brick  Ashlar (blocks)  irregular (unworked) stone  Concrete  Other (specify)

Binding Agent:  None  Clay  Mortar (if so, specify composition, color, compaction)

Concrete inclusions:

Material  Tufo  Basalt  Travertine  Tiles  Other (specify)

Size  Small (range) \_\_\_\_\_  Medium (range) \_\_\_\_\_  Large (range) \_\_\_\_\_ Representative size: e.g. 2 x 1 x 2 cmz

Wall Facing:

Opus quadratum  Opus incertum  Opus reticulatum  Petit appareil  Opus testaceum  Opus mixtum  Opus vittatum  Other (specify)

Complete this section for foundations  Faced foundation  Wooden shuttering  No shuttering

floor/revetment type

Floor type:  Beaten Earth  Opus signinum  Opus scutulatum  Opus Sectile  Mosaic  Opus spicatum  Other (specify)

Wall finishing  Stucco  Opus signinum  Plaster  Painted Plaster  Other (specify)

Approx. length, width, height of structural remains:

length: 5.32m width: 0.43m

Description:

Block	Length
1	1.05m
2	1.13m
3	2.62m
4	0.53m

In block #1 there is a break or cut about half way.

Sketch (if applicable, indicate North)

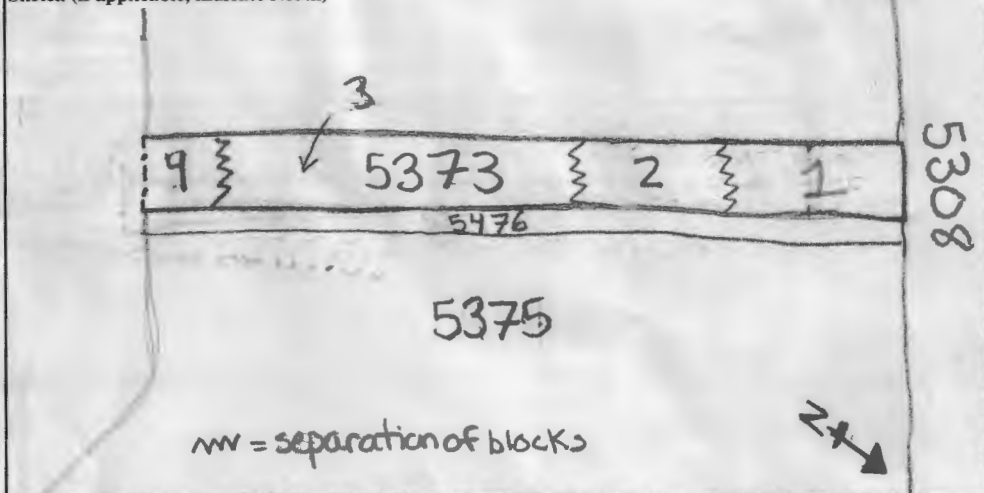

INTERPRETATION

This is the western wall of room #1. On the western limit where the floor has been removed from room 6 there seems to be a foundation trench in the bedrock, but it was not excavated in 2013. It was covered by SU5314, and on the eastern side is covered by plaster SU5476 and the floor of room #1 SU5379. It is equal to the northern wall of room #1, SU5308. The western wall was perhaps exterior due to a lack of plaster and the irregularity of the working of the block, similar to the northern face of wall 5308, where there is evidence for a type slab floor with drain in that space.

SOIL SAMPLING:  Yes  No

Total volume of layer (buckets):

Sample quantity (buckets):

Sample fraction (%):

NON SOIL SAMPLES:  Yes  No

If yes, specify (e.g. charcoal, mortar etc.):

Size:

SIEVING:  Yes  No

Total volume of layer (buckets):

Sample quantity (buckets):

Sample fraction (%):

STRATIGRAPHICAL RELIABILITY

Good  Fair  Poor

Filled-out by MJ

on 26-7-2013

Revised by ACS

on 28/7/2013

PDFd by JCN

on 2/8/13

Entered by

on