

SITE GPR	YEAR 2013	AREA F	SECTOR S	ELEVATION Min: 60.3195 Max: 60.5197	STRATIGRAPHICAL UNIT 5375 <input type="checkbox"/> Natural <input type="checkbox"/> Anthropic	 University of Michigan Laboratory of Archaeology Gabii Project	
	In cross-section? <input type="checkbox"/> Yes <input checked="" type="checkbox"/> No		In elevation drawing? <input type="checkbox"/> Yes <input checked="" type="checkbox"/> No		Photos: <input checked="" type="checkbox"/> Yes <input type="checkbox"/> No #: 3591-96		Photo Model: <input type="checkbox"/> Yes <input checked="" type="checkbox"/> No #:
DEFINITION cocciopesto floor of room #1				Covered by <input type="checkbox"/> SU: 5314	Fills <input type="checkbox"/> SU:	Filled by <input type="checkbox"/> SU:	
HOW IS LAYER DISTINGUISHED? <input type="checkbox"/> Color <input type="checkbox"/> Composition <input type="checkbox"/> Compaction			FORMATION PROCESS <input type="checkbox"/> Accumulation <input checked="" type="checkbox"/> Construction <input type="checkbox"/> Cutting <input type="checkbox"/> Erosion <input type="checkbox"/> Collapse <input type="checkbox"/> Intentional deposition				
INCLUSIONS For each inclusion specify frequency: (f)requent, (m)edium, (r)are					SOIL/MATRIX clay ___% silt ___% sand ___% <input type="checkbox"/> Granular <input type="checkbox"/> Layered <input type="checkbox"/> Cohesive		
Anthropic <input type="checkbox"/> Pottery <input type="checkbox"/> Nails <input type="checkbox"/> Tiles <input type="checkbox"/> Marble <input type="checkbox"/> Amphorae <input type="checkbox"/> Quarried debris <input type="checkbox"/> Dolia <input type="checkbox"/> Slag <input type="checkbox"/> Brick <input type="checkbox"/> Mosaic tile(s) <input type="checkbox"/> Basalt slabs <input type="checkbox"/> Mortar <input type="checkbox"/> Opus signinum <input type="checkbox"/> Coins <input type="checkbox"/> Painted plaster <input type="checkbox"/> Metal (specify) <input type="checkbox"/> Burnt Adobe <input type="checkbox"/> Collapse debris <input type="checkbox"/> Other (specify) <input type="checkbox"/> Glass		Geological <input type="checkbox"/> Tufo (specify) <input type="checkbox"/> Travertine <input type="checkbox"/> Other Limestone <input type="checkbox"/> Basalt <input type="checkbox"/> Clay <input type="checkbox"/> Sand <input type="checkbox"/> Silt <input type="checkbox"/> Pebbles (range) <input type="checkbox"/> Gravel (range)		Organic <input type="checkbox"/> Charcoal <input type="checkbox"/> Ash <input type="checkbox"/> Animal bones <input type="checkbox"/> Human bones <input type="checkbox"/> Animal teeth <input type="checkbox"/> Human teeth <input type="checkbox"/> Shells <input type="checkbox"/> Other (specify)		Compaction <input type="checkbox"/> Hard <input type="checkbox"/> Compact <input type="checkbox"/> Friable <input type="checkbox"/> Loose <input type="checkbox"/> Soft	Color <input type="checkbox"/> Black <input type="checkbox"/> Brown <input type="checkbox"/> Gray <input type="checkbox"/> Light Brown <input type="checkbox"/> Light Gray <input type="checkbox"/> White <input type="checkbox"/> Yellow <input type="checkbox"/> Red <input type="checkbox"/> Light Yellow <input type="checkbox"/> Other (specify)
UNIT LIMITS (also indicate on overlay)							
Northern Limit			<input checked="" type="checkbox"/> Original <input type="checkbox"/> Not Original <input type="checkbox"/> Excavation Limit		Depth: <input checked="" type="checkbox"/> Original <input type="checkbox"/> Not Original		
Southern Limit			<input checked="" type="checkbox"/> Original <input type="checkbox"/> Not Original <input type="checkbox"/> Excavation Limit				
Western Limit			<input checked="" type="checkbox"/> Original <input type="checkbox"/> Not Original <input type="checkbox"/> Excavation Limit				
Eastern Limit			<input checked="" type="checkbox"/> Original <input type="checkbox"/> Not Original <input type="checkbox"/> Excavation Limit				
STRATIGRAPHICAL SEQUENCE							
Is equal to:				Is bound to (only for masonry):			
Is abutted by:				Abuts: 5410			
Is covered by: 5314; 5475; 5476				Covers: 5372, 5373, 5308			
Is cut by:				Cuts:			
Is filled by:				Fills:			
OBSERVATIONS cocciopesto floor of room #1. While the northern, western, and eastern limits are original, the floor degrades towards the southern limit and at time of excavation, 25 July 2013, southern limit is original. There is a diamond mosaic pattern. THE PART OF THE DUMP WHICH COVERS THIS FLOOR IN THE SW CORNER WAS NOT EXCAVATED IN 2013.							
DESCRIPTION Position within sector: North western part of area F - South							
Shape: Square							
For layers complete this section: Surface (slope direction; visible inclusions): Observations about inclusions (Clusters? Deposition slope) Observations about thickness (Increases? Decreases?): Nature of the interface with layer below: <input type="checkbox"/> sharp <input type="checkbox"/> diffuse <input type="checkbox"/> commigled <input type="checkbox"/> other (specify)							
For cuts complete this section: Cut edges: <input type="checkbox"/> rounded <input type="checkbox"/> straight Cut sides: <input type="checkbox"/> straight <input type="checkbox"/> concave <input type="checkbox"/> convex <input type="checkbox"/> sloping Cut bottom: <input type="checkbox"/> flat <input type="checkbox"/> concave <input type="checkbox"/> irregular How is cut top edge? <input type="checkbox"/> sharp <input type="checkbox"/> rounded How is cut bottom edge? <input type="checkbox"/> sharp <input type="checkbox"/> rounded Observations:				Sketch for layers and/or cuts (indicate North):			

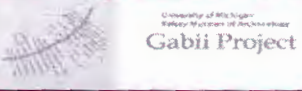

For structural remains complete this section

Alignment: One axis of complex

Building Technique: Adobe/Mud-brick Ashlar (blocks) irregular (unworked) stone Concrete Other (specify)

Binding Agent: None Clay Mortar (if so, specify composition, color, compaction)

Concrete inclusions:

Material Tufo Basalt Travertine Tiles Other (specify)
 Size Small (range) _____ Medium (range) _____ Large (range) _____ Representative size: e.g. 2 x 1 x 2 cmz

Wall Facing:

Opus quadratum Opus incertum Opus reticulatum Petit appareil Opus testaceum Opus mixtum Opus vittatum Other (specify)

Complete this section for foundations Faced foundation Wooden shuttering No shuttering

Floor/revetment type

Floor type: Beaten Earth Opus signinum Opus scutulatum Opus Sectile Mosaic Opus spicatum Other (specify) Caecio pesto

Wall finishing Stucco Opus signinum Plaster Painted Plaster Other (specify)

Approx. length, width, height of structural remains:

Width: 6.45m Length: 7.45m

Description:

Diamond pattern that varies slightly from the pattern in room #2.

Sketch (if applicable, indicate North)

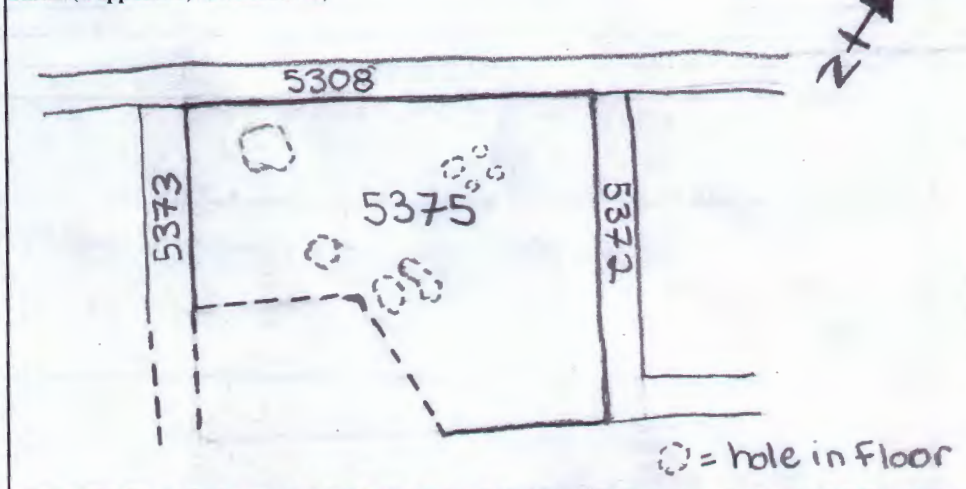

INTERPRETATION

Caeciopesto floor of room #1. Northern, western, and eastern limits are well defined, the floor degrades towards the southern limit where the orange tufo PREPARATIONS, LEVISED FROM BLUE... or... Based on the fineness of the floor in conjunction with the plaster on the walls, this was a display space. From the floor we can also deduce that this room was covered by a ceiling. Based on the southern limit the room was completely open whereas room #2 was a more restricted space. Maybe in a post-abandonment phase, damage was done to the floor. There are almost perfect circles cut in the courtyard of this room. OR OF THE WALLS IT, OF THIS ROOM.

* WHERE THERE IS NO WALL OR THRESHOLD BUT A DIRECT INTERFACE WITH TUFO SUB FLOOR 5410,

SOIL SAMPLING: Yes No

Total volume of layer (buckets):

Sample quantity (buckets):

Sample fraction (%):

NON SOIL SAMPLES: Yes No

If yes, specify (e.g. charcoal, mortar etc.):

Size:

SIEVING: Yes No

Total volume of layer (buckets):

Sample quantity (buckets):

Sample fraction (%):

STRATIGRAPHICAL RELIABILITY

Good Fair Poor

Filled-out by HK, EK

Revised by ACS

PDFd by

Entered by

on 25-7-2013

on 28/7/2013

on

on