

SITE GPR	YEAR 2013	AREA F	SECTOR south	ELEVATION Min: 60.3418 Max: 61.3376	STRATIGRAPHICAL UNIT 5402 <input type="checkbox"/> Natural <input checked="" type="checkbox"/> Anthropic	University of Michigan Kelsey Museum of Archaeology Gabii Project
	In cross-section? <input type="checkbox"/> Yes <input type="checkbox"/> No		In elevation drawing? <input type="checkbox"/> Yes <input type="checkbox"/> No		Photos: <input checked="" type="checkbox"/> Yes <input type="checkbox"/> No #:	

DEFINITION Wall in opus incertum running N-S south of ashlar wall 5006	Covered by <input type="checkbox"/> SU:	Fills <input type="checkbox"/> SU:	Filled by <input type="checkbox"/> SU:
--	--	---------------------------------------	---

HOW IS LAYER DISTINGUISHED? <input type="checkbox"/> Color <input type="checkbox"/> Composition <input type="checkbox"/> Compaction	FORMATION PROCESS <input type="checkbox"/> Accumulation <input checked="" type="checkbox"/> Construction <input type="checkbox"/> Cutting <input type="checkbox"/> Erosion <input type="checkbox"/> Collapse <input type="checkbox"/> Intentional deposition
--	---

INCLUSIONS For each inclusion specify frequency: (f)requent, (m)edium, (r)are			SOIL/MATRIX clay ___% silt ___% sand ___%	
<b>Anthropic</b>	<b>Geological</b>	<b>Organic</b>	<input type="checkbox"/> Granular <input type="checkbox"/> Layered <input type="checkbox"/> Cohesive	
<input type="checkbox"/> Pottery <input type="checkbox"/> Nails	<input type="checkbox"/> Tufo (specify)	<input type="checkbox"/> Charcoal	<b>Compaction</b> <input type="checkbox"/> Hard <input type="checkbox"/> Compact <input type="checkbox"/> Friable <input type="checkbox"/> Loose <input type="checkbox"/> Soft	
<input type="checkbox"/> Tiles <input type="checkbox"/> Marble	<input type="checkbox"/> Travertine	<input type="checkbox"/> Ash		
<input type="checkbox"/> Amphorae <input type="checkbox"/> Quarried debris	<input type="checkbox"/> Other Limestone	<input type="checkbox"/> Animal bones	<b>Color</b> <input type="checkbox"/> Black <input type="checkbox"/> Brown <input type="checkbox"/> Gray <input type="checkbox"/> Light Brown <input type="checkbox"/> Light Gray <input type="checkbox"/> White <input type="checkbox"/> Yellow <input type="checkbox"/> Red <input type="checkbox"/> Light Yellow <input type="checkbox"/> Other (specify)	
<input type="checkbox"/> Dolia <input type="checkbox"/> Slag <input type="checkbox"/> Brick	<input type="checkbox"/> Basalt	<input type="checkbox"/> Human bones		
<input type="checkbox"/> Mosaic tile(s) <input type="checkbox"/> Basalt slabs	<input type="checkbox"/> Clay	<input type="checkbox"/> Animal teeth		
<input type="checkbox"/> Mortar <input type="checkbox"/> Opus signinum	<input type="checkbox"/> Sand	<input type="checkbox"/> Human teeth		
<input type="checkbox"/> Coins <input type="checkbox"/> Painted plaster	<input type="checkbox"/> Silt	<input type="checkbox"/> Shells		
<input type="checkbox"/> Metal (specify) <input type="checkbox"/> Burnt Adobe	<input type="checkbox"/> Pebbles (range)	<input type="checkbox"/> Other (specify)		
<input type="checkbox"/> Collapse debris <input type="checkbox"/> Other (specify)	<input type="checkbox"/> Gravel (range)			
<input type="checkbox"/> Glass				

UNIT LIMITS (also indicate on overlay)		Depth: <input checked="" type="checkbox"/> Original <input type="checkbox"/> Not Original
Northern Limit	<input checked="" type="checkbox"/> Original <input type="checkbox"/> Not Original <input type="checkbox"/> Excavation Limit	
Southern Limit	<input checked="" type="checkbox"/> Original <input type="checkbox"/> Not Original <input type="checkbox"/> Excavation Limit	
Western Limit	<input checked="" type="checkbox"/> Original <input type="checkbox"/> Not Original <input type="checkbox"/> Excavation Limit	
Eastern Limit	<input checked="" type="checkbox"/> Original <input type="checkbox"/> Not Original <input type="checkbox"/> Excavation Limit	

STRATIGRAPHICAL SEQUENCE	
Is equal to:	Is bound to (only for masonry):
Is abutted by: 5314; 5379; 5391; 5477; 5513; 5508	Abuts: 5006
Is covered by: <del>5</del>	Covers: 5467; 5401; 5468;
Is cut by:	Cuts:
Is filled by:	Fills:

OBSERVATIONS: Discovered by backhoe; dug by pickaxe

DESCRIPTION  
Position within sector: N side of F south

Shape:

For layers complete this section:

Surface (slope direction; visible inclusions):

Observations about inclusions (Clusters? Deposition slope):

Observations about thickness (Increases? Decreases?):

Nature of the interface with layer below:  sharp  diffuse  commingled  other (specify)

For cuts complete this section:	Sketch for layers and/or cuts (indicate North):
Cut edges: <input type="checkbox"/> rounded <input type="checkbox"/> straight	
Cut sides: <input type="checkbox"/> straight <input type="checkbox"/> concave <input type="checkbox"/> convex <input type="checkbox"/> sloping	
Cut bottom: <input type="checkbox"/> flat <input type="checkbox"/> concave <input type="checkbox"/> irregular	
How is cut top edge? <input type="checkbox"/> sharp <input type="checkbox"/> rounded	
How is cut bottom edge? <input type="checkbox"/> sharp <input type="checkbox"/> rounded	
Observations:	



**For structural remains complete this section**

Alignment:

Building Technique:  Adobe/Mud-brick  Ashlar (blocks)  irregular (unworked) stone  Concrete  Other (specify)

Binding Agent:  None  Clay  Mortar (if so, specify composition, color, compaction)

Concrete inclusions:

Material  Tufo  Basalt  Travertine  Tiles  Other (specify)  
 Size  Small (range) \_\_\_\_\_  Medium (range) \_\_\_\_\_  Large (range) \_\_\_\_\_ Representative size: e.g. 2 x 1 x 2 cmz

Wall Facing:

Opus quadratum  Opus incertum  Opus reticulatum  Petit appareil  Opus testaceum  Opus mixtum  Opus vittatum  Other (specify)

Complete this section for foundations  Faced foundation  Wooden shuttering  No shuttering

floor/revetment type

Floor type:  Beaten Earth  Opus signinum  Opus scutulatum  Opus Sectile  Mosaic  Opus spicatum  Other (specify)

Wall finishing  Stucco  Opus signinum  Plaster  Painted Plaster  Other (specify)

Approx. length, width, height of structural remains:

Description:

Wall in concrete which abuts the ashlar wall 5006. The wall is founded partially on the bed rock partially on the earlier floor 5462 and on the drain 5401 = 5468. In this part, in particular, benches of the concrete foundation of the wall were preserved.

Sketch (if applicable, indicate North)

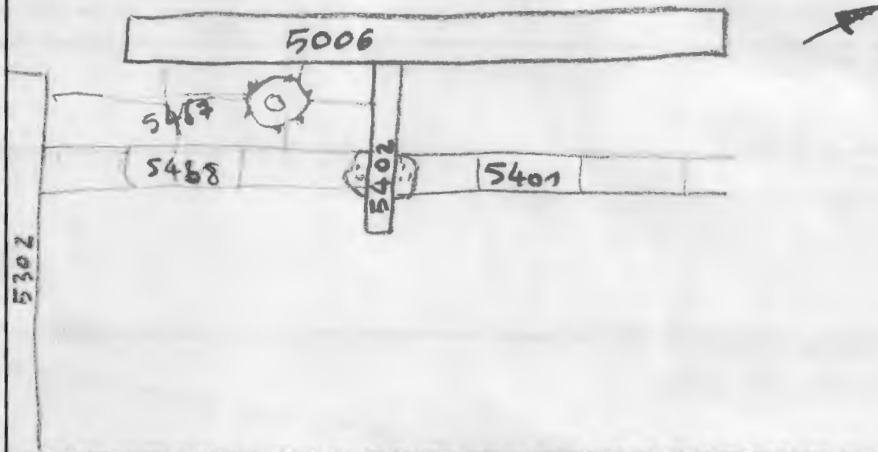

**INTERPRETATION**

concrete wall probably with an enclosure function (due to the small dimensions of the foundation and to its small height\*) - The wall clearly abuts the ashlar wall 5006 and is related to a later use of the area (courtyard?).

\* that is supposed to be the original one

SOIL SAMPLING:  Yes  No

Total volume of layer (buckets):

Sample quantity (buckets):

Sample fraction (%):

NON SOIL SAMPLES:  Yes  No

If yes, specify (e.g. charcoal, mortar etc.):

Size:

SIEVING:  Yes  No

Total volume of layer (buckets):

Sample quantity (buckets):

Sample fraction (%):

**STRATIGRAPHICAL RELIABILITY**

Good  Fair  Poor

Filled-out by	G.P.	on	31-7-2013
Revised by	ACD	on	2/8/13
PDFd by	JCN	on	2/8/13
Entered by		on	