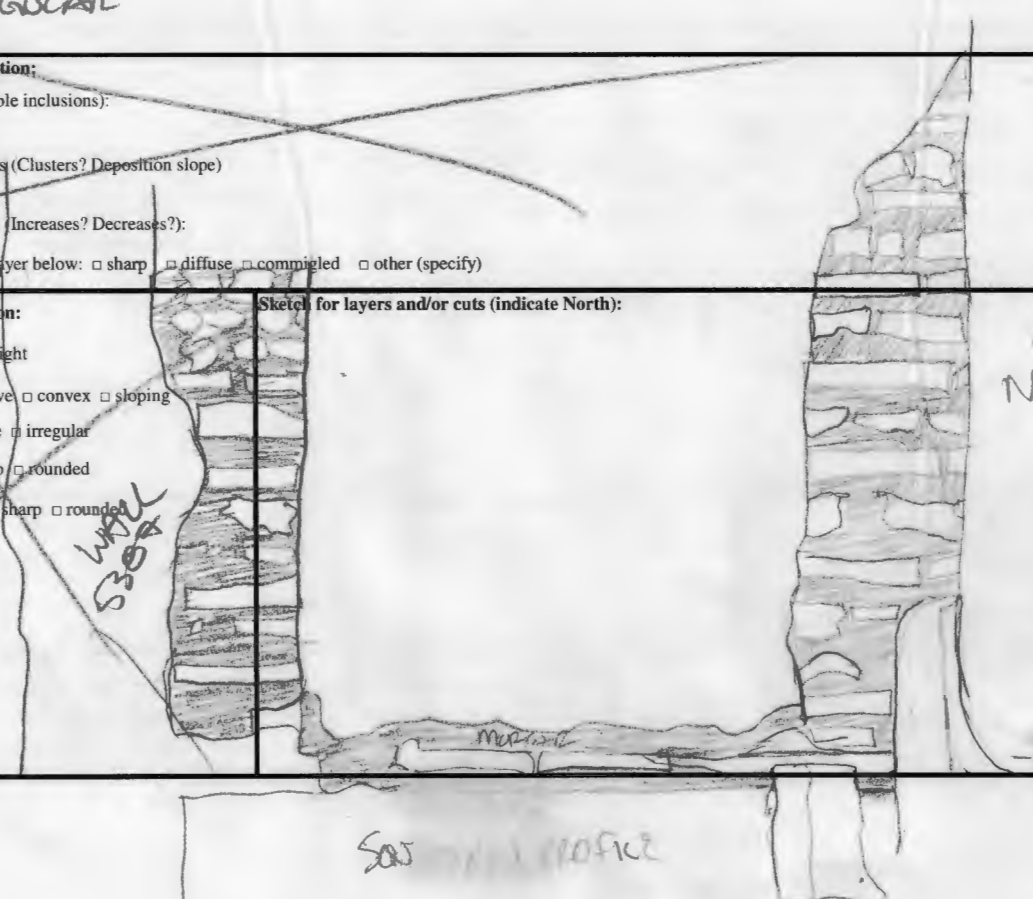

SITE GPR	YEAR 13	AREA F-South	SECTOR	ELEVATION Min: 58.7244 Max: 59.9317	STRATIGRAPHICAL UNIT 5412 <input type="checkbox"/> Natural <input checked="" type="checkbox"/> Anthropic	 University of Michigan Biology and Earth and Environmental Sciences Gabiil Project
				In cross-section? <input type="checkbox"/> Yes <input checked="" type="checkbox"/> No	In elevation drawing? <input type="checkbox"/> Yes <input checked="" type="checkbox"/> No	
DEFINITION E-W wall with doorway in eastern corridor			Covered by <input checked="" type="checkbox"/> SU: 5359	Fills <input checked="" type="checkbox"/> SU:	Filled by <input type="checkbox"/> SU:	
HOW IS LAYER DISTINGUISHED? <input type="checkbox"/> Color <input type="checkbox"/> Composition <input type="checkbox"/> Compaction			FORMATION PROCESS <input type="checkbox"/> Accumulation <input checked="" type="checkbox"/> Construction <input type="checkbox"/> Cutting <input type="checkbox"/> Erosion <input type="checkbox"/> Collapse <input type="checkbox"/> Intentional deposition			
INCLUSIONS For each inclusion specify frequency: (f)requent, (m)edium, (r)are			SOIL/MATRIX			
Anthropic <input type="checkbox"/> Pottery <input type="checkbox"/> Nails <input type="checkbox"/> Tiles <input type="checkbox"/> Marble <input type="checkbox"/> Amphorae <input type="checkbox"/> Quarried debris <input type="checkbox"/> Dolia <input type="checkbox"/> Slag <input type="checkbox"/> Brick <input type="checkbox"/> Mosaic tile(s) <input type="checkbox"/> Basalt slabs <input type="checkbox"/> Mortar <input type="checkbox"/> Opus signinum <input type="checkbox"/> Coins <input type="checkbox"/> Painted plaster <input type="checkbox"/> Metal (specify) <input type="checkbox"/> Burnt Adobe <input type="checkbox"/> Collapse debris <input type="checkbox"/> Other (specify) <input type="checkbox"/> Glass			Geological <input type="checkbox"/> Tufo (specify) <input type="checkbox"/> Travertine <input type="checkbox"/> Other Limestone <input type="checkbox"/> Basalt <input type="checkbox"/> Clay <input type="checkbox"/> Sand <input type="checkbox"/> Silt <input type="checkbox"/> Pebbles (range) <input type="checkbox"/> Gravel (range)		Organic <input type="checkbox"/> Charcoal <input type="checkbox"/> Ash <input type="checkbox"/> Animal bones <input type="checkbox"/> Human bones <input type="checkbox"/> Animal teeth <input type="checkbox"/> Human teeth <input type="checkbox"/> Shells <input type="checkbox"/> Other (specify)	
			clay ___% silt ___% sand ___% <input type="checkbox"/> Granular <input type="checkbox"/> Layered <input type="checkbox"/> Cohesive		Compaction <input type="checkbox"/> Hard <input type="checkbox"/> Black <input type="checkbox"/> Brown <input checked="" type="checkbox"/> Compact <input type="checkbox"/> Gray <input type="checkbox"/> Light Brown <input type="checkbox"/> Friable <input type="checkbox"/> Light Gray <input type="checkbox"/> White <input type="checkbox"/> Loose <input type="checkbox"/> Yellow <input type="checkbox"/> Red <input type="checkbox"/> Soft <input type="checkbox"/> Light Yellow <input type="checkbox"/> Other (specify)	
UNIT LIMITS (also indicate on overlay)						
Northern Limit			<input checked="" type="checkbox"/> Original <input type="checkbox"/> Not Original <input type="checkbox"/> Excavation Limit		Depth: <input type="checkbox"/> Original <input checked="" type="checkbox"/> Not Original	
Southern Limit			<input checked="" type="checkbox"/> Original <input type="checkbox"/> Not Original <input type="checkbox"/> Excavation Limit			
Western Limit			<input checked="" type="checkbox"/> Original <input type="checkbox"/> Not Original <input type="checkbox"/> Excavation Limit			
Eastern Limit			<input checked="" type="checkbox"/> Original <input type="checkbox"/> Not Original <input type="checkbox"/> Excavation Limit			
STRATIGRAPHICAL SEQUENCE						
Is equal to:			Is bound to (only for masonry):			
Is abutted by: 5332, 5332			Abuts: 5382 5413			
Is covered by: 13, 5359			Covers: Left in situ			
Is cut by:			Cuts:			
Is filled by:			Fills:			
OBSERVATIONS excavated during previous independent excavation, re-exposed by Gabii Project 2013						
DESCRIPTION Position within sector: EAST, south in eastern corridor Shape: RECTANGULAR						
For layers complete this section: Surface (slope direction; visible inclusions): Observations about inclusions (Clusters? Deposition slope): Observations about thickness (Increases? Decreases?): Nature of the interface with layer below: <input type="checkbox"/> sharp <input type="checkbox"/> diffuse <input type="checkbox"/> commingled <input type="checkbox"/> other (specify)						
For cuts complete this section: Cut edges: <input type="checkbox"/> rounded <input type="checkbox"/> straight Cut sides: <input type="checkbox"/> straight <input type="checkbox"/> concave <input type="checkbox"/> convex <input type="checkbox"/> sloping Cut bottom: <input type="checkbox"/> flat <input type="checkbox"/> concave <input type="checkbox"/> irregular How is cut top edge? <input type="checkbox"/> sharp <input type="checkbox"/> rounded How is cut bottom edge? <input type="checkbox"/> sharp <input type="checkbox"/> rounded Observations: Sketch for layers and/or cuts (indicate North): 						

For structural remains complete this section

Alignment: EAST-WEST

Building Technique: Adobe/Mud-brick Ashlar (blocks) irregular (unworked) stone Concrete Other (specify)

Binding Agent: None Clay Mortar (if so, specify composition, color, compaction)

Concrete inclusions:

Material: Tuff Basalt Travertine Tiles Other (specify)

Size: Small (range) _____ Medium (range) _____ Large (range) _____ Representative size: e.g. 2 x 1 x 2 cmz

Wall Facing:

Opus quadratum Opus incertum Opus reticulatum Petit appareil Opus testaceum Opus mixtum Opus vittatum Other (specify)

Complete this section for foundations Faced foundation Wooden shuttering No shuttering

floor/revetment type

Floor type: Beaten Earth Opus signinum Opus scutulatum Opus Sectile Mosaic Opus spicatum Other (specify)

Wall finishing Stucco Opus signinum Plaster Painted Plaster Other (specify)

Approx. length, width, height of structural remains:

1m 52cm x 50cm x height at

Description: THRESHOLD = 12cm high

E-W WALL IN EASTERN CORRIDOR ABUTS 5487, 5413 AND ~~5331~~ 5332 TO THE NORTH.

ALTERNATING TILES, MORTAR AND STONES THE WALL CONSISTS OF 2 "PIERS" AND A MUCH LOWER THRESHOLD. Sewer continues under eastern "pier", but not visible from South.

Sketch (if applicable, indicate North)

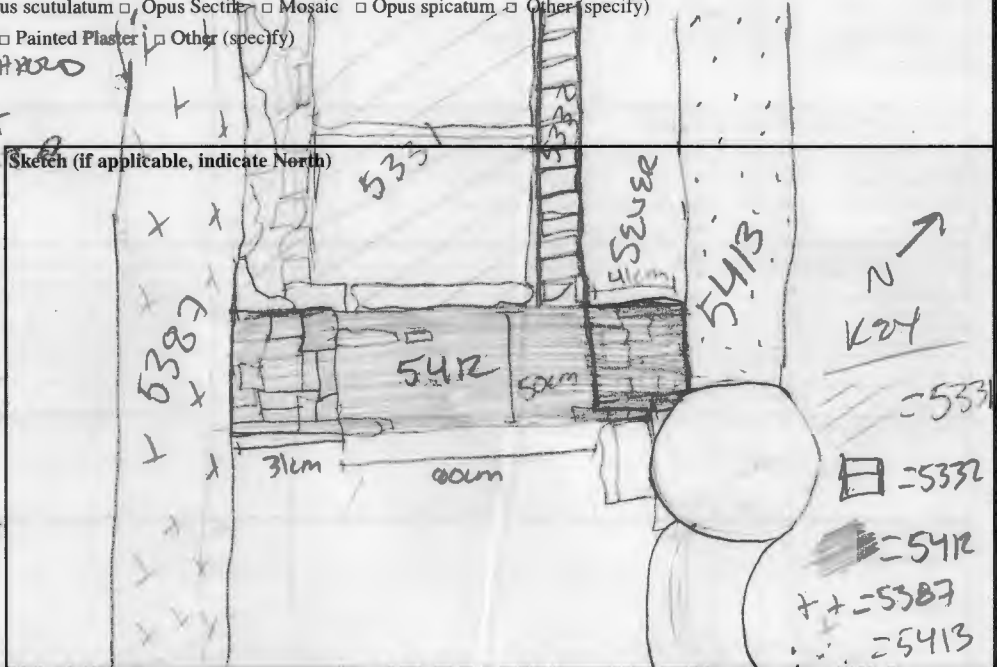

INTERPRETATION

EAST-WEST WALL 5412 WAS CONSTRUCTED ABUTTING BOTH 5387 TO THE WEST + 5413 TO THE EAST DIVIDING THE "EASTERN" CORRIDOR. FURTHERMORE THE WALL SEEMS TO BE ASSOCIATED W/ THE "RENOVATED" OF THE SEWER (5331, 5332 AND 5361) AS IT SEEMS TO CORRESPOND TO THE LEVEL OF 5412 AND TO BE CONSTRUCTED CONTEMPORANEOUSLY. IT SEEMS TO BE ABUTTED BY BOTH 5331 + 5332. The doorway provided access to the gutter in this corridor.

SOIL SAMPLING: Yes No
 Total volume of layer (buckets):
 Sample quantity (buckets):
 Sample fraction (%):

NON SOIL SAMPLES: Yes No
 If yes, specify (e.g. charcoal, mortar etc.):
 Size:

SIEVING: Yes No
 Total volume of layer (buckets):
 Sample quantity (buckets):
 Sample fraction (%):

STRATIGRAPHICAL RELIABILITY

Good Fair Poor

Filled-out by	<u>SLAGZ</u>	on	<u>1.8.13</u>
Revised by	<u>S. FARR</u>	on	<u>1.8.13</u>
PDFd by	<u>JCN</u>	on	<u>2/8/13</u>
Entered by		on	