

SITE GPR	YEAR 2010	AREA A	SECTOR	ELEVATION Min: 64.738 Max: 64.9535	STRATIGRAPHICAL UNIT 547 <input type="checkbox"/> Natural <input checked="" type="checkbox"/> Anthropic	
-------------	--------------	-----------	--------	--	---	--

In cross-section?  Yes  No      In elevation drawing?  Yes  No      Photos:  Yes  No #: 1325-26      Photo Model:  Yes  No #:

DEFINITION  
Cut of square hole in 530 N of 533

Covered by  SU: 529      Fills  SU:      Filled by  SU: 546

HOW IS LAYER DISTINGUISHED?  
 Color  Composition  Compaction

FORMATION PROCESS  
 Accumulation  Construction  Cutting  Erosion  Collapse  Intentional deposition

INCLUSIONS For each inclusion specify frequency: (f)requent, (m)edium, (r)are

Anthropic	Geological	Organic	SOIL/MATRIX
<input type="checkbox"/> Pottery <input type="checkbox"/> Tiles <input type="checkbox"/> Amphorae <input type="checkbox"/> Dolia <input type="checkbox"/> Mosaic tiles(s) <input type="checkbox"/> Mortar <input type="checkbox"/> Coins <input type="checkbox"/> Metal (specify) <input type="checkbox"/> Collapse debris <input type="checkbox"/> Glass	<input type="checkbox"/> Nails <input type="checkbox"/> Marble <input type="checkbox"/> Quarried debris <input type="checkbox"/> Slag <input type="checkbox"/> Brick <input type="checkbox"/> Basalt slabs <input type="checkbox"/> Opus signinum <input type="checkbox"/> Painted plaster <input type="checkbox"/> Burnt Adobe <input type="checkbox"/> Other (specify)	<input type="checkbox"/> Tufo (specify) <input type="checkbox"/> Travertine <input type="checkbox"/> Other Limestone <input type="checkbox"/> Basalt <input type="checkbox"/> Clay <input type="checkbox"/> Sand <input type="checkbox"/> Silt <input type="checkbox"/> Pebbles (range) <input type="checkbox"/> Gravel (range)	<input type="checkbox"/> Charcoal <input type="checkbox"/> Ash <input type="checkbox"/> Animal bones <input type="checkbox"/> Human bones <input type="checkbox"/> Animal teeth <input type="checkbox"/> Human teeth <input type="checkbox"/> Shells <input type="checkbox"/> Other (specify)
clay ___% silt ___% sand ___% <input type="checkbox"/> Granular <input type="checkbox"/> Layered <input type="checkbox"/> Cohesive			<b>Compaction</b> <input type="checkbox"/> Hard <input type="checkbox"/> Compact <input type="checkbox"/> Friable <input type="checkbox"/> Loose <input type="checkbox"/> Soft
			<b>Color</b> <input type="checkbox"/> Black <input type="checkbox"/> Brown <input type="checkbox"/> Gray <input type="checkbox"/> Light Brown <input type="checkbox"/> Light Gray <input type="checkbox"/> White <input type="checkbox"/> Yellow <input type="checkbox"/> Red <input type="checkbox"/> Light Yellow <input type="checkbox"/> Other (specify)

UNIT LIMITS (also indicate on overlay)

Northern Limit  Original  Not Original  Excavation Limit      Depth:  Original  Not Original

Southern Limit  Original  Not Original  Excavation Limit

Western Limit  Original  Not Original  Excavation Limit

Eastern Limit  Original  Not Original  Excavation Limit

STRATIGRAPHICAL SEQUENCE

Is equal to:	Is bound to (only for masonry):
Is abutted by:	Abuts:
Is covered by: 529	Covers:
Is cut by:	Cuts: 530
Is filled by: 546	Fills:

OBSERVATIONS  
Square cut in bedrock within linear cut 530 N of another square cut (533) and S of a third (549); all three have similar dimensions and are aligned within 530 or with the line of 530

DESCRIPTION  
Position within sector: Central part of Area A, E of wall 420 and N of small square cut 533.  
Shape: Square.

For layers complete this section:

Surface (slope direction; visible inclusions):

Observations about inclusions (Clusters? Deposition slope)

Observations about thickness (Increases? Decreases?):

Nature of the interface with layer below:  sharp  diffuse  commingled  other (specify)

For cuts complete this section:

Cut edges:  rounded  straight

Cut sides:  straight  concave  convex  sloping

Cut bottom:  flat  concave  irregular

How is cut top edge?  sharp  rounded

How is cut bottom edge?  sharp  rounded

Observations:  
Shallower than cut 533 to the S but deeper than cut 549 to the N.

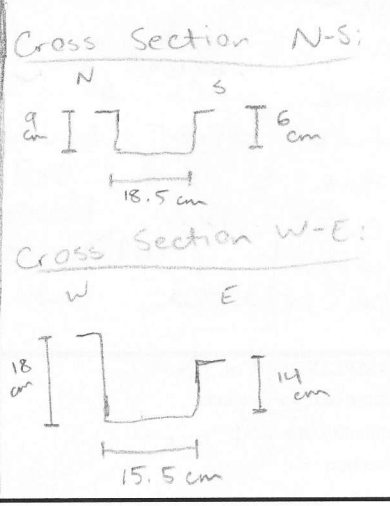
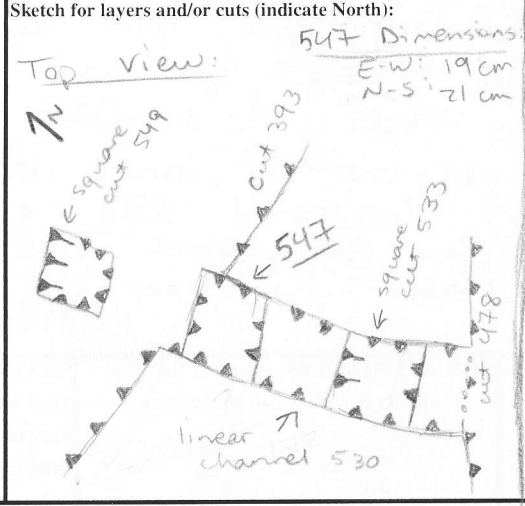

mm mm

**For structural remains complete this section**

Alignment:

Building Technique:  Adobe/Mud-brick  Ashlar (blocks)  irregular (unworked) stone  Concrete  Other (specify)

Binding Agent:  None  Clay  Mortar (if so, specify composition, color, compaction)

Concrete inclusions:

Material  Tufo  Basalt  Travertine  Tiles  Other (specify)  
 Size  Small (range) \_\_\_\_\_  Medium (range) \_\_\_\_\_  Large (range) \_\_\_\_\_ Representative size: e.g. 2 x 1 x 2 cmz

Wall Facing:

Opus quadratum  Opus incertum  Opus reticulatum  Petit appareil  Opus testaceum  Opus mixtum  Opus vittatum  Other (specify)

Complete this section for foundations  Faced foundation  Wooden shuttering  No shuttering

floor/revetment type

Floor type:  Beaten Earth  Opus signinum  Opus scutulatum  Opus Sectile  Mosaic  Opus spicatum  Other (specify)

Wall finishing  Stucco  Opus signinum  Plaster  Painted Plaster  Other (specify)

Approx. length, width, height of structural remains:

Description:

Sketch (if applicable, indicate North)

**INTERPRETATION**

Square cut (posthole?) in the bedrock cutting a linear N-S channel (530) also cut into the bedrock. The E and W sides of cut 547 are aligned with the sides of 530. This cut is also aligned with two other square cuts of similar dimensions (533 to the S and 549 to the N), one of which (533) also cuts the linear channel 530 and the other of which (549) is in the same line. All four cuts must be related, but their function is uncertain.

**SOIL SAMPLING:**  Yes  No

Total volume of layer (buckets):

Sample quantity (buckets):

Sample fraction (%):

**NON SOIL SAMPLES:**  Yes  No

If yes, specify (e.g. charcoal, mortar etc.):

Size:

**SIEVING:**  Yes  No

Total volume of layer (buckets):

Sample quantity (buckets):

Sample fraction (%):

**STRATIGRAPHICAL RELIABILITY**

Good  Fair  Poor

Filled-out by *E. Adkins*

on *2 Aug. 2010*

Revised by *J. Sewell*

on *2.8.2010*

PDFd by

on

Entered by

on