

For structural remains complete this section

Alignment:

Building Technique: Adobe/Mud-brick Ashlar (blocks) irregular (unworked) stone Concrete Other (specify)

Binding Agent: None Clay Mortar (if so, specify composition, color, compaction)

Concrete inclusions: None

Material: Tufo Basalt Travertine Tiles Other (specify)

Size: Small (range) _____ Medium (range) _____ Large (range) _____ Representative size: e.g. 2 x 1 x 2 cmz

Wall Facing: None

Opus quadratum Opus incertum Opus reticulatum Petit appareil Opus testaceum Opus mixtum Opus vittatum Other (specify)

Complete this section for foundations: Faced foundation Wooden shuttering No shuttering

floor/revetment type

Floor type: Beaten Earth Opus signinum Opus scutulatum Opus Sectile Mosaic Opus spicatum Other (specify) Slab

Wall finishing: Stucco Opus signinum Plaster Painted Plaster Other (specify)

Approx. length, width, height of structural remains:

1m31cm x 50cm x 4cm

Description:

TUFO SLABS UNDER 5318, SEEM TO BE A CONTINUATION OF 5321 (+5485) ON WHICH 5318 WAS LATER CONSTRUCTED.

Sketch (if applicable, indicate North)

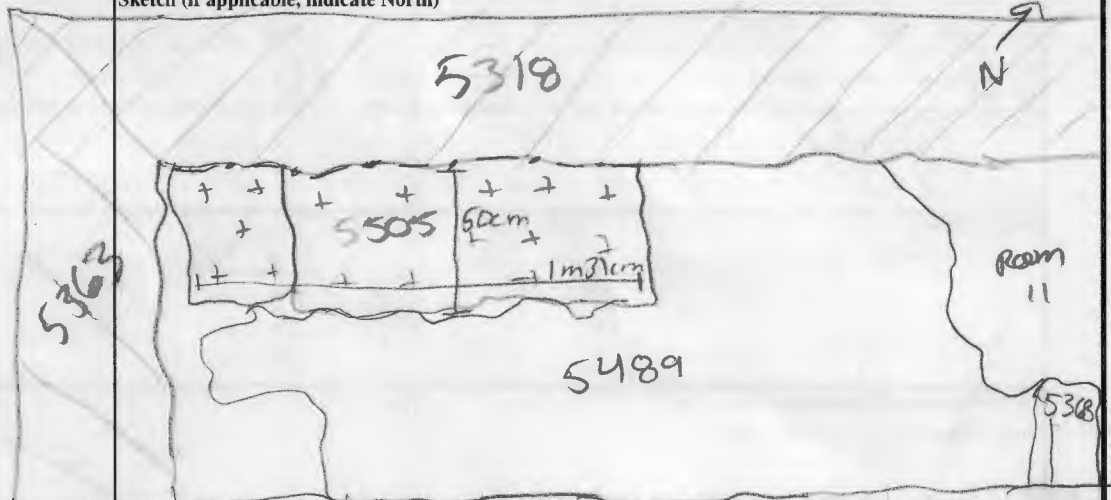

INTERPRETATION

Exposed during previous Soprintendenza excavations, SU 5505 are tufo slabs that are the continuation ^{into Room II} of tufo pavement 5321 (also 5485 in Room I) on which 5318 was later constructed and against which (+ maybe on top of?) a floor associated w/ tufo prep 5489 may have been constructed. They paved a large, presumably open, area associated with the ramp from the lower to the second terrace.

SOIL SAMPLING: Yes No

Total volume of layer (buckets):

Sample quantity (buckets):

Sample fraction (%):

NON SOIL SAMPLES: Yes No

If yes, specify (e.g. charcoal, mortar etc.):

Sample quantity (buckets):

Sample fraction (%):

Size:

SIEVING: Yes No

Total volume of layer (buckets):

Sample quantity (buckets):

Sample fraction (%):

STRATIGRAPHICAL RELIABILITY

Good Fair Poor

Filled-out by SLASH

Revised by JPARR

PDFd by JCN

Entered by

on 1.8.13

on 1.8.13

on 2/8/13

on