

SITE GPR	YEAR	AREA	SECTOR	ELEVATION	STRATIGRAPHICAL UNIT	<small>University of Michigan Laboratory of Archaeology</small> Gabii Project
	73	F	SWELL	Min: 59,8764 Max: 60,0783	5529 <input type="checkbox"/> Natural <input checked="" type="checkbox"/> Anthropic	
In cross-section? <input type="checkbox"/> Yes <input checked="" type="checkbox"/> No		In elevation drawing? <input type="checkbox"/> Yes <input checked="" type="checkbox"/> No		Photos: <input checked="" type="checkbox"/> Yes <input type="checkbox"/> No #: 3077	Photo Model: <input checked="" type="checkbox"/> Yes <input type="checkbox"/> No #: 504	
DEFINITION Tufo Slabs with circular cut in Room 11				Covered by <input checked="" type="checkbox"/> SU: 5363	Fills <input type="checkbox"/> SU:	Filled by <input type="checkbox"/> SU:
HOW IS LAYER DISTINGUISHED? <input type="checkbox"/> Color <input type="checkbox"/> Composition <input type="checkbox"/> Compaction			FORMATION PROCESS <input type="checkbox"/> Accumulation <input checked="" type="checkbox"/> Construction <input type="checkbox"/> Cutting <input type="checkbox"/> Erosion <input type="checkbox"/> Collapse <input type="checkbox"/> Intentional deposition			
INCLUSIONS For each inclusion specify frequency: (f)requent, (m)edium, (r)are					SOIL/MATRIX	
Anthropic		Geological		Organic		clay ___% silt ___% sand ___%
<input type="checkbox"/> Pottery <input type="checkbox"/> Nails <input type="checkbox"/> Tiles <input type="checkbox"/> Marble <input type="checkbox"/> Amphorae <input type="checkbox"/> Quarried debris <input type="checkbox"/> Dolia <input type="checkbox"/> Slag <input type="checkbox"/> Brick <input type="checkbox"/> Mosaic tile(s) <input type="checkbox"/> Basalt slabs <input type="checkbox"/> Mortar <input type="checkbox"/> Opus signinum <input type="checkbox"/> Coins <input type="checkbox"/> Painted plaster <input type="checkbox"/> Metal (specify) <input type="checkbox"/> Burnt Adobe <input type="checkbox"/> Collapse debris <input type="checkbox"/> Other (specify) <input type="checkbox"/> Glass		<input type="checkbox"/> Tufo (specify) <input type="checkbox"/> Travertine <input type="checkbox"/> Other Limestone <input type="checkbox"/> Basalt <input type="checkbox"/> Clay <input type="checkbox"/> Sand <input type="checkbox"/> Silt <input type="checkbox"/> Pebbles (range) <input type="checkbox"/> Gravel (range)		<input type="checkbox"/> Charcoal <input type="checkbox"/> Ash <input type="checkbox"/> Animal bones <input type="checkbox"/> Human bones <input type="checkbox"/> Animal teeth <input type="checkbox"/> Human teeth <input type="checkbox"/> Shells <input type="checkbox"/> Other (specify)		<input type="checkbox"/> Granular <input type="checkbox"/> Layered <input type="checkbox"/> Cohesive Compaction: <input type="checkbox"/> Hard <input type="checkbox"/> Compact <input type="checkbox"/> Friable <input type="checkbox"/> Loose <input type="checkbox"/> Soft Color: <input type="checkbox"/> Black <input type="checkbox"/> Brown <input type="checkbox"/> Gray <input type="checkbox"/> Light Brown <input type="checkbox"/> Light Gray <input type="checkbox"/> White <input type="checkbox"/> Yellow <input type="checkbox"/> Red <input type="checkbox"/> Light Yellow <input type="checkbox"/> Other (specify)

UNIT LIMITS (also indicate on overlay)

Northern Limit: Original Not Original Excavation Limit

Southern Limit: Original Not Original Excavation Limit

Western Limit: Original Not Original Excavation Limit

Eastern Limit: Original Not Original Excavation Limit

Depth: Original Not Original

STRATIGRAPHICAL SEQUENCE

Is equal to:	Is bound to (only for masonry):
Is abutted by:	Abuts:
Is covered by: 5366	Covers: 5536
Is cut by:	Cuts:
Is filled by:	Fills:

OBSERVATIONS

DESCRIPTION

Position within sector: SWTH CORNER F-SECT; ROOM 11 (2010-1980 ROOM?)

Shape: RECTANGULAR

For layers complete this section:

Surface (slope direction; visible inclusions):

Observations about inclusions (Clusters? Deposition slope):

Observations about thickness (Increases? Decreases?):

Nature of the interface with layer below: sharp diffuse commigled other (specify)

For cuts complete this section:

Cut edges: rounded straight

Cut sides: straight concave convex sloping

Cut bottom: flat concave irregular

How is cut top edge? sharp rounded

How is cut bottom edge? sharp rounded

Observations:

Sketch for layers and/or cuts (indicate North):

A OTHER BLOCK OF SU NOT VISIBLE IN PLAN B/C UNDER 5363

For structural remains complete this section

Alignment: E-W

Building Technique: Adobe/Mud-brick Ashlar (blocks) irregular (unworked) stone Concrete Other (specify)

Binding Agent: None Clay Mortar (if so, specify composition, color, compaction)

Concrete inclusions: NONE

Material Tufo Basalt Travertine Tiles Other (specify)

Size Small (range) _____ Medium (range) _____ Large (range) _____ Representative size: e.g. 2 x 1 x 2 cmz

Wall Facing: None

Opus quadratum Opus incertum Opus reticulatum Petit appareil Opus testaceum Opus mixtum Opus vittatum Other (specify)

Complete this section for foundations Faced foundation Wooden shuttering No shuttering

floor/revetment type None

Floor type: Beaten Earth Opus signinum Opus scutulatum Opus Sectile Mosaic Opus spicatum Other (specify)

Wall finishing Stucco Opus signinum Plaster Painted Plaster Other (specify)

Approx. length, width, height of structural remains:

Blocks East to West: 70 x 20 cm; 92 x 57 x 19 cm; 44 x UNKNOWN x 24 cm

Description:

THREE TUFO BLOCKS, THE EASTERN OF WHICH HAS A SEMI-CIRCULAR CUT OF THE EASTERN SIDE, SITTING ON CONCRETE BELOW + TO THE EAST OF 5363.

Sketch (if applicable, indicate North)

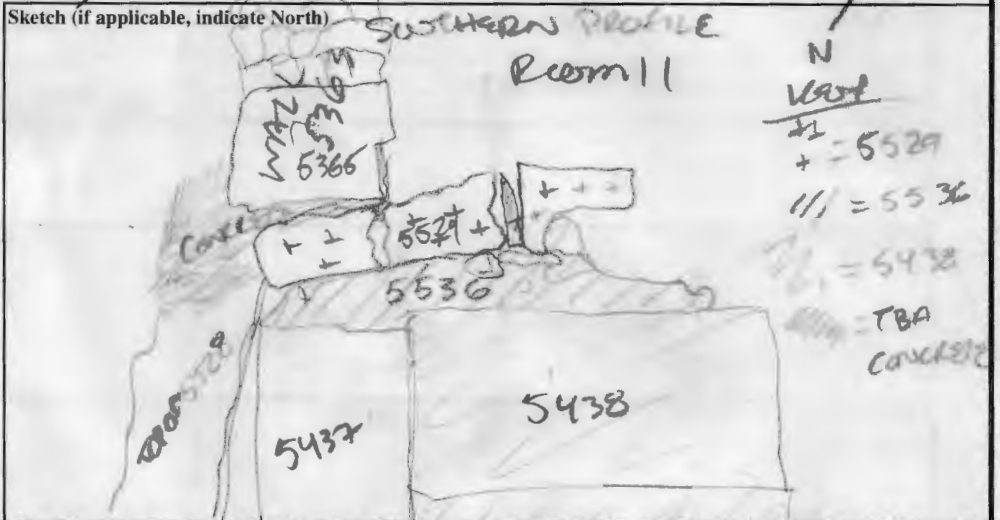

INTERPRETATION

THREE TUFO BLOCKS (EASTERN END OF THE TWO GREAT) EXPOSED BY SOBBING EXCAVATIONS - THE EASTERN OF WHICH HAS A SEMI-CIRCULAR CUT. THESE BLOCKS SIT atop CONCRETE 5536 WHICH IN TURN APPEARS EARLY END TUFO WALL 5437 AND LARGE ASHLAR 5438. SO 5529 IS COVERED BY ANOTHER LAYER OF CONCRETE WHICH EXTENDS UNDER WALL 5363 AND TO THE WEST. THESE BLOCKS SEEM TO REPRESENT A SOUTHERN LIMIT OF ROOM 11 LATER + BEING A PREVIOUS WALLS + BLOCKS 5437 + 5438 BUT EARLIER OR POSSIBLY JUST AN EARLY STAGE OF CONSTRUCTION ASSOCIATED WITH WALL 5363. The purpose of the circular cut remains unknown.

SOIL SAMPLING: Yes No

Total volume of layer (buckets):

Sample quantity (buckets):

Sample fraction (%):

NON SOIL SAMPLES: Yes No

If yes, specify (e.g. charcoal, mortar etc.):

Size:

SIEVING: Yes No

Total volume of layer (buckets):

Sample quantity (buckets):

Sample fraction (%):

STRATIGRAPHICAL RELIABILITY

Good Fair Poor

Filled-out by SLASH

Revised by J. FARR

PDFd by JCN

Entered by

on 30.7.13

on 31.7.13

on 1/8/13

on

