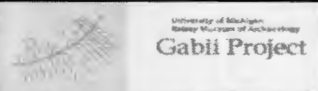

SITE GPR	YEAR 19	AREA F-South	SECTOR	ELEVATION Min: 58.9315 Max: 59.1793	STRATIGRAPHICAL UNIT 5535 <input type="checkbox"/> Natural <input type="checkbox"/> Anthropic	
	In cross-section? <input type="checkbox"/> Yes <input checked="" type="checkbox"/> No		In elevation drawing? <input type="checkbox"/> Yes <input checked="" type="checkbox"/> No		Photos: <input checked="" type="checkbox"/> Yes <input type="checkbox"/> No #: 3118-19	
DEFINITION Wall of drainage canal			Covered by <input checked="" type="checkbox"/> SU: 0		Fills <input type="checkbox"/> SU:	Filled by <input type="checkbox"/> SU:
HOW IS LAYER DISTINGUISHED? <input type="checkbox"/> Color <input type="checkbox"/> Composition <input type="checkbox"/> Compaction			FORMATION PROCESS <input type="checkbox"/> Accumulation <input checked="" type="checkbox"/> Construction <input type="checkbox"/> Cutting <input type="checkbox"/> Erosion <input type="checkbox"/> Collapse <input type="checkbox"/> Intentional deposition			
INCLUSIONS For each inclusion specify frequency: (f)requent, (m)edium, (r)are					SOIL/MATRIX	
Anthropic		Geological		Organic		clay ___% silt ___% sand ___%
<input type="checkbox"/> Pottery <input type="checkbox"/> Nails <input type="checkbox"/> Tiles <input type="checkbox"/> Marble <input type="checkbox"/> Amphorae <input type="checkbox"/> Quarried debris <input type="checkbox"/> Dolia <input type="checkbox"/> Slag <input type="checkbox"/> Brick <input type="checkbox"/> Mosaic tile(s) <input type="checkbox"/> Basalt slabs <input type="checkbox"/> Mortar <input type="checkbox"/> Opus signinum <input type="checkbox"/> Coins <input type="checkbox"/> Painted plaster <input type="checkbox"/> Metal (specify) <input type="checkbox"/> Burnt Adobe <input type="checkbox"/> Collapse debris <input type="checkbox"/> Other (specify) <input type="checkbox"/> Glass		<input type="checkbox"/> Tufo (specify) <input type="checkbox"/> Travertine <input type="checkbox"/> Other Limestone <input type="checkbox"/> Basalt <input type="checkbox"/> Clay <input type="checkbox"/> Sand <input type="checkbox"/> Silt <input type="checkbox"/> Pebbles (range) <input type="checkbox"/> Gravel (range)		<input type="checkbox"/> Charcoal <input type="checkbox"/> Ash <input type="checkbox"/> Animal bones <input type="checkbox"/> Human bones <input type="checkbox"/> Animal teeth <input type="checkbox"/> Human teeth <input type="checkbox"/> Shells <input type="checkbox"/> Other (specify)		<input type="checkbox"/> Granular <input type="checkbox"/> Layered <input type="checkbox"/> Cohesive Compaction <input type="checkbox"/> Hard <input type="checkbox"/> Black <input type="checkbox"/> Brown <input type="checkbox"/> Compact <input type="checkbox"/> Gray <input type="checkbox"/> Light Brown <input type="checkbox"/> Friable <input type="checkbox"/> Light Gray <input type="checkbox"/> White <input type="checkbox"/> Loose <input type="checkbox"/> Yellow <input type="checkbox"/> Red <input type="checkbox"/> Soft <input type="checkbox"/> Light Yellow <input type="checkbox"/> Other (specify)
UNIT LIMITS (also indicate on overlay)						Depth: <input checked="" type="checkbox"/> Original <input type="checkbox"/> Not Original
Northern Limit <input checked="" type="checkbox"/> Original <input type="checkbox"/> Not Original <input type="checkbox"/> Excavation Limit						
Southern Limit <input checked="" type="checkbox"/> Original <input type="checkbox"/> Not Original <input type="checkbox"/> Excavation Limit						
Western Limit <input checked="" type="checkbox"/> Original <input type="checkbox"/> Not Original <input type="checkbox"/> Excavation Limit						
Eastern Limit <input checked="" type="checkbox"/> Original <input type="checkbox"/> Not Original <input type="checkbox"/> Excavation Limit						
STRATIGRAPHICAL SEQUENCE						
Is equal to:			Is bound to (only for masonry):			
Is abutted by:			Abuts: 5417, 5434			
Is covered by: 0			Covers: 5133			
Is cut by:			Cuts:			
Is filled by:			Fills:			
OBSERVATIONS Originally excavated by Soprintendenza, re-exposed by Gabii Project 2013.						
DESCRIPTION Position within sector: SE area F-South Shape: Irregular						
For layers complete this section: Surface (slope direction; visible inclusions): Observations about inclusions (Clusters? Deposition slope): Observations about thickness (Increases? Decreases?): Nature of the interface with layer below: <input type="checkbox"/> sharp <input type="checkbox"/> diffuse <input type="checkbox"/> commigled <input type="checkbox"/> other (specify)						
For cuts complete this section: Cut edges: <input type="checkbox"/> rounded <input type="checkbox"/> straight Cut sides: <input type="checkbox"/> straight <input type="checkbox"/> concave <input type="checkbox"/> convex <input type="checkbox"/> sloping Cut bottom: <input type="checkbox"/> flat <input type="checkbox"/> concave <input type="checkbox"/> irregular How is cut top edge? <input type="checkbox"/> sharp <input type="checkbox"/> rounded How is cut bottom edge? <input type="checkbox"/> sharp <input type="checkbox"/> rounded Observations:			Sketch for layers and/or cuts (indicate North):			

For structural remains complete this section

Alignment: *Irregular*

Building Technique: Adobe/Mud-brick Ashlar (blocks) Irregular (unworked) stone Concrete Other (specify)

Binding Agent: None Clay Mortar (if so, specify composition, color, compaction)
Pink

Concrete inclusions:

Material Tufo Basalt Travertine Tiles Other (specify)

Size Small (range) _____ Medium (range) _____ Large (range) _____ Representative size: e.g. 2 x 1 x 2 cmz

Wall Facing:

Opus quadratum Opus incertum Opus reticulatum Petit appareil Opus testaceum Opus mixtum Opus vittatum Other (specify)

Complete this section for foundations Faced foundation Wooden shuttering No shuttering

floor/revetment type

Floor type: Beaten Earth Opus signinum Opus scutulatum Opus Sectile Mosaic Opus spicatum Other (specify)

Wall finishing Stucco Opus signinum Plaster Painted Plaster Other (specify)

Approx. length, width, height of structural remains:

Description: *Mortared Rubble wall with pieces of tufo, basalt, travertine & tile. Sits directly on bedrock. Feature forms three sides of a channel which then cuts through ashlar wall 5417 to the east. Gap in northern wall where it meets 5417.*

Sketch (if applicable, indicate North)

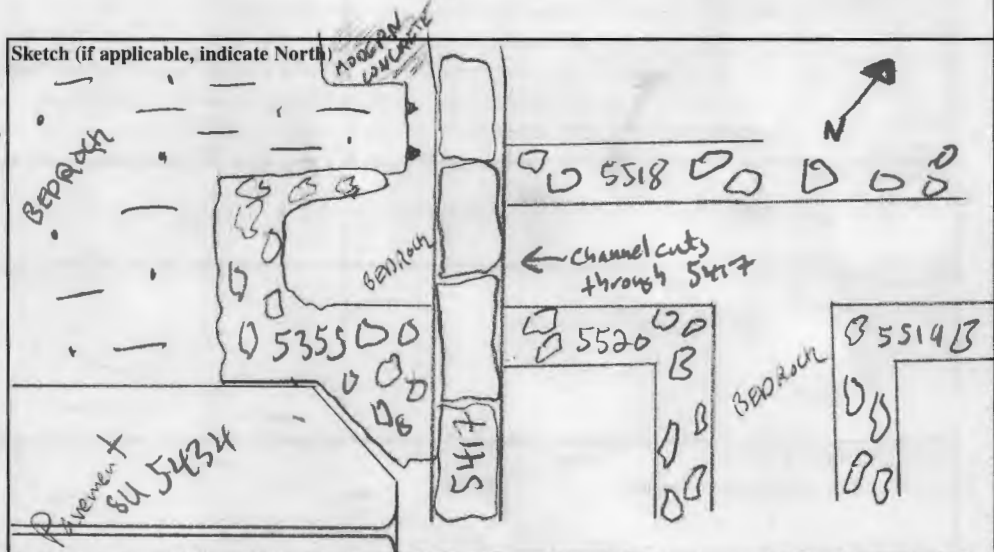

INTERPRETATION

SU 5355 is the wall of a drainage channel formed also by 5518, 5519, 5520 on the other, eastern, side of 5417. The channel cuts through this ashlar wall, which must have been out of use when it was constructed. The gap in the north leads to a square cut in the bedrock, now filled with modern concrete, possibly also associated with water movement. This then joins the cut (SU 5418) for 5417 - if water drained through here, 5417 must certainly have been out of use.

SOIL SAMPLING: Yes No

Total volume of layer (buckets):

Sample quantity (buckets):

Sample fraction (%):

NON SOIL SAMPLES: Yes No

If yes, specify (e.g. charcoal, mortar etc.):

Size:

SIEVING: Yes No

Total volume of layer (buckets):

Sample quantity (buckets):

Sample fraction (%):

STRATIGRAPHICAL RELIABILITY

Good Fair Poor

Filled-out by *S.FARR*

on *31.7.13*

Revised by *S.FARR*

on *31.7.13*

PDFd by *JCN*

on *2/8/13*

Entered by

on