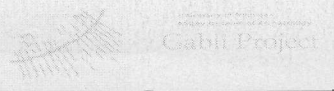

SITE GPR	YEAR 11	AREA C	SECTOR	ELEVATION Min: 60.877 Max: 61.402	STRATIGRAPHICAL UNIT 2304 <input type="checkbox"/> Natural <input checked="" type="checkbox"/> Anthropic	
-------------	------------	-----------	--------	---	--	--

In cross-section? Yes No In elevation drawing? Yes No Photos: Yes No #: 2304-05, 2304-06, 2304-07 Photo Model: Yes No #:

DEFINITION
cut filled by 2303, into surfaces 2202, 2213

Covered by SU: SU: SU: 2303

HOW IS LAYER DISTINGUISHED?
 Color Composition Compaction

FORMATION PROCESS
 Accumulation Construction Cutting Erosion Collapse Intentional deposition

INCLUSIONS For each inclusion specify frequency: (f)requent, (m)edium, (r)are

Anthropic	Geological	Organic	SOIL/MATRIX
<input type="checkbox"/> Pottery <input type="checkbox"/> Tiles <input type="checkbox"/> Amphorae <input type="checkbox"/> Dolia <input type="checkbox"/> Mosaic tile(s) <input type="checkbox"/> Mortar <input type="checkbox"/> Coins <input type="checkbox"/> Metal (specify) <input type="checkbox"/> Collapse debris <input type="checkbox"/> Glass	<input type="checkbox"/> Nails <input type="checkbox"/> Marble <input type="checkbox"/> Quarried debris <input type="checkbox"/> Slag <input type="checkbox"/> Brick <input type="checkbox"/> Basalt slabs <input type="checkbox"/> Opus signinum <input type="checkbox"/> Painted plaster <input type="checkbox"/> Burnt Adobe <input type="checkbox"/> Other (specify)	<input type="checkbox"/> Tufo (specify) <input type="checkbox"/> Travertine <input type="checkbox"/> Other Limestone <input type="checkbox"/> Basalt <input type="checkbox"/> Clay <input type="checkbox"/> Sand <input type="checkbox"/> Silt <input type="checkbox"/> Pebbles (range) <input type="checkbox"/> Gravel (range)	clay ___% silt ___% sand ___% <input type="checkbox"/> Granular <input type="checkbox"/> Layered <input type="checkbox"/> Cohesive Compaction <input type="checkbox"/> Hard <input type="checkbox"/> Compact <input type="checkbox"/> Friable <input type="checkbox"/> Loose <input type="checkbox"/> Soft Color <input type="checkbox"/> Black <input type="checkbox"/> Brown <input type="checkbox"/> Gray <input type="checkbox"/> Light Gray <input type="checkbox"/> White <input type="checkbox"/> Yellow <input type="checkbox"/> Red <input type="checkbox"/> Light Yellow <input type="checkbox"/> Other (specify)

UNIT LIMITS (also indicate on overlay)

Northern Limit Original Not Original Excavation Limit Depth: Original Not Original

Southern Limit Original Not Original Excavation Limit

Western Limit Original Not Original Excavation Limit

Eastern Limit Original Not Original Excavation Limit

STRATIGRAPHICAL SEQUENCE

Is equal to: 2211 Is bound to (only for masonry):

Is abutted by: Abuts:

Is covered by: Covers:

Is cut by: 2206 Cuts: 2213, 2202, 2246

Is filled by: 2303 Fills:

OBSERVATIONS * new 2307 SV sheet old SU # 2212 assigned in 2010 season, cancelled

original height of channel is unknown

DESCRIPTION

Position within sector: N → S channel

Shape: linear

For layers complete this section:

Surface (slope direction: visible inclusions):

Observations about inclusions (Clusters? Deposition slope):

Observations about thickness (Increases? Decreases?):

Nature of the interface with layer below: sharp diffuse commingled other (specify)

For cuts complete this section:

Cut edges: rounded straight

Cut sides: straight concave convex sloping

Cut bottom: flat concave irregular

How is cut top edge? sharp rounded

How is cut bottom edge? sharp rounded

Observations:
cut extends north of drainage channel (2206) as 2211 (unexcavated)

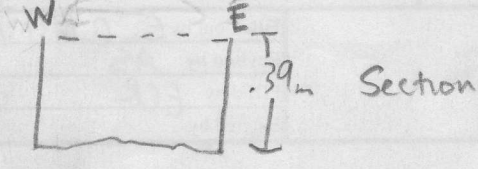
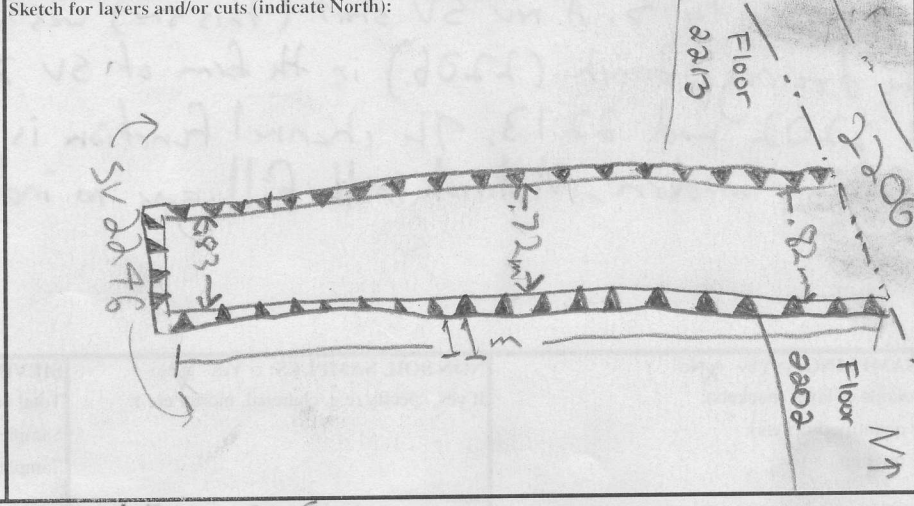

For structural remains complete this section

Alignment:

Building Technique: Adobe/Mud-brick Ashlar (blocks) irregular (unworked) stone Concrete Other (specify)

Binding Agent: None Clay Mortar (if so, specify composition, color, compaction)

Concrete inclusions:

Material Tufo Basalt Travertine Tiles Other (specify)

Size Small (range) _____ Medium (range) _____ Large (range) _____ Representative size: e.g. 2 x 1 x 2 cmz

Wall Facing:

Opus quadratum Opus incertum Opus reticulatum Petit appareil Opus testaceum Opus mixtum Opus vittatum Other (specify)

Complete this section for foundations Faced foundation Wooden shuttering No shuttering

floor/revetment type

Floor type: Beaten Earth Opus signinum Opus scutulatum Opus Sectile Mosaic Opus spicatum Other (specify)

Wall finishing Stucco Opus signinum Plaster Painted Plaster Other (specify)

Approx. length, width, height of structural remains:

Description:

Sketch (if applicable, indicate North)

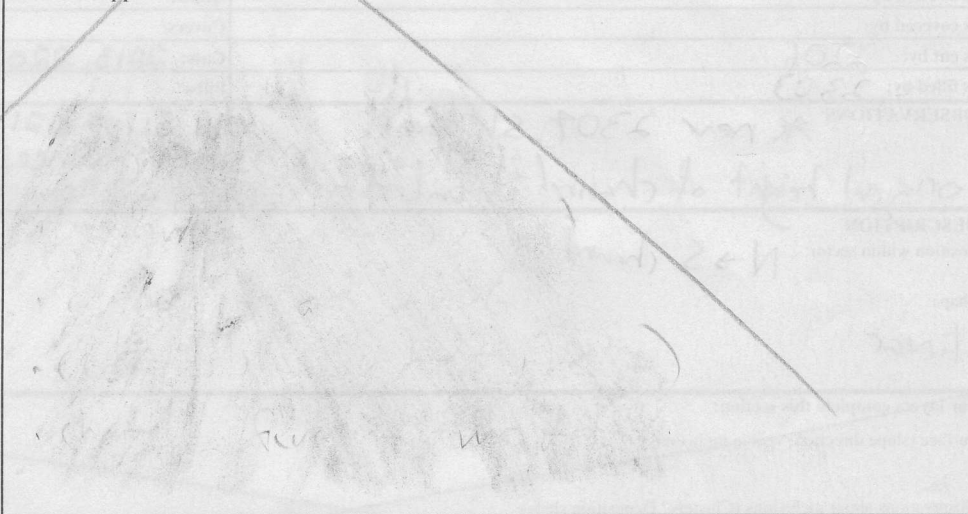

INTERPRETATION

This SU was originally excavated partially. The fill was identified due to its dark color after cleaning the surface and it was realized that the cut extend ca 10 more meters to the S. A new SU strat (this one) was started. This SU spans the drainage trench (2206) in the form of SU 2211. It also cuts the floors of 2202 and 2213. The channel function is still unknown but it is possibly modern. Material in the fill gave no indication of the cut function.

SOIL SAMPLING: Yes No

Total volume of layer (buckets):

Sample quantity (buckets):

Sample fraction (%):

NON SOIL SAMPLES: Yes No

If yes, specify (e.g. charcoal, mortar etc.):

Size:

SIEVING: Yes No

Total volume of layer (buckets):

Sample quantity (buckets):

Sample fraction (%):

STRATIGRAPHICAL RELIABILITY

Good Fair Poor

Filled-out by *E. Goldstick*

on *21-7-11*

Revised by *AS*

on *25-7-11*

PDFd by *ECR*

on *27-7-11*

Entered by

on